

SL402MX

2 PIN

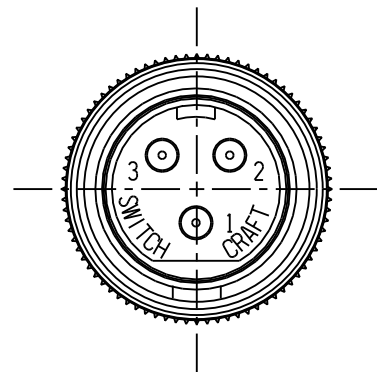

SL403MX

3 PIN

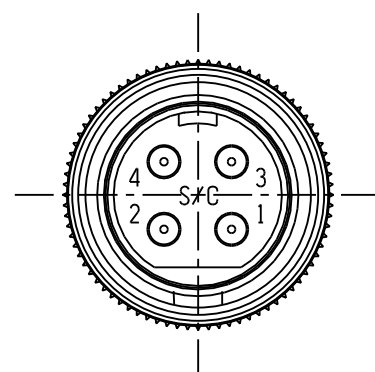

SL404MX

4 PIN

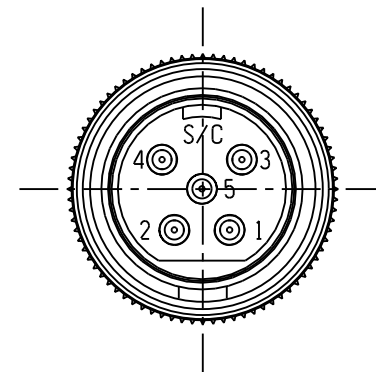

SL405MX

5 PIN

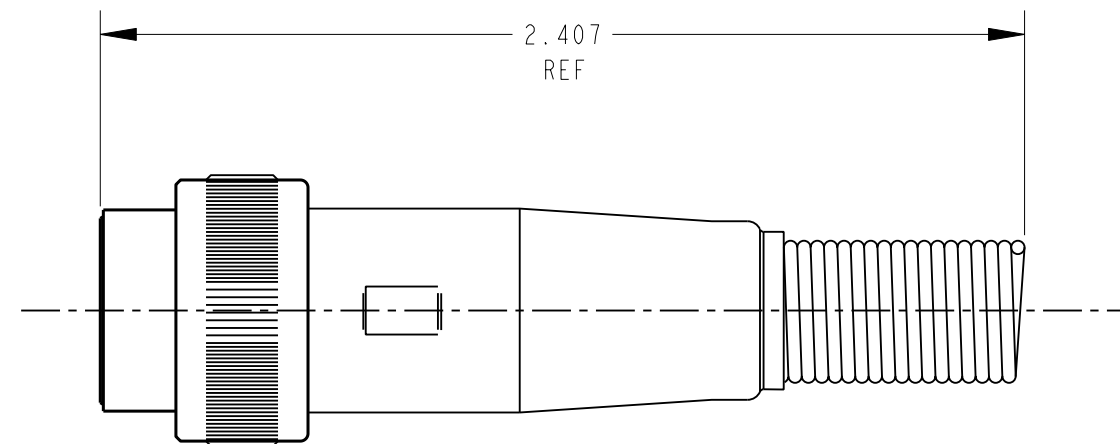
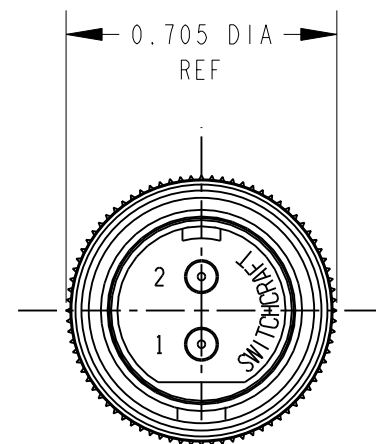
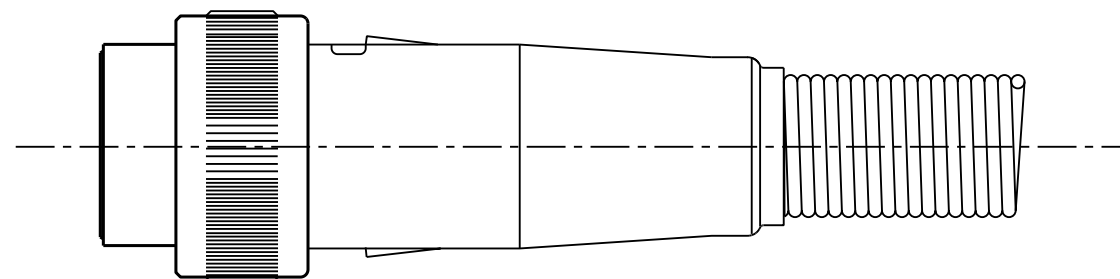

CUSTOMER DRAWING

NOTES:

- MATERIALS:
HOUSING - COPPER ALLOY, NICKEL PLATED
INSERT - GLASS REINFORCED THERMOPLASTIC
CONTACTS - COPPER ALLOY SILVER PLATED
CABLE CLAMP - STEEL, TIN PLATED
STRAIN RELIEF - STEEL, NICKEL PLATED
LATCH - STEEL, NICKEL PLATED
- THESE PRODUCTS ARE RoHS COMPLIANT.

					<div>★ STAR SYMBOL DENOTES CRITICAL DIMENSION</div>	THIS DRAWING DESCRIBES A DESIGN CONSIDERED PROPRIETARY IN NATURE, DEVELOPED AND MANUFACTURED BY SWITCHCRAFT INC. AND IS RELEASED ON A CONFIDENTIAL BASIS FOR IDENTIFICATION PURPOSES ONLY.										
						UNLESS OTHERWISE SPECIFIED	SIZE		WIDTH		MULT		LBS/M		TEMPER	
					1. ALL DIMENSIONS IN INCHES -TWO PLACE DECIMALS ±0.01 -THREE PLACE DECIMALS ±0.005 -ANGLES ±° -ALL DIA. CONCENTRIC WITHIN 0.005 T.I.R.	FINISH				MATERIAL						
						SPEC No.				SPEC No.						
						FIRST USED ON				SCALE 2:1		<div>Switchcraft®</div>				
A	26152	9-18-06	JEB	TJK	DATE DRAWN	BY	CHKD	APVD								
					07-Jan-09	JEB	JEB 01-07-09	TJK 01-07-09	SHEET OF							
REV	ECO NUMBER	DATE	BY	APVD	3. REMOVE ALL BURRS	NAME				PART No.				REV		
REVISIONS						SLIM-LINE MALE CORD PLUG CONNECTOR, RoHS				SL402MX-SL405MX				A		
					DO NOT SCALE DRAWING											

Mouser Electronics

Authorized Distributor

Click to View Pricing, Inventory, Delivery & Lifecycle Information:

Switchcraft:

[SL404M](#) [SL402M](#) [SL405M](#)