

NOTES:

- 1. CONTACTS ARE ASSEMBLED INTO CONNECTOR.
- 2. PARTS ARE TO BE BAGGED AS A KIT.
- 3. ALL DIMENSIONS ARE FOR REFERENCE ONLY.

KIT PART NO.	CABLE OD.
W8882-10SG-522	.220-.250 [5.6-6.4mm]
W8882-10SG-528	.265-.285 [6.7-7.2mm]

NO. OF CONTACTS — GROMMET SIZES

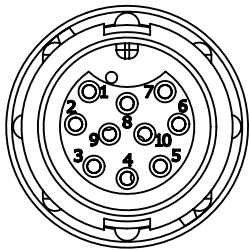

FACE VIEW

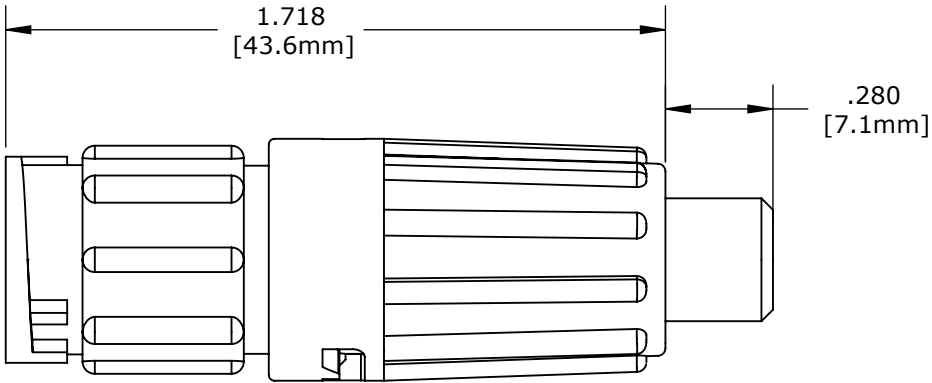

ASSEMBLED KIT VIEW  
W8882-10SG-522 SHOWN

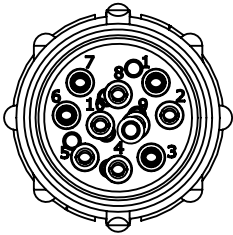

WIRE VIEW

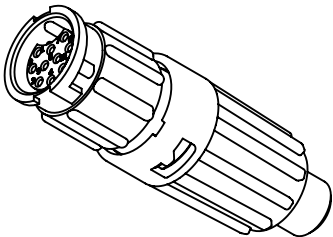
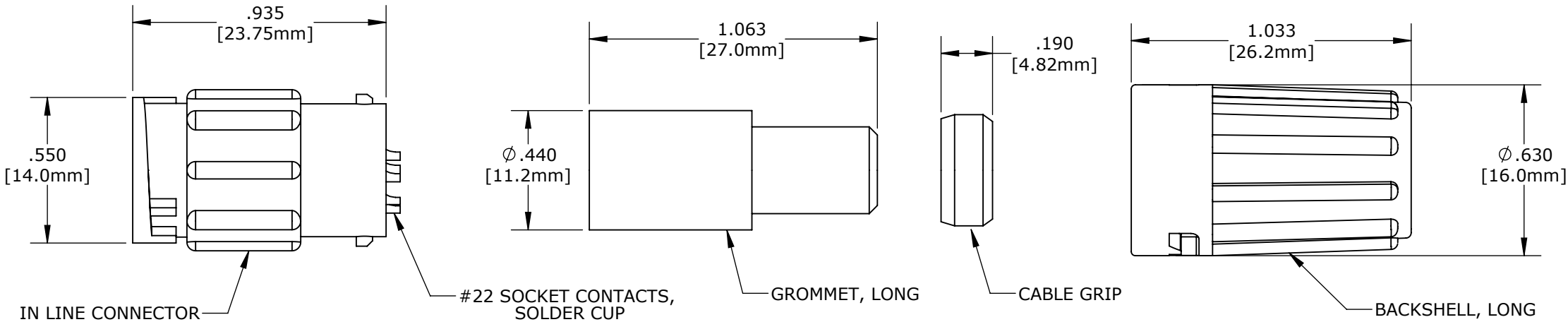

ASSEMBLED KIT  
FOR CUSTOMER REFERENCE

CUSTOMER APPROVAL	
THIS DOCUMENT CONTAINS CONFIDENTIAL INFORMATION PROPRIETARY TO CONXALL CORPORATION. ANY REPRODUCTION, DISCLOSURE, OR USE OF THIS DOCUMENT /INFORMATION IS EXPRESSLY PROHIBITED UNLESS AUTHORIZED IN WRITING BY CONXALL CORPORATION.	
APPROVED BY: _____	
DATE: _____	

0A				AM				04/05/16				FIRST DRAWN			
REV.		INIT.		DATE		DESCRIPTION									
AM				04/05/16		ORIG. DRAWN BY: DATE: AM 04/05/16									
						CHECKED BY:									
						APPROVED BY:									
						TITLE: IN-LINE CONNECTOR, KIT (10) #22 SOCKET CONTACT, SOLDER MINI-CON-X STANDARD PRODUCT									
						CUSTOMER: W8882-10SG-5XX									
						REV 0A									

# Mouser Electronics

Authorized Distributor

Click to View Pricing, Inventory, Delivery & Lifecycle Information:

[Switchcraft:](#)

[W8882-10SG-528](#)