

- NOTES:
1. PARTS TO BE BULK PACKED.
 2. ASSEMBLE CONTACTS INTO CONNECTOR AFTER CRIMPING ONTO WIRES.
 3. ALL DIMENSIONS ARE REFERENCE ONLY EXCEPT WHERE NOTED WITH TOLERANCE. DIMENSIONS IN BRACKETS [] ARE METRIC.

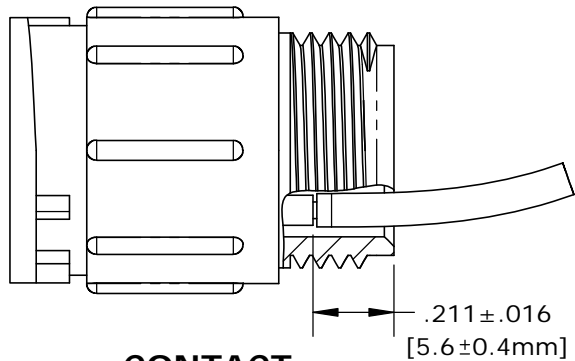

CONTACT
INSERTION VIEW

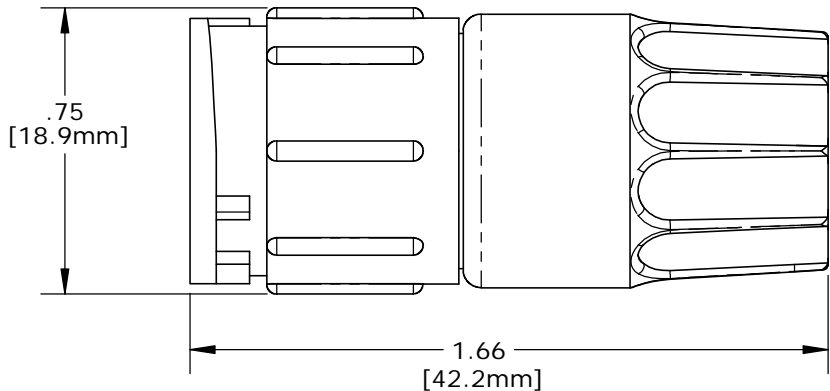

ASSEMBLED VIEW

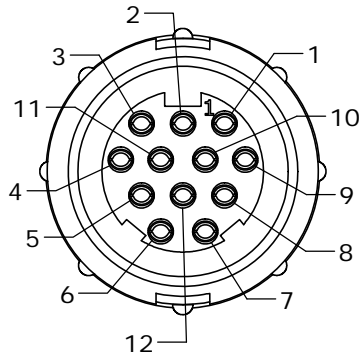

FACE VIEW
W5280-12SG-3XX

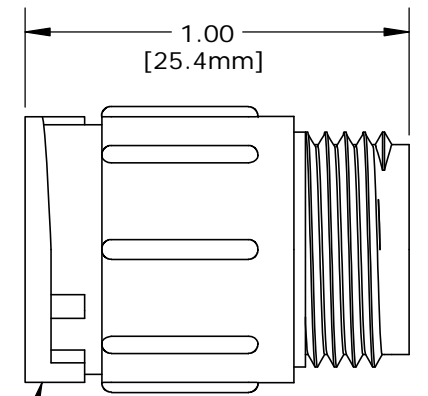

CABLE IN-LINE INSERT, FEMALE
MAT'L: UV THERMOPLASTIC,
BLACK

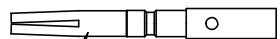

#20 SOCKET CONTACTS
CRIMP,
GOLD PLATED

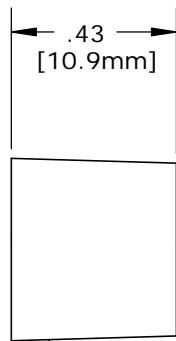

GROMMET,
MAT'L: RUBBER,
BLACK
FOR CABLE O.D.
SEE TABLE

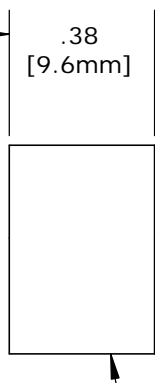

SLEEVE
MAT'L: THERMOPLASTIC,
BLACK

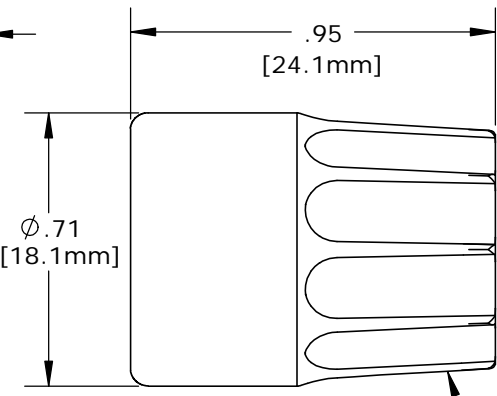

BACKSHELL
MAT'L: UV THERMOPLASTIC,
BLACK

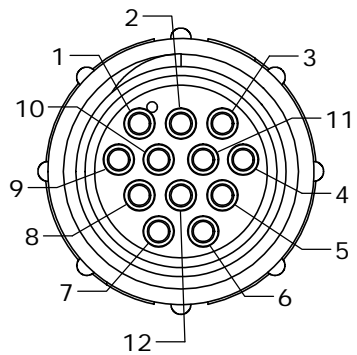

WIRE VIEW
12-position

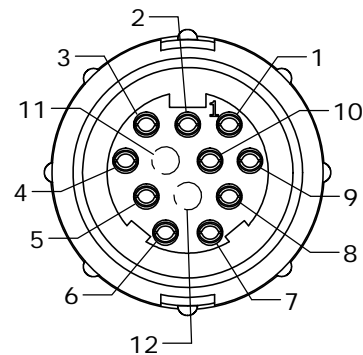

FACE VIEW
W5280-10SG-3XX

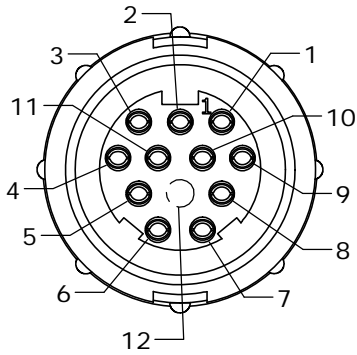

FACE VIEW
W5280-11SG-3XX

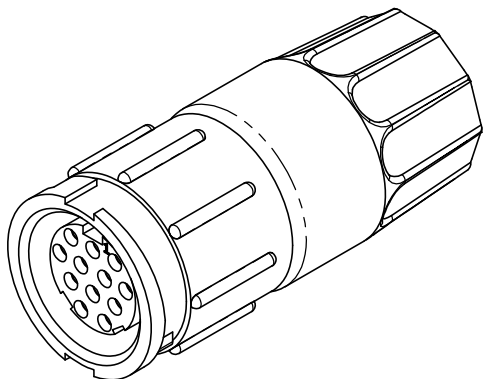

KIT PART NO.	GROMMET SIZE TO FIT CABLE O.D.
W5280-1XSG-324	0.24 - 0.27 [6.1-6.8mm]
W5280-1XSG-328	0.28 - 0.29 [7.1-7.4mm]
W5280-1XSG-330	0.30 - 0.32 [7.6-8.1mm]
W5280-1XSG-3DC	0.12-0.17-0.24 [3.0-4.3-6.1mm]

NO. OF CONTACTS

KIT P/N	NO. OF CONTACTS
W5280-10SG-3XX	(10) - #20
W5280-11SG-3XX	(11) - #20
W5280-12SG-3XX	(12) - #20
W5280-1XSG-3XX	

GROMMET SIZE
SEE P/N LIST

NO. OF CONTACTS

CUSTOMER APPROVAL

THIS DOCUMENT CONTAINS CONFIDENTIAL INFORMATION PROPRIETARY TO CONXALL CORPORATION. ANY REPRODUCTION, DISCLOSURE, OR USE OF THIS DOCUMENT /INFORMATION IS EXPRESSLY PROHIBITED UNLESS AUTHORIZED IN WRITING BY CONXALL CORPORATION.

APPROVED BY: _____

DATE: _____

A	PAK	08/20/19	DRAWING CREATED & RELEASED PER DOR 10-2523JS-1		
REV.	INIT.	DATE	DESCRIPTION		
	PAK	09/29/14	ORIG. DRAWN BY: DATE:	 601 E. WILDWOOD VILLA PARK, IL 60181	
			CHECKED BY:		
ALL INFORMATION ILLUSTRATED IS THE PROPERTY OF "CONXALL CORPORATION". UNAUTHORIZED DUPLICATION OR DISTRIBUTION OF THIS DOCUMENT IS PROHIBITED.			APPROVED BY:	TITLE: CABLE TO CABLE CONNECTOR KIT #20 SOCKET CONTACTS (CRIMP) MULTI-CON-X, E-KEY, WEATHER RESISTANT CUSTOMER: STANDARD PRODUCT	
ALL UNITS ARE IN FEET, INCHES, FRACTION OF INCHES AND DECIMALS.			SCALE: NTS	SIZE: B	SHEET: 1 OF 1
UNLESS OTHERWISE SPECIFIED TOLERANCES: 3 PLACE DECIMALS ±.005 ANGLES ±1° FRACTIONS ±1/16			FILE: W5280-1XSG-3XX	DIRECTORY: SLW	PART NUMBER: W5280-1XSG-3XX
△ = CRITICAL CHARACTERISTIC FLAG PER SPEC. XXXX					REV A

Mouser Electronics

Authorized Distributor

Click to View Pricing, Inventory, Delivery & Lifecycle Information:

Switchcraft:

<u>W5280-12SG-321</u>	<u>W5280-10SG-321</u>	<u>W5280-12SG-330</u>	<u>W5280-10SG-330</u>	<u>W5280-12SG-3DC</u>	<u>W5280-12SG-328</u>
<u>W5280-11SG-330</u>	<u>W5280-11SG-3DC</u>	<u>W5280-11SG-324</u>	<u>W5280-12SG-324</u>	<u>W5280-12SG-318</u>	<u>W5280-10SG-318</u>
<u>W5280-10SG-324</u>	<u>W5280-10SG-328</u>	<u>W5280-11SG-318</u>	<u>W5280-11SG-321</u>	<u>W5280-10SG-3DC</u>	<u>W5280-11SG-328</u>