

- NOTES:
1. PARTS TO BE BULK PACKED.
 2. ALL DIMENSIONS ARE REFERENCE ONLY EXCEPT WHERE NOTED WITH TOLERANCE. DIMENSIONS IN BRACKETS [] ARE METRIC.

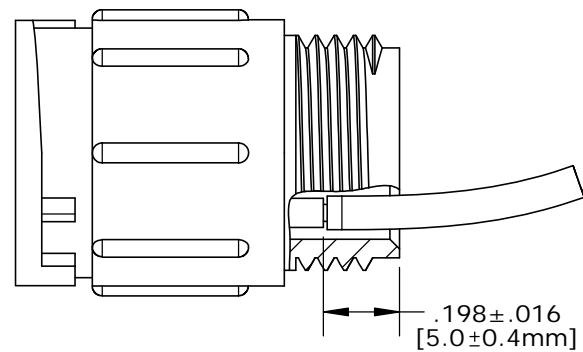

**CONTACT
INSERTION VIEW**

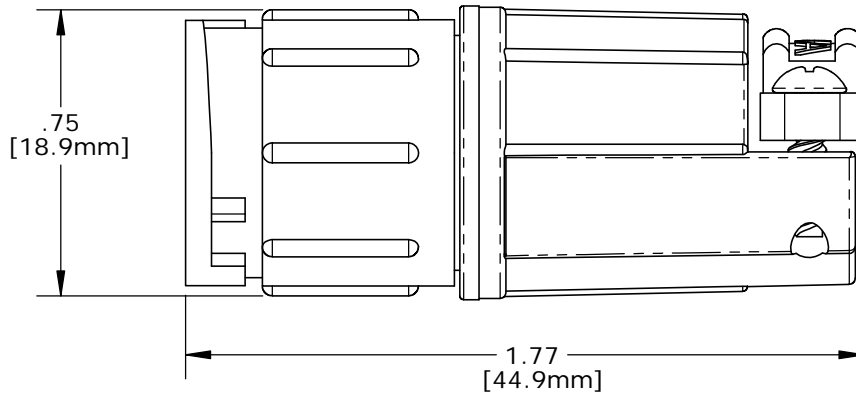

ASSEMBLED VIEW

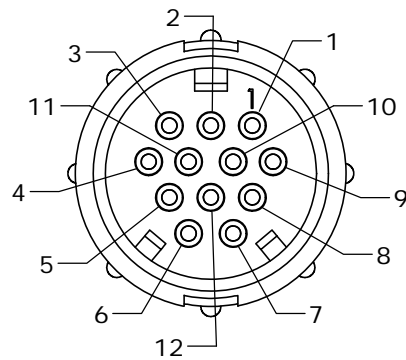

MATING FACE
W5280-12PG-5XX

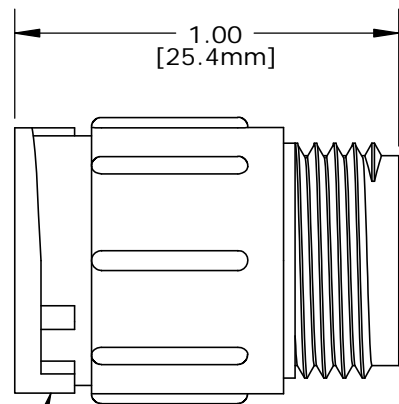

CABLE IN-LINE INSERT, MALE
MAT'L: UV THERMOPLASTIC,
BLACK



#20 PIN CONTACTS
CRIMP,
GOLD PLATED

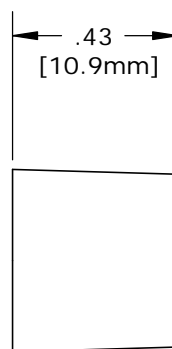

GROMMET,
MAT'L: RUBBER,
BLACK
FOR CABLE O.D.
SEE TABLE

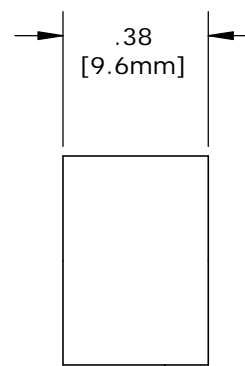

SLEEVE
MAT'L: THERMOPLASTIC,
BLACK

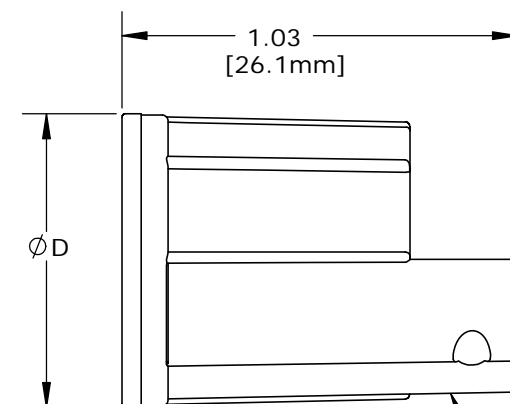

BACKSHELL
MAT'L: UV THERMOPLASTIC,
BLACK

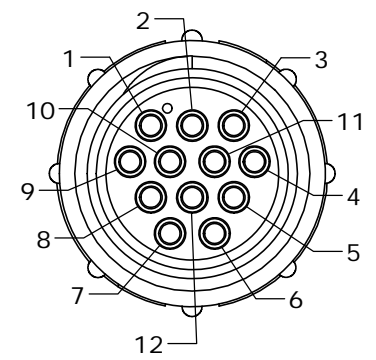

WIRE VIEW

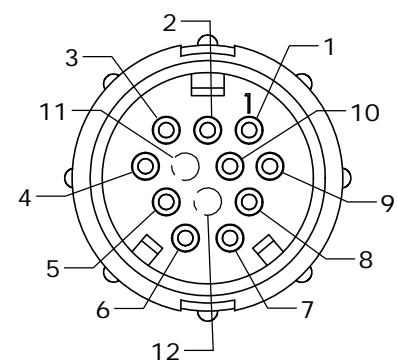

MATING FACE
W5280-10PG-5XX

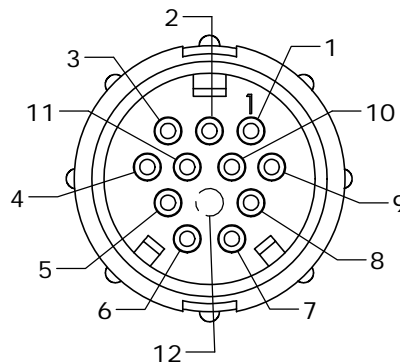

MATING FACE
W5280-11PG-5XX

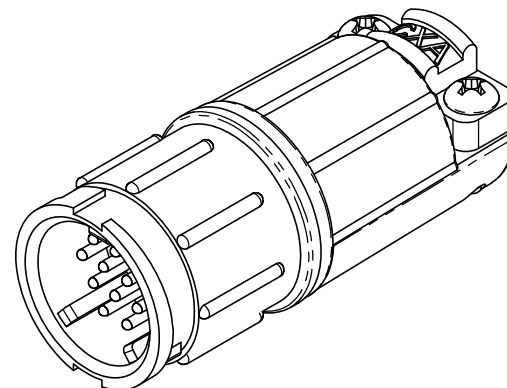

KIT PART NO.	GROMMET SIZE TO FIT CABLE O.D.	DIA. "D"	KIT P/N	NO. OF CONTACTS
W5280-1XPG-518	0.18 - 0.20 [4.6-5.1mm]	Ø0.77 [19.6mm]	W5280-10PG-5XX	(10) - #20
W5280-1XPG-521	0.21 - 0.23 [5.3-5.8mm]	Ø0.77 [19.6mm]	W5280-11PG-5XX	(11) - #20
W5280-1XPG-524	0.24 - 0.27 [6.1-6.8mm]	Ø0.77 [19.6mm]	W5280-12PG-5XX	(12) - #20
W5280-1XPG-528	0.28 - 0.29 [7.1-7.4mm]	Ø0.77 [19.6mm]	W5280-1XPG-5XX	
W5280-1XPG-530	0.30 - 0.32 [7.6-8.1mm]	Ø0.77 [19.6mm]		
W5280-1XPG-535	0.35 - 0.40 [8.9-10.2mm]	Ø0.83 [21.1mm]		

NO. OF CONTACTS

GROMMET SIZE
SEE P/N LIST

NO. OF CONTACTS

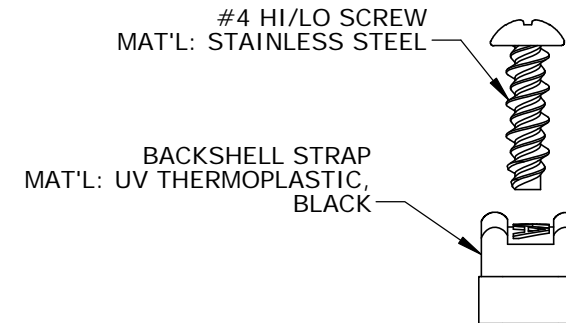

CUSTOMER APPROVAL	
THIS DOCUMENT CONTAINS CONFIDENTIAL INFORMATION PROPRIETARY TO CONXALL CORPORATION. ANY REPRODUCTION, DISCLOSURE, OR USE OF THIS DOCUMENT /INFORMATION IS EXPRESSLY PROHIBITED UNLESS AUTHORIZED IN WRITING BY CONXALL CORPORATION.	
APPROVED BY: _____	DATE: _____

A	PAK	08/16/19	DRAWING CREATED & RELEASED PER DOR 10-2523JS-1	
REV.	INIT.	DATE	DESCRIPTION	
	PAK	09/30/14	ORIG. DRAWN BY: DATE: 09/30/14	
ALL INFORMATION ILLUSTRATED IS THE PROPERTY OF "CONXALL CORPORATION." UNAUTHORIZED DUPLICATION OR DISTRIBUTION OF THIS DOCUMENT IS PROHIBITED.			CHECKED BY: _____	
ALL UNITS ARE IN FEET, INCHES, FRACTION OF INCHES AND DECIMALS.			APPROVED BY: _____	
UNLESS OTHERWISE SPECIFIED TOLERANCES: 3 PLACE DECIMALS ±.005 ANGLES ±1° FRACTIONS ±1/16			TITLE: CABLE TO CABLE CONNECTOR KIT #20 PIN CONTACTS (CRIMP), BACKSHELL CLAMP MULTI-CON-X, E-KEY, WEATHER RESISTANT STANDARD PRODUCT	
FILE: W5280-1XPG-5XX			DIRECTORY: SLW	PART NUMBER: W5280-1XPG-5XX
				REV A

Mouser Electronics

Authorized Distributor

Click to View Pricing, Inventory, Delivery & Lifecycle Information:

[Switchcraft:](#)

[W5280-10PG-530](#)