

- NOTES:
1. PARTS TO BE BULK PACKED.
 2. ASSEMBLE CONTACTS INTO CONNECTOR AFTER CRIMPING ONTO WIRES.
 3. ALL DIMENSIONS ARE REFERENCE ONLY EXCEPT WHERE NOTED WITH TOLERANCE. DIMENSIONS IN BRACKETS [] ARE METRIC.

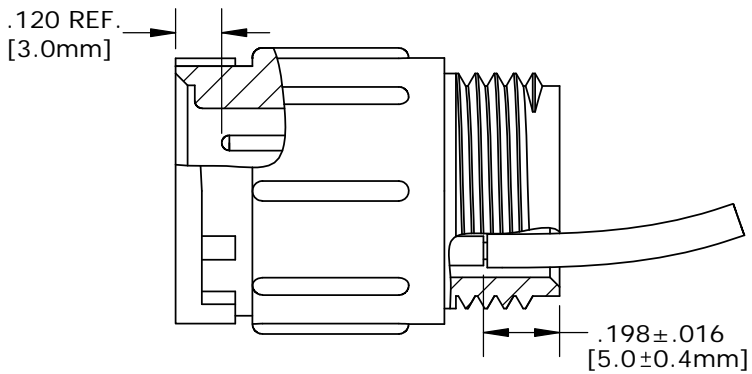

CONTACT
INSERTION VIEW

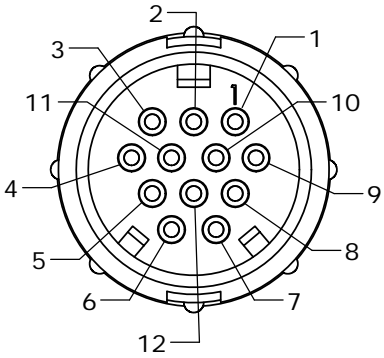

FACE VIEW
W5280-12PG-3XX

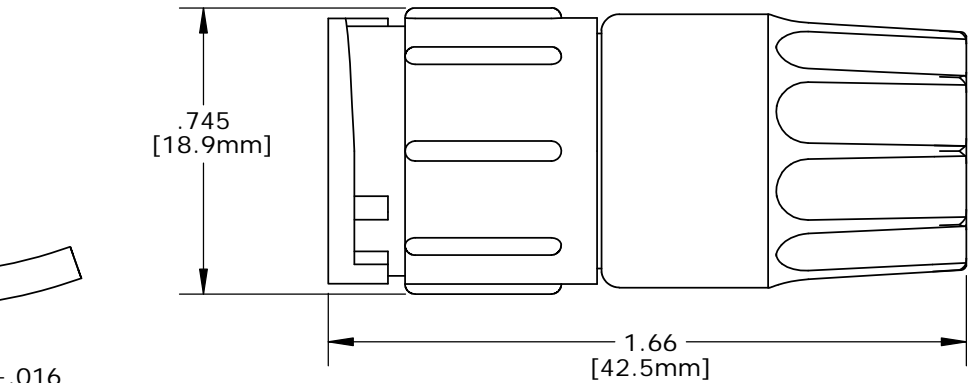

ASSEMBLED VIEW

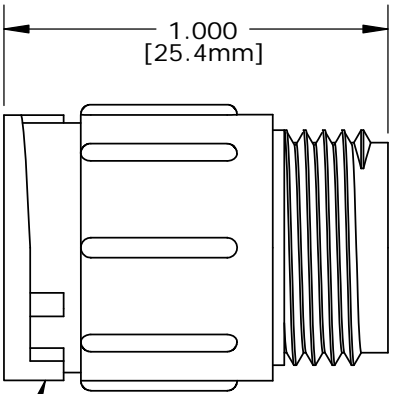

CABLE IN-LINE INSERT, MALE
MAT'L: UV THERMOPLASTIC,
BLACK



#20 PIN CONTACTS
CRIMP,
GOLD PLATED

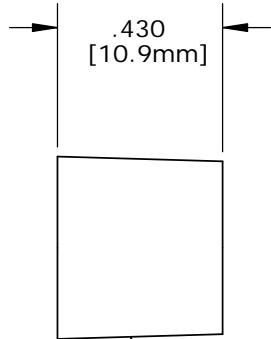

GROMMET,
MAT'L: RUBBER,
BLACK
FOR CABLE O.D.
SEE TABLE

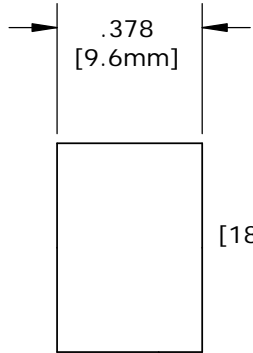

SLEEVE
MAT'L: THERMOPLASTIC,
BLACK

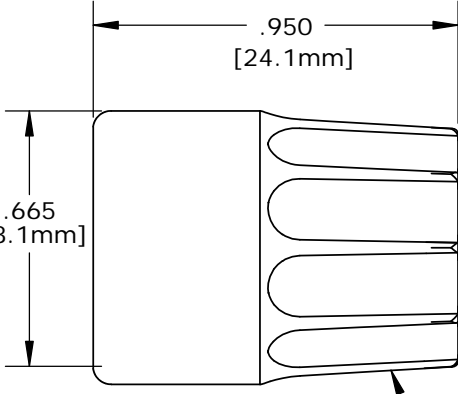

BACKSHELL
MAT'L: UV THERMOPLASTIC,
BLACK

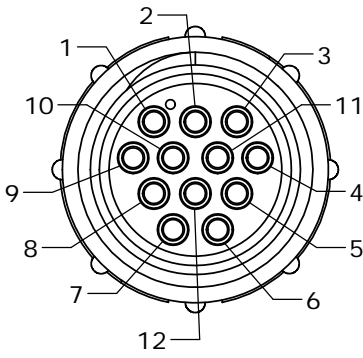

WIRE VIEW

KIT PART NO.	GROMMET SIZE TO FIT CABLE O.D.
W5280-XPG-324	0.24 - 0.27 [6.1-6.8mm]
W5280-XPG-328	0.28 - 0.29 [7.1-7.4mm]
W5280-XPG-330	0.30 - 0.32 [7.6-8.1mm]
W5280-XPG-3DC	0.12-0.17-0.24 [3.0-4.3-6.1mm]

NO. OF CONTACTS

KIT P/N	NO/ OF CONTACTS
W5280-10PG-3XX	(10) - #20
W5280-11PG-3XX	(11) - #20
W5280-12PG-3XX	(12) - #20
W5280-1XPG-3XX	

GROMMET SIZE
SEE P/N LIST
NO. OF CONTACTS

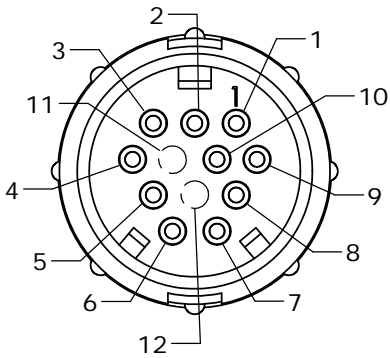

FACE VIEW
W5280-10PG-3XX

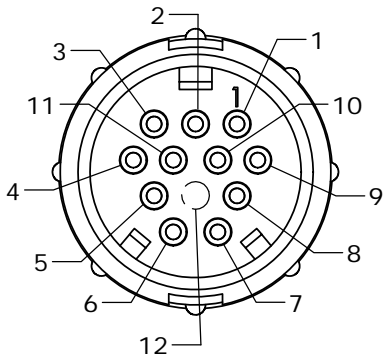

FACE VIEW
W5280-11PG-3XX

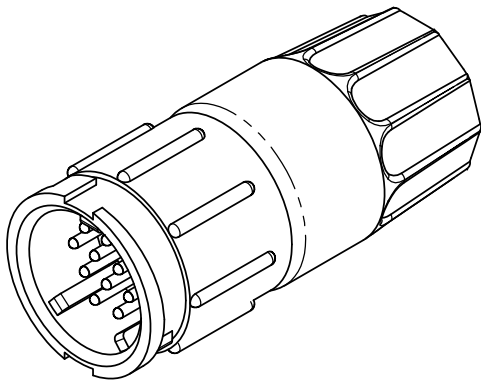

CUSTOMER APPROVAL

THIS DOCUMENT CONTAINS CONFIDENTIAL INFORMATION PROPRIETARY TO CONXALL CORPORATION. ANY REPRODUCTION, DISCLOSURE, OR USE OF THIS DOCUMENT /INFORMATION IS EXPRESSLY PROHIBITED UNLESS AUTHORIZED IN WRITING BY CONXALL CORPORATION.

APPROVED BY: _____

DATE: _____

A	PAK	08/16/19	DRAWING CREATED & RELEASED PER DOR 10-2523JS-1		
REV.	INIT.	DATE	DESCRIPTION		
	PAK	09/30/14	ORIG. DRAWN BY:	DATE:	 601 E. WILDWOOD VILLA PARK, IL 60181
			CHECKED BY:		
			APPROVED BY:		
			SCALE	SIZE	SHEET
			NTS	B	1 OF 1
			FILE:	DIRECTORY:	PART NUMBER:
			W5280-1XPG-3XX	SLW	W5280-1XPG-3XX
					REV A

TITLE: CABLE TO CABLE CONNECTOR KIT
#20 PIN CONTACTS (CRIMP)
MULTI-CON-X, E-KEY, WEATHER RESISTANT
STANDARD PRODUCT

Mouser Electronics

Authorized Distributor

Click to View Pricing, Inventory, Delivery & Lifecycle Information:

[Switchcraft:](#)

[W5280-10PG-328](#)