

- NOTES:
1. ALL PARTS TO BE BULK PACKED.
 2. CONTACTS ASSEMBLED INTO CONNECTOR.
 3. BACK WELL FILLED WITH EPOXY.
 4. ALL DIMENSIONS ARE REFERENCE ONLY EXCEPT WHERE NOTED WITH A TOLERANCE. DIMENSIONS IN BRACKETS [] ARE METRIC.
 5. PC TAIL LENGTH OPTIONS:
 - STANDARD (SHORT) TAIL = 0.114in [W4281-1XPG-3ES]
 - INTERMEDIATE = 0.202in [W4291-1XPG-3ES]
 - LONG = 0.257in [W4292-1XPG-3ES]

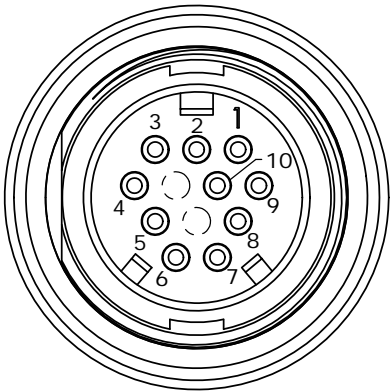

MATING VIEW
W4292-10PG-3ES
10-POS.

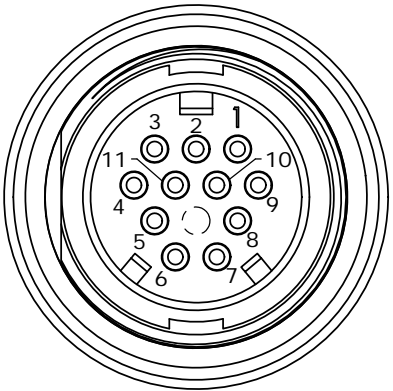

MATING VIEW
W4292-11PG-3ES
11-POS.

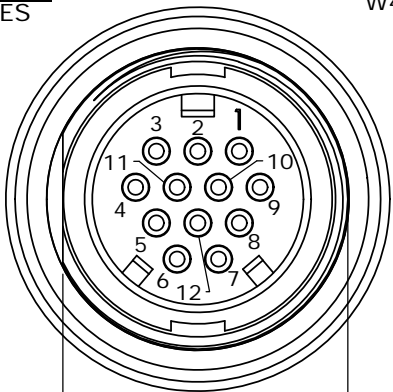

MATING VIEW
W4292-12PG-3ES
12-POS.

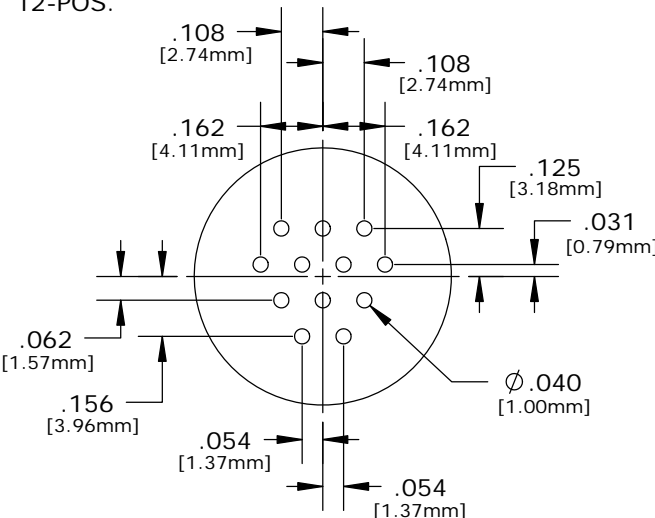
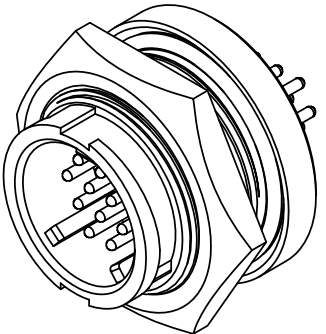

PC TAIL LAYOUT

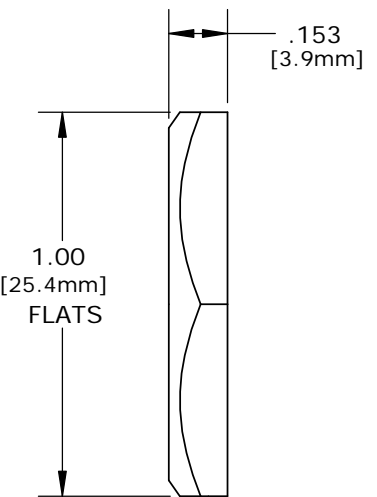

HEX NUT
MAT'L: UV THERMOPLASTIC, BLACK

O-RING
MAT'L: RUBBER, BLACK

13/16-27 UNS-2A
MOD. THREAD

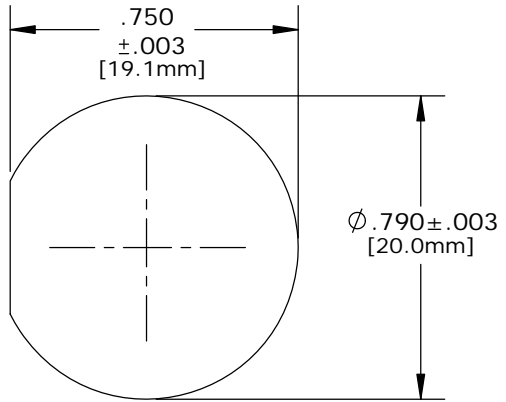

**RECOMMENDED
PANEL CUTOUT**
STANDARD MULTI-CON-X

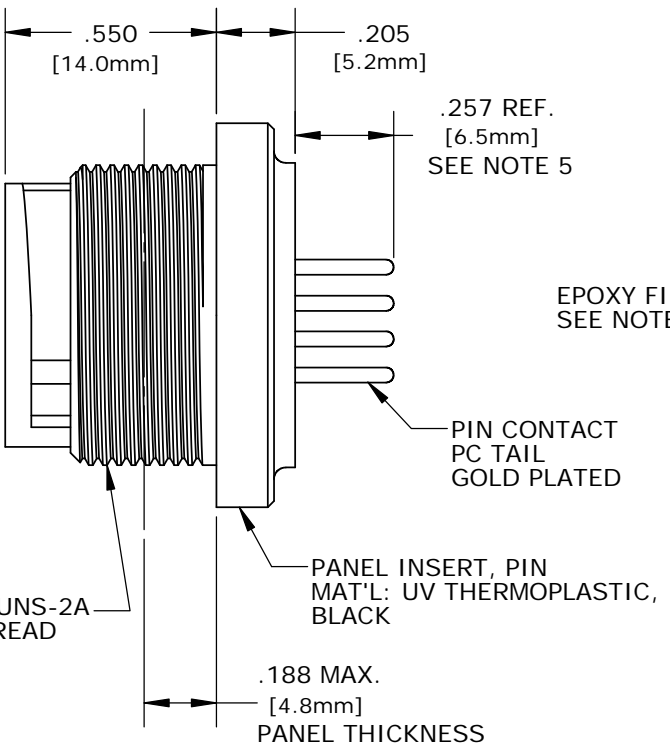

PIN CONTACT
PC TAIL
GOLD PLATED

PANEL INSERT, PIN
MAT'L: UV THERMOPLASTIC, BLACK

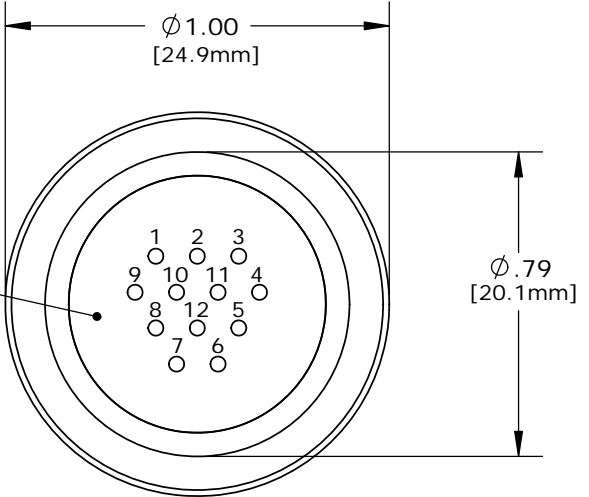

PC TAIL VIEW
W4292-10PG-3ES - 10-POS. (11&12 CLOSED)
W4292-11PG-3ES - 11-POS. (12 CLOSED)
W4292-12PG-3ES - 12-POS. (ALL OPEN)

| ASS'Y P/N | CONTACTS | HOLE POS. CLOSED |
|----------------|----------|---------------------|
| W4292-10PG-3ES | 10 - #20 | 11, 12 |
| W4292-11PG-3ES | 11 - #20 | 12 |
| W4292-12PG-3ES | 12 - #20 | NONE |
| W4292-1XPG-3ES | | |

NO. OF CONTACTS

| | |
|---|-------------|
| CUSTOMER APPROVAL | |
| THIS DOCUMENT CONTAINS CONFIDENTIAL INFORMATION PROPRIETARY TO CONXALL CORPORATION. ANY REPRODUCTION, DISCLOSURE, OR USE OF THIS DOCUMENT /INFORMATION IS EXPRESSLY PROHIBITED UNLESS AUTHORIZED IN WRITING BY CONXALL CORPORATION. | |
| APPROVED BY: _____ | DATE: _____ |

| | | | | | |
|--|-------|----------|--|--|--|
| A | PAK | 09/12/19 | DRAWING CREATED AND RELEASED PER DOR 10-2523JS-1 | | |
| REV. | INIT. | DATE | DESCRIPTION | | |
| | PAK | 10/22/14 | ORIG. DRAWN BY: DATE: 10/22/14 | | |
| ALL INFORMATION ILLUSTRATED IS THE PROPERTY OF "CONXALL CORPORATION". UNAUTHORIZED DUPLICATION OR DISTRIBUTION OF THIS DOCUMENT IS PROHIBITED. | | | CHECKED BY: | | |
| ALL UNITS ARE IN FEET, INCHES, FRACTION OF INCHES AND DECIMALS. | | | APPROVED BY: | | |
| UNLESS OTHERWISE SPECIFIED TOLERANCES: 3 PLACE DECIMALS ±.005 ANGLES ±1° FRACTIONS ±1/16 ± CRITICAL CHARACTERISTIC FLAG PER SPEC. XXXX | | | TITLE: PANEL PIN, W/ EPOXY, E-KEY 12-POS., #20 PC TAIL, LONG MULTI-CON-X, WEATHER RESISTANT STANDARD PRODUCT | | |
| FILE: W4292-1XPG-3ES | | | CUSTOMER: STANDARD PRODUCT | | |
| DIRECTORY: SLW | | | PART NUMBER: W4292-1XPG-3ES | | |
| | | | REV A | | |

Mouser Electronics

Authorized Distributor

Click to View Pricing, Inventory, Delivery & Lifecycle Information:

Switchcraft:

[W4292-11PG-3ES](#) [W4292-12PG-3ES](#) [W4292-10PG-3ES](#)