

CAP

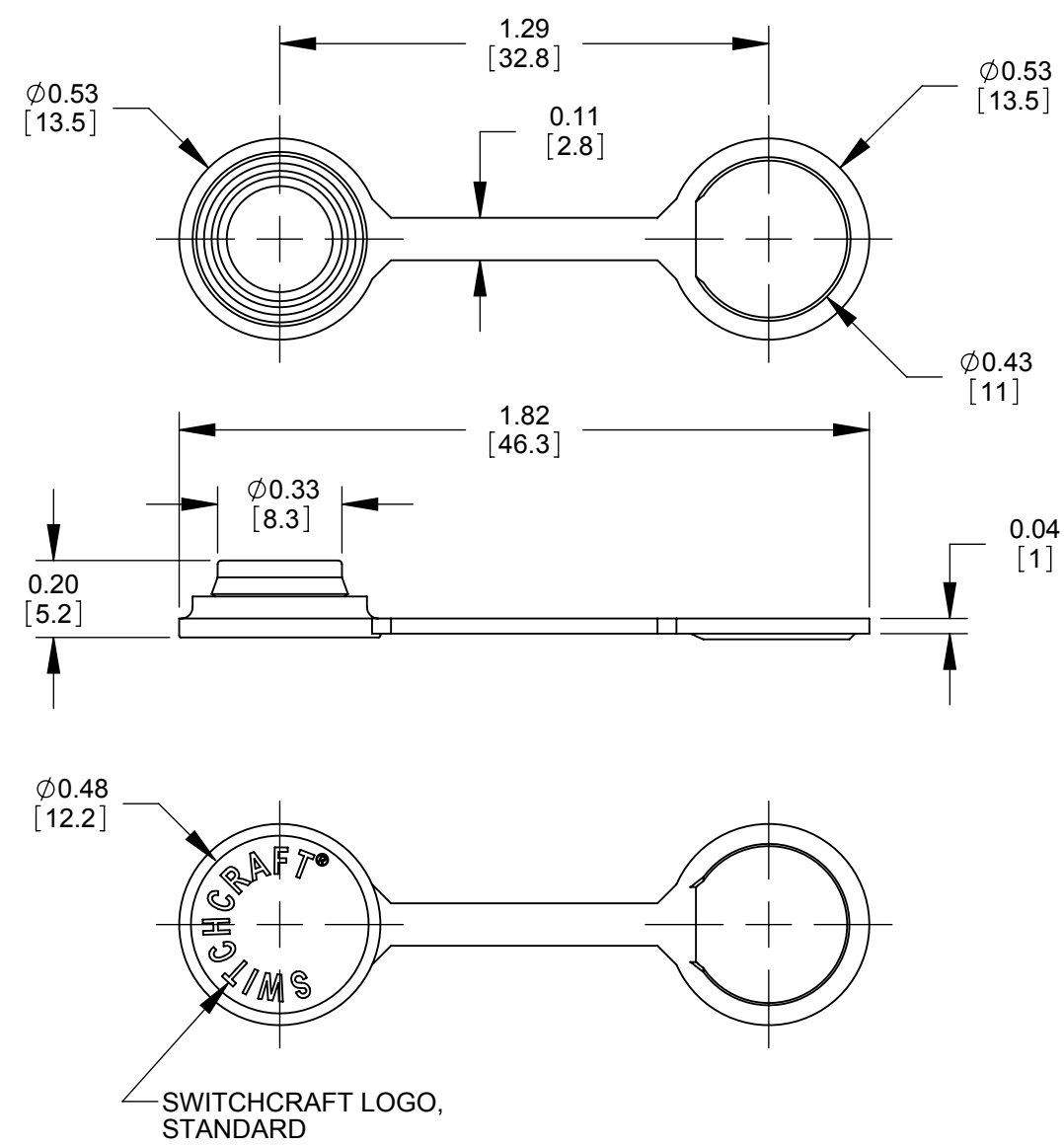

WASHER

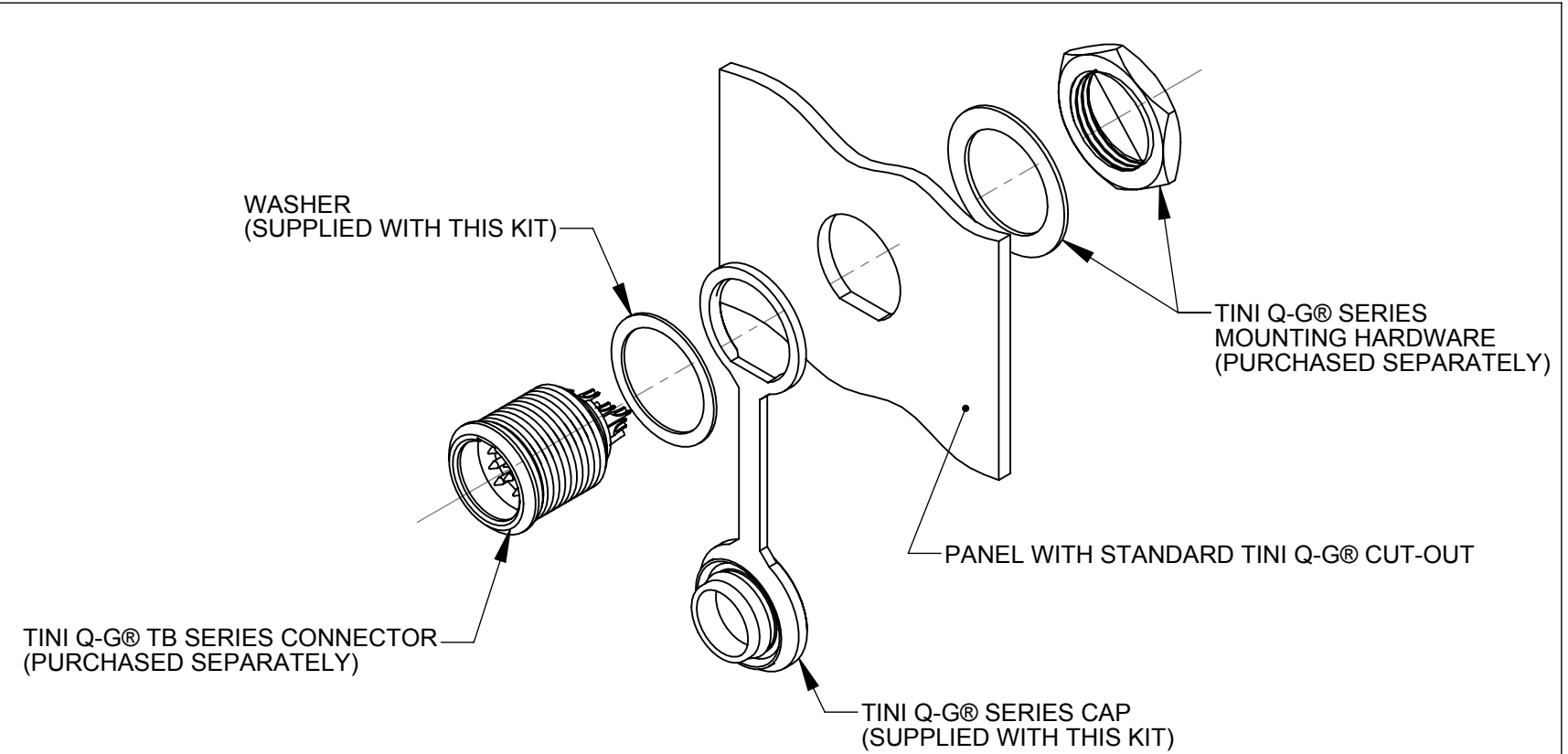
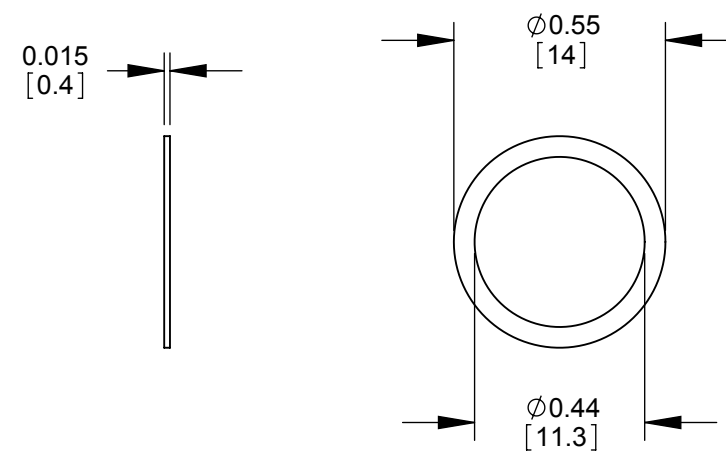

TINI Q-G® TB SERIES WITH CAP MOUNTING DETAILS

- NOTES:
- 1. DIMENSIONS SHOWN FOR REFERENCE ONLY
 - 2. MATERIAL:
CAP: THERMOPLASTIC ELASTOMER, BLACK COLOR
WASHER: STAINLESS STEEL
 - 3. THIS PART IS RoHS COMPLIANT

CUSTOMER DRAWING

					<div>UNLESS OTHERWISE SPECIFIED</div> <div>1. ALL DIMENSIONS IN INCHES</div> <div>- TWO PLACE DECIMALS ±0.02</div> <div>- THREE PLACE DECIMALS ±0.005</div>	THIS DRAWING DESCRIBES A DESIGN CONSIDERED PROPRIETARY IN NATURE, DEVELOPED AND MANUFACTURED BY SWITCHCRAFT INC. AND IS RELEASED ON A CONFIDENTIAL BASIS FOR IDENTIFICATION PURPOSES ONLY.											
						SIZE	WIDTH		MULT		LBS/M		TEMPER				
						FINISH						MATERIAL					
						SPEC No.						SPEC No.					
						FIRST USED ON				SCALE 2:1		<div>Switchcraft®</div>					
						DATE DRAWN	BY	CHKD		APVD							
A	ECO# 26538	04/29/10	PNK	SRC		03/01/10	PNK	PNK		SRC		SHEET 1 OF 1					
							03/01/10		03/01/10								
REV	ECO NUMBER	DATE	BY	APVD	NAME					CAP KIT					PART No.		REV
REVISIONS					DO NOT SCALE DRAWING					TINI Q-G® TB SERIES					TINICAPT B		A

Mouser Electronics

Authorized Distributor

Click to View Pricing, Inventory, Delivery & Lifecycle Information:

[Switchcraft:](#)

[TINICAPTB](#)