

TB3MS
3 PIN

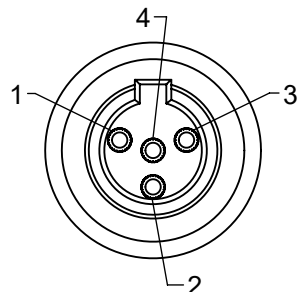

TB4MS
4 PIN

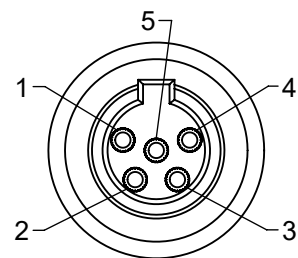

TB5MS
5 PIN

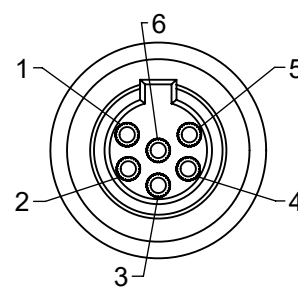

TB6MS
6 PIN

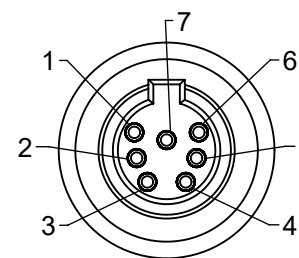

TB7MS
7 PIN

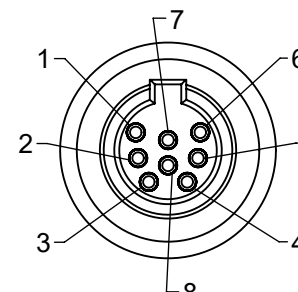

TB8MS
8 PIN

AS VIEWED FROM FRONT MATING SIDE

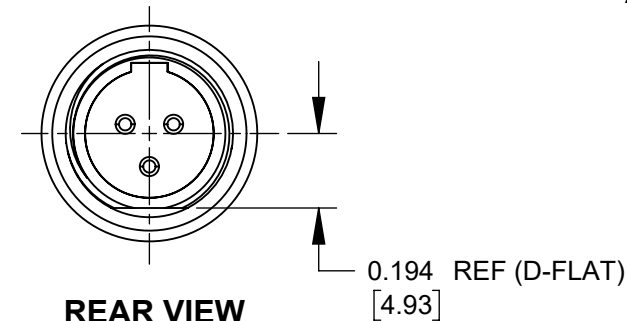
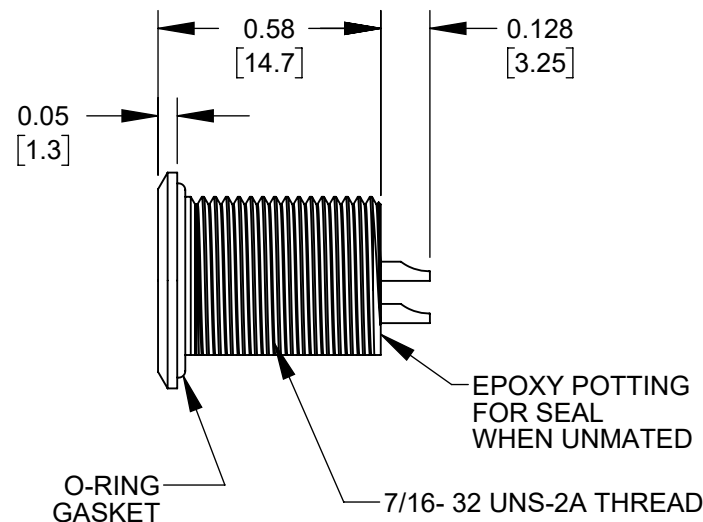
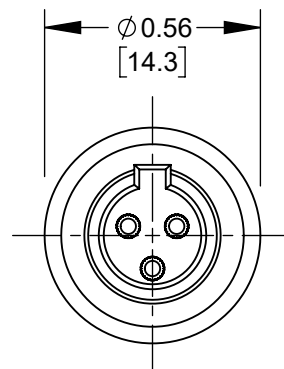
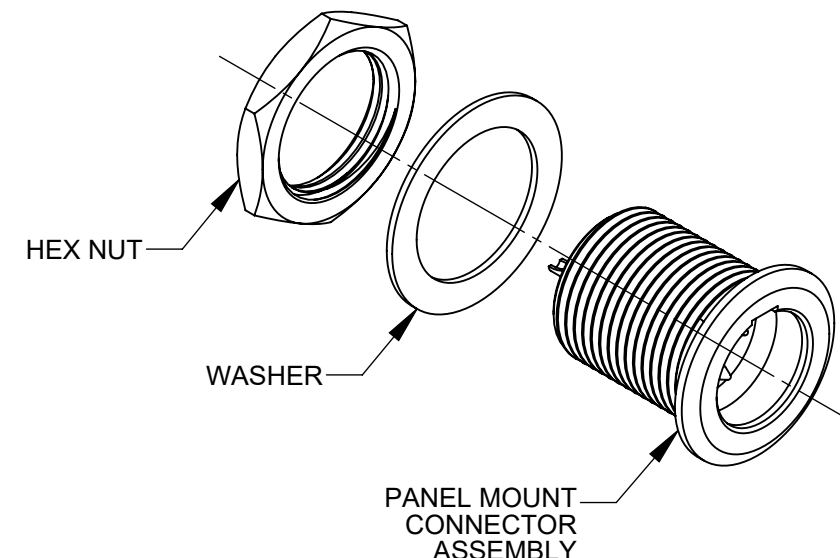
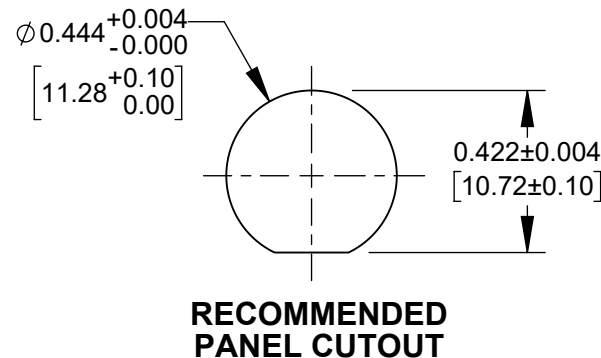
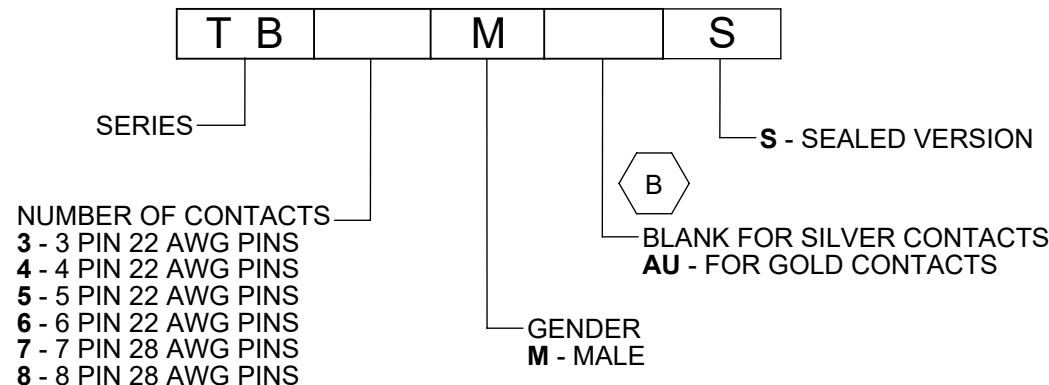

TB3MS SHOWN

NOTES:

1. MATERIALS:

HOUSING - COPPER ALLOY, NICKEL PLATED
PIN CONTACTS - COPPER ALLOY, SILVER OR GOLD PLATED
PIN INSULATOR - THERMOPLASTIC RUBBER, BLACK
HEX NUT & WASHER - COPPER ALLOY, NICKEL PLATED
O-RING GASKET - THERMOPLASTIC RUBBER, BLACK

2. PRODUCT IS RATED IP-66 MATED AND IP-65 UNMATED.

3. THIS PRODUCT IS RoHS COMPLIANT.

REV	ECO NUMBER	DATE	BY	APVD
C	28414	07-16-21	PC	TJK
B	27989	1-12-18	PC	TJK
A	27552	8-14-15	TO	TJK

REVISIONS

UNLESS OTHERWISE SPECIFIED

1. ALL DIMENSIONS IN INCHES [mm]
- TWO PLACE DECIMALS ±0.02 [0.5]
- THREE PLACE DECIMALS ±0.005 [0.13]

DO NOT SCALE DRAWING

THIS DRAWING DESCRIBES A DESIGN CONSIDERED PROPRIETARY IN NATURE, DEVELOPED AND MANUFACTURED BY SWITCHCRAFT INC. AND IS RELEASED ON A CONFIDENTIAL BASIS FOR IDENTIFICATION PURPOSES ONLY.

SIZE		WIDTH		MULT		LBS/M		TEMPER	
FINISH SPEC No.					MATERIAL SPEC No.				
FIRST USED ON			SCALE 2:1		Switchcraft®				
DATE DRAWN 1/29/13	BY AB	CHKD AB 1/29/13	APVD TJK 9-28-15						
					SHEET 1 OF 1				
NAME TINI Q-G MINI XLR CONNECTOR SEALED MALE PANEL MOUNT, RoHS					PART No. TB_MS SERIES			REV C	

CUSTOMER DRAWING

Mouser Electronics

Authorized Distributor

Click to View Pricing, Inventory, Delivery & Lifecycle Information:

Switchcraft:

[TB6MS](#) [TB3MS](#) [TB4MS](#) [TB5MS](#) [TB7MS](#) [TB8MS](#)