

**TA3MS SERIES  
3 PIN**

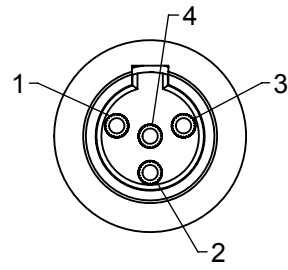

**TA4MS SERIES  
4 PIN**

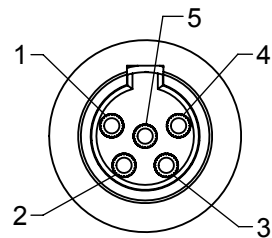

**TA5MS SERIES  
5 PIN**

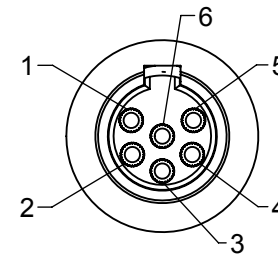

**TA6MS SERIES  
6 PIN**

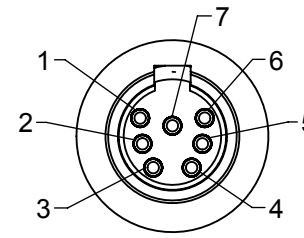

**TA7MS SERIES  
7 PIN**

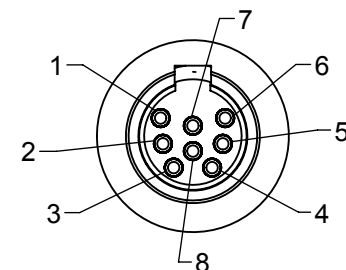

**TA8MS SERIES  
8 PIN**

**AS VIEWED FROM FRONT MATING VIEW**

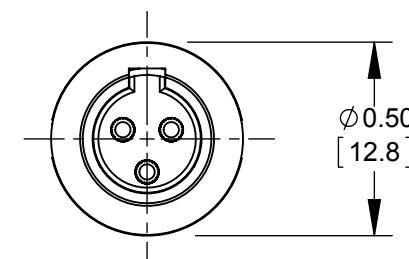
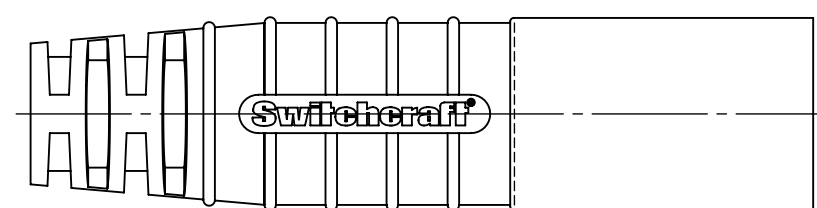
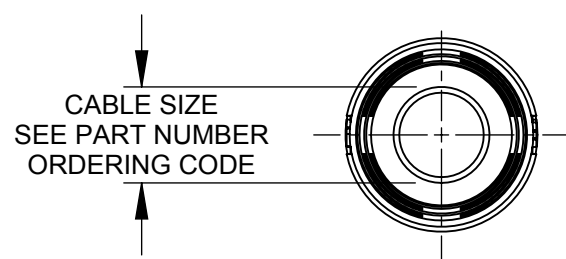
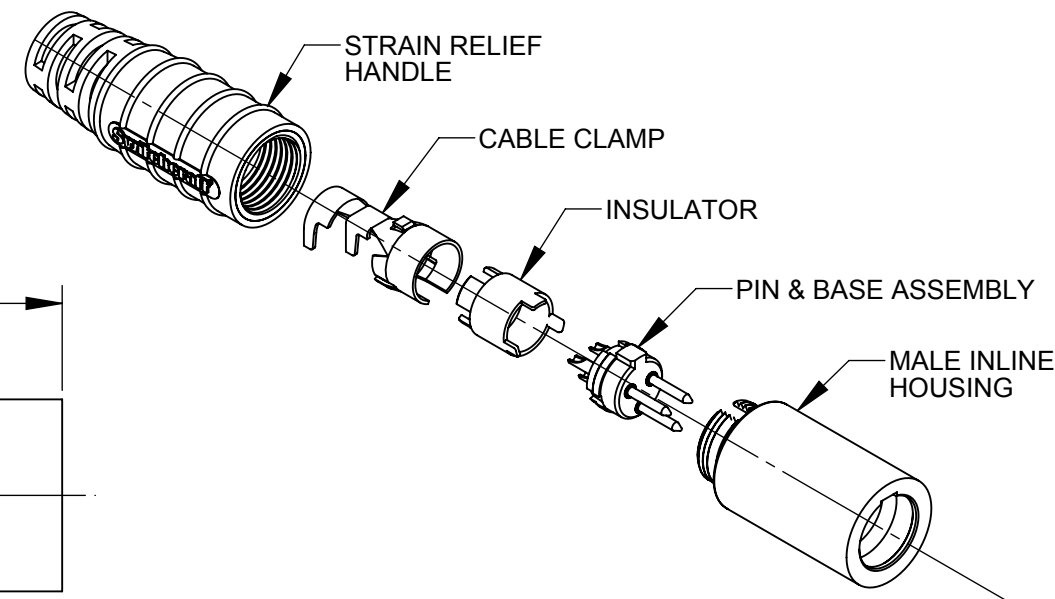
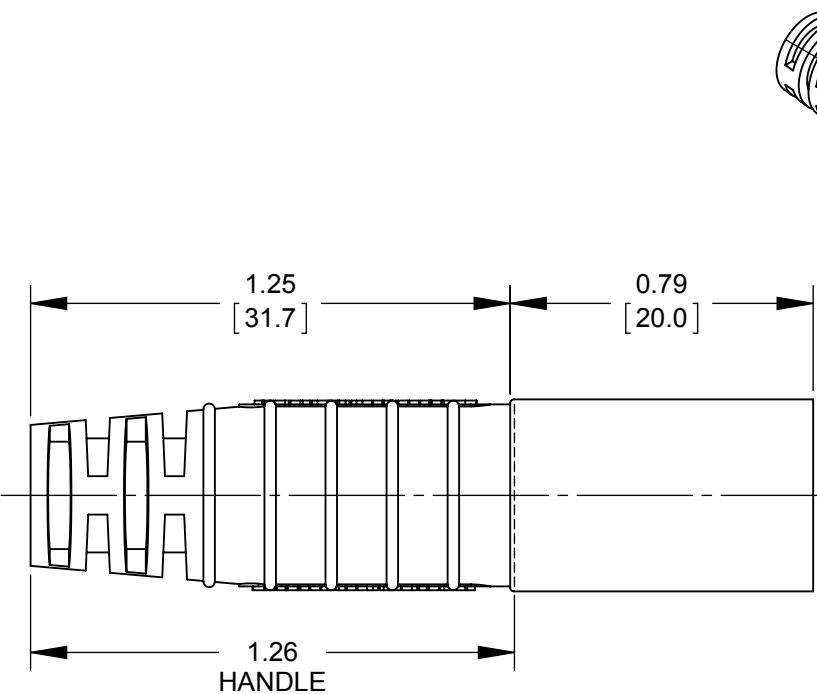
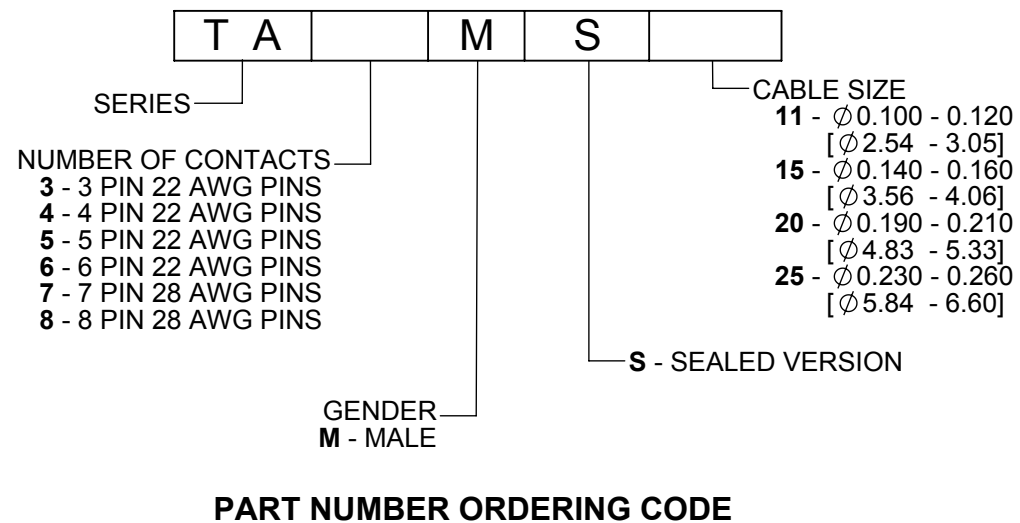

**CUSTOMER DRAWING**

**NOTES:**

- MATERIALS:**  
HOUSING - COPPER ALLOY, NICKEL-PLATED  
PIN CONTACTS - COPPER ALLOY, SILVER PLATED  
PIN INSULATOR - RIGID DARK BROWN THERMOPLASTIC  
CABLE CLAMP - STEEL, TIN PLATED  
BUTTON BOOT - BLACK THERMOPLASTIC RUBBER  
INSERT MOLDED HANDLE - THERMOPLASTIC RUBBER OVER RIGID THERMOPLASTIC, BLACK
- THIS PRODUCT IS RoHS COMPLIANT.

					UNLESS OTHERWISE SPECIFIED					THIS DRAWING DESCRIBES A DESIGN CONSIDERED PROPRIETARY IN NATURE, DEVELOPED AND MANUFACTURED BY SWITCHCRAFT INC. AND IS RELEASED ON A CONFIDENTIAL BASIS FOR IDENTIFICATION PURPOSES ONLY.									
					1. ALL DIMENSIONS IN INCHES [mm] - TWO PLACE DECIMALS ±0.02 [0.5] - THREE PLACE DECIMALS ±0.005 [0.13]					SIZE		WIDTH		MULT		LBS/M		TEMPER	
					DO NOT SCALE DRAWING					FINISH				MATERIAL					
										SPEC No.				SPEC No.					
										FIRST USED ON				SCALE					
										DATE DRAWN				APVD					
										1/29/13				TJK					
										BY				CHKD					
										AB				AB					
										1/29/13				9-28-15					
										NAME				PART No.					
										SEALED TINI Q-G				TA_MS SERIES					
										MALE, RoHS				REV					
														B					

# Mouser Electronics

Authorized Distributor

Click to View Pricing, Inventory, Delivery & Lifecycle Information:

## Switchcraft:

[TA8MS15](#) [TA8MS11](#) [TA4MS11](#) [TA4MS15](#) [TA3MS20](#) [TA3MS25](#) [TA7MS15](#) [TA7MS11](#) [TA8MS25](#) [TA4MS20](#)  
[TA8MS20](#) [TA4MS25](#) [TA6MS20](#) [TA6MS25](#) [TA5MS25](#) [TA5MS20](#) [TA5MS15](#) [TA5MS11](#) [TA7MS20](#) [TA7MS25](#)  
[TA6MS11](#) [TA6MS15](#) [TA3MS15](#) [TA3MS11](#)