

- NOTES:
1. PLACE (1) ONE OF EACH KIT, IN A BAG WITH INSTRUCTION SHEET AND SEALED.
  2. LABEL WITH CONXALL, PART NUMBER, DATE CODE AND P/N BARCODE IS PLACED ON BAG.

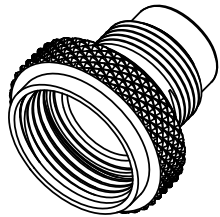
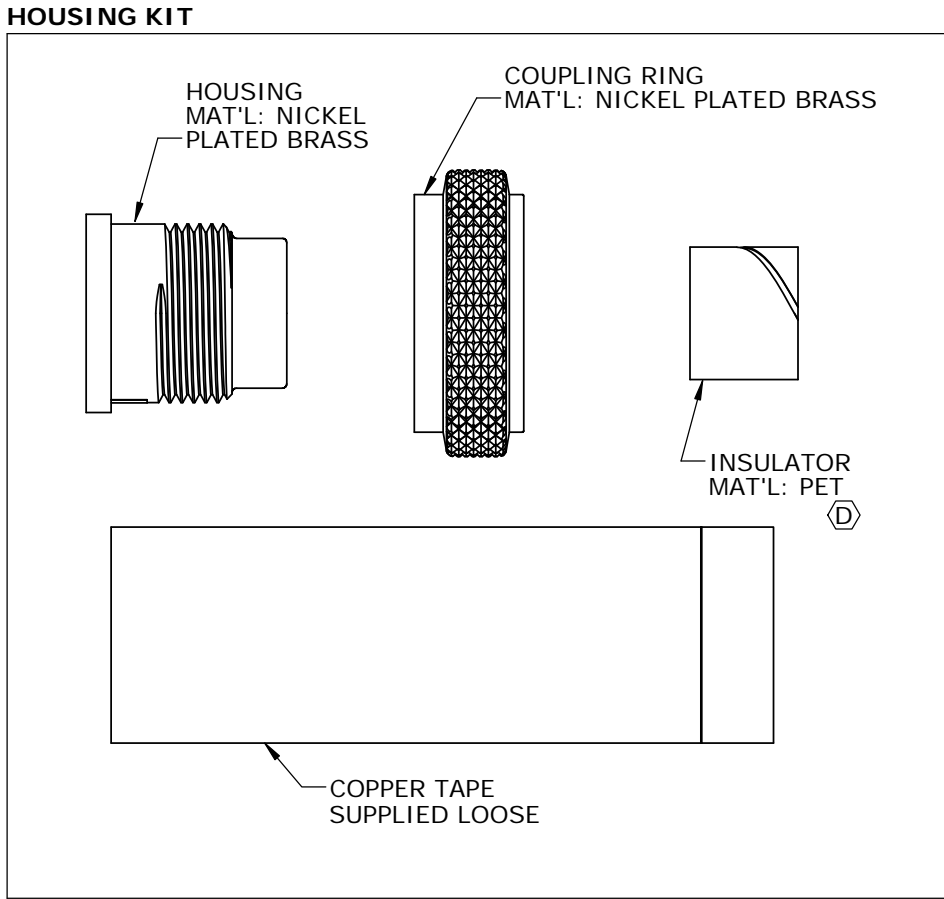
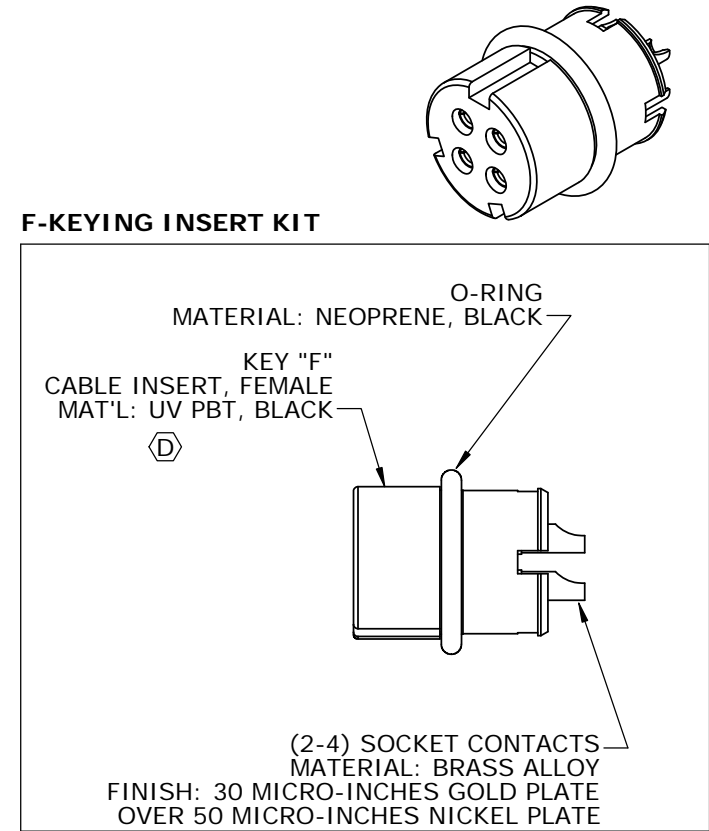
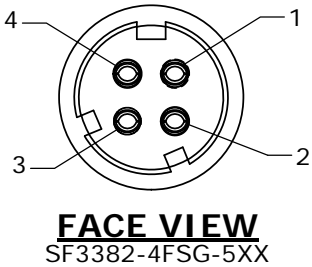
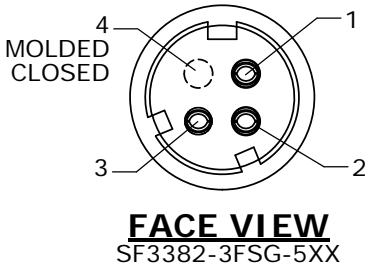
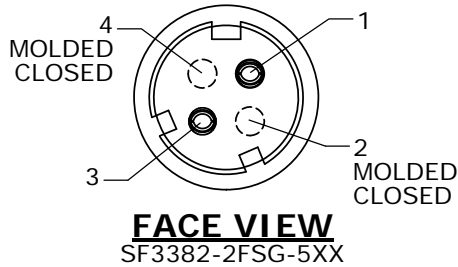

CUSTOMER APPROVAL
THIS DOCUMENT CONTAINS CONFIDENTIAL INFORMATION PROPRIETARY TO CONXALL CORPORATION. ANY REPRODUCTION, DISCLOSURE, OR USE OF THIS DOCUMENT /INFORMATION IS EXPRESSLY PROHIBITED UNLESS AUTHORIZED IN WRITING BY CONXALL CORPORATION.
APPROVED BY: _____
DATE: _____

PART NO.	CABLE I.D.
SF3382-XFSG-520	Ø .200
SF3382-XFSG-530	Ø .300
SF3382-XFSG-540	Ø .400

NO. OF CONATCTS: 2-4

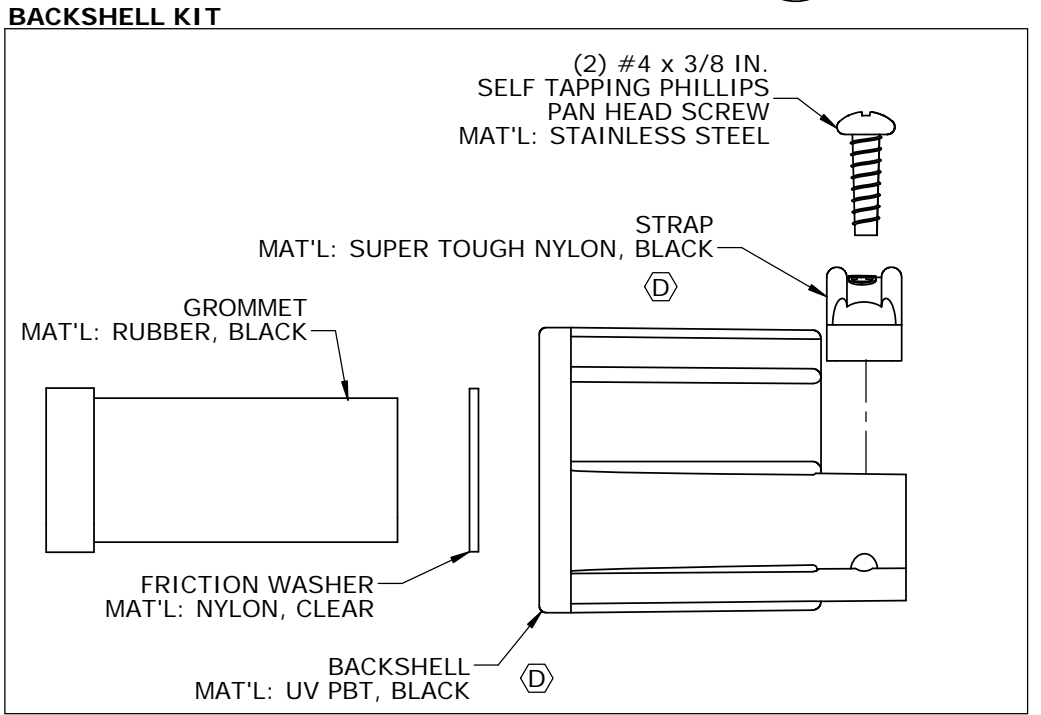
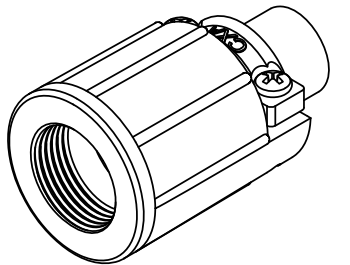

D	MA	10-08-19	SUPERSEDES DWG SF3382-XFSG-540. ADDED ASS'Y P/Ns SF3382-XSFG-520 & SF3382-XSFG-530 TO CHART. UPDATED MAT'LS ON SOME PIECE PARTS PER ECR 9439				
C	MA	08-28-17	BAG LABEL WAS M-543 PER ECR 9013				
B	PD	12-14-12	KITS WERE BULK PACKED PER ECR 8361. COPPER TAPE QTY. WAS 2 EACH PER ECR 8385				
A	PD	10-23-12	DRAWING CREATED PER DOR 12-E149SL #32				
REV.	INIT.	DATE	DESCRIPTION				
<div>ALL INFORMATION ILLUSTRATED IS THE PROPERTY OF "CONXALL CORPORATION". UNAUTHORIZED DUPLICATION OR DISTRIBUTION OF THIS DOCUMENT IS PROHIBITED.</div> <div>ALL UNITS ARE IN FEET, INCHES, FRACTION OF INCHES AND DECIMALS.</div> <div>▷ = CRITICAL CHARACTERISTIC FLAG PER SPEC. XXXX</div>			ORIG. DRAWN BY: PD		DATE: 10-23-12		<div>conxall</div> <div>601 E. WILDWOOD VILLA PARK, IL 60181</div>
			CHECKED BY:				
			APPROVED BY:				
			SCALE NTS		SIZE B	SHEET 1 OF 1	
			FILE: SF3382-XFSG-5XX		DIRECTORY: SLW		
			TITLE: CONNECTOR ASSEMBLY KIT (2-4) SOCKET CONTACTS SHIELDED MULTI-CON-X STANDARD PRODUCT		CUSTOMER:		
			PART NUMBER: SF3382-XFSG-5XX		REV D		

# Mouser Electronics

Authorized Distributor

Click to View Pricing, Inventory, Delivery & Lifecycle Information:

[Switchcraft:](#)

[SF3382-4FSG-530](#)