

NOTES:

1. ALL DIMENSIONS SHOWN ARE FOR REFERENCE ONLY.
2. SPECIFICATIONS:
CURRENT RATING: 5A, UL AND CSA
NOMINAL VOLTAGE: 250V
TEMPERATURE RANGE: -55°C TO 65°C
DIELECTRIC STRENGTH: 2000V @ 1 MINUTE
3. MATERIALS:
HOUSING: BLACK, MOLDED THERMOPLASTIC UL 94V-0
MALE PINS: COPPER ALLOY, NICKEL PLATED
PC TERMINALS: COPPER ALLOY, TIN PLATED (LEAD FREE)
4. THIS PRODUCT IS RoHS COMPLIANT.

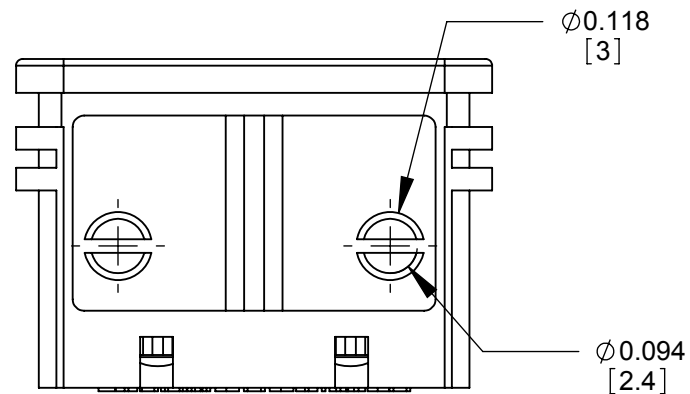
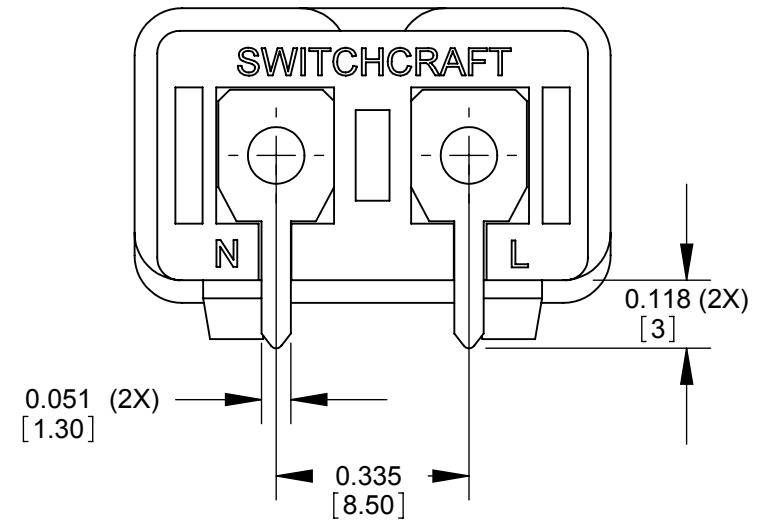
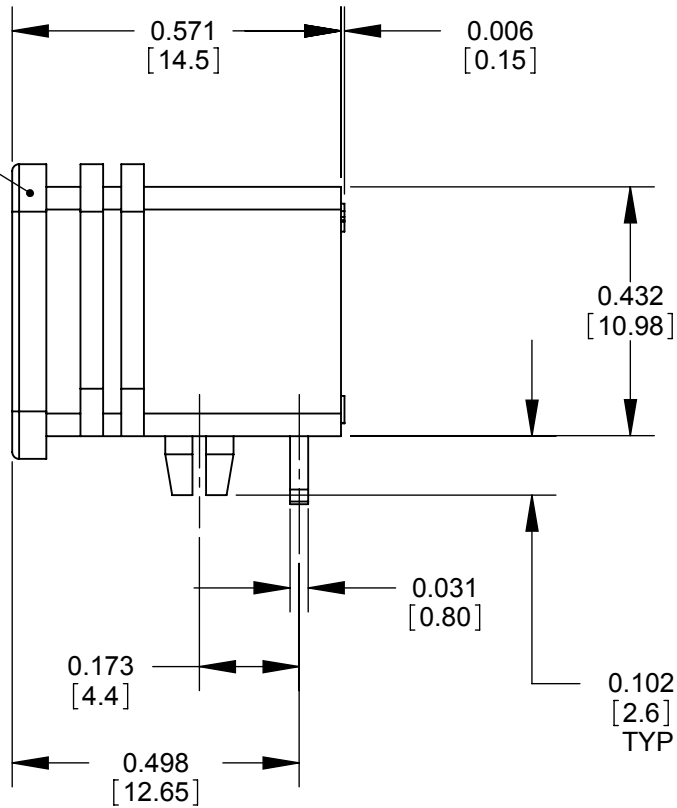
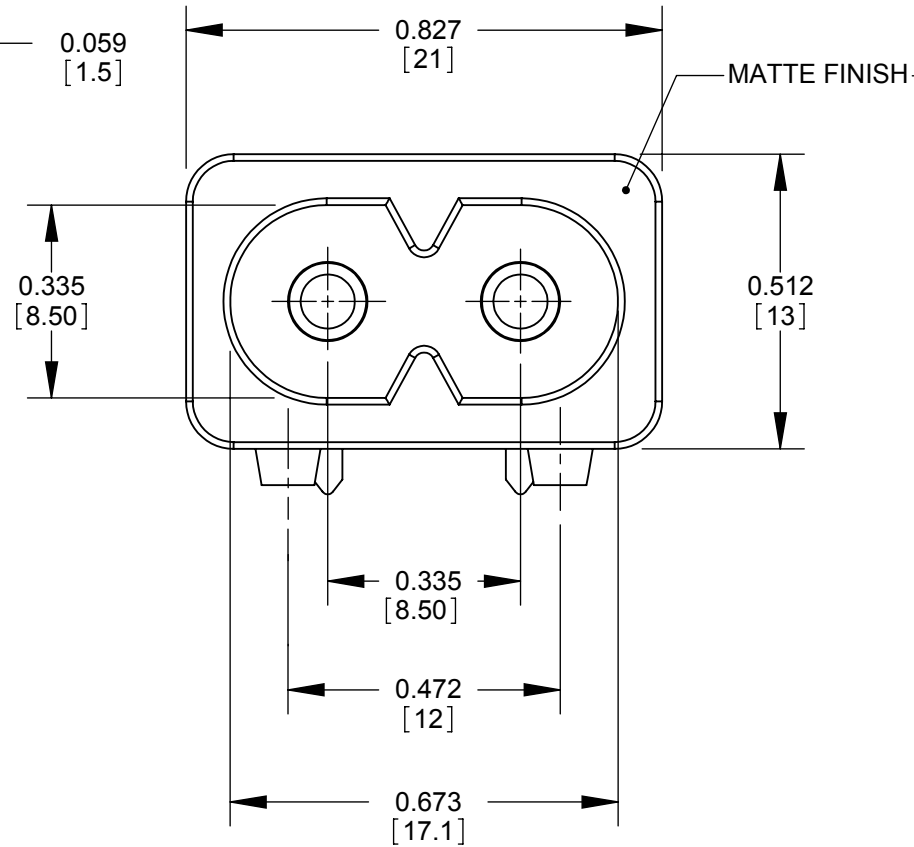

CUSTOMER DRAWING

					<div>UNLESS OTHERWISE SPECIFIED</div> <div>1. ALL DIMENSIONS IN INCHES</div> <div>- TWO PLACE DECIMALS ±0.02</div> <div>- THREE PLACE DECIMALS ±0.005</div>	THIS DRAWING DESCRIBES A DESIGN CONSIDERED PROPRIETARY IN NATURE, DEVELOPED AND MANUFACTURED BY SWITCHCRAFT INC. AND IS RELEASED ON A CONFIDENTIAL BASIS FOR IDENTIFICATION PURPOSES ONLY.															
						SIZE	WIDTH		MULT		LBS/M		TEMPER								
						FINISH						MATERIAL									
						SPEC No.						SPEC No.									
						FIRST USED ON				SCALE 3:1		<div>Switchcraft®</div>									
B	27381	10-10-14	TJK	TJK		DATE DRAWN	BY	CHKD		APVD											
A	26126	9-12-06	RF	TJK		9-12-06	RF	RF		TJK											
							9-12-06		9-12-06		SHEET 1 OF 1										
REV	ECO NUMBER	DATE	BY	APVD	NAME										PART No.		REV				
REVISIONS					DO NOT SCALE DRAWING					2 PIN MALE RECEPTACLE, RoHS					RAPC322X					B	

Mouser Electronics

Authorized Distributor

Click to View Pricing, Inventory, Delivery & Lifecycle Information:

[Switchcraft:](#)

[RAPC322X](#)