

EHRJ45D6AS
SHOWN

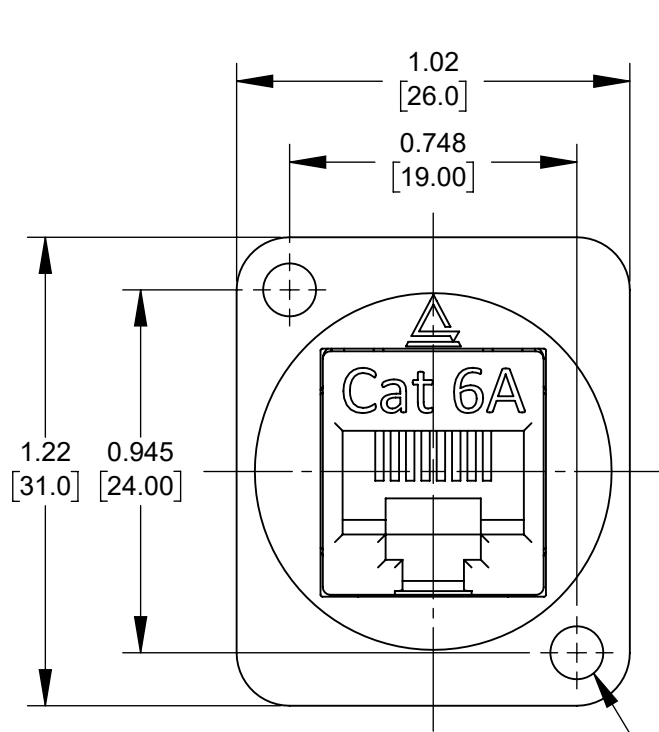

MOUNTING HOLE
2 PLACES
SEE TABLE

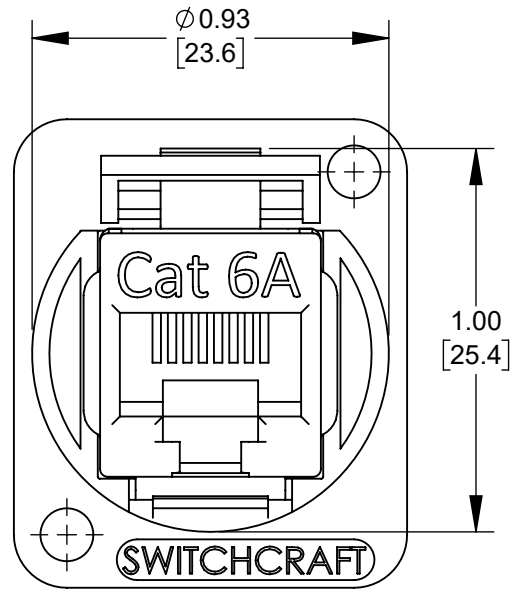
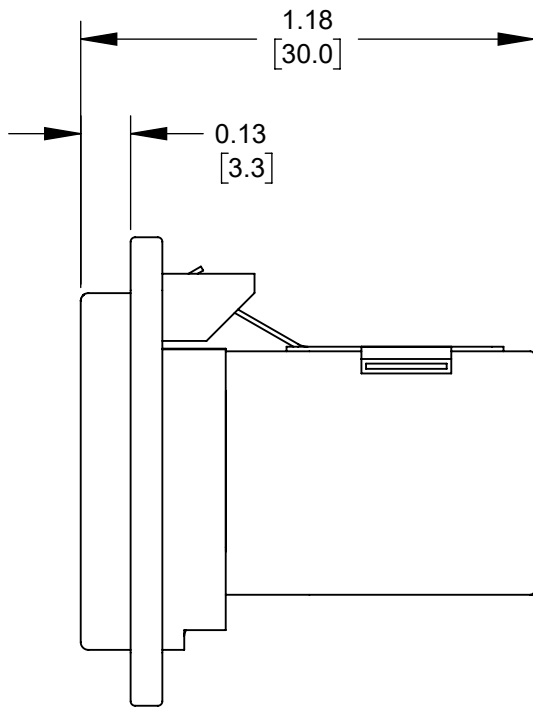

PART NUMBER	MOUNTING FLANGE FINISH	MOUNTING HOLE
EHRJ45D6AS	NICKEL	Ø 0.138 [3.50] THRU-HOLE
EHRJ45D6ASB	BLACK CHROME	Ø 0.138 [3.50] THRU-HOLE
EHRJ45D6AS440	NICKEL	#4-40 THREAD
EHRJ45D6ASB440	BLACK CHROME	#4-40 THREAD
EHRJ45D6ASM3	NICKEL	M3 X 0.5 THREAD
EHRJ45D6ASBM3	BLACK CHROME	M3 X 0.5 THREAD

- NOTES:
1. SHIPPED ASSEMBLED WITHOUT PANEL MOUNTING HARDWARE. ADD "PKG" SUFFIX TO INCLUDE MOUNTING SCREWS AND INDIVIDUAL PACKAGING.
 2. MATERIALS:
MOUNTING FLANGE - ZINC ALLOY, SEE TABLE FOR FINISH
RJ45 BODY - THERMOPLASTIC, BLACK
RJ45 SHIELD - COPPER ALLOY, NICKEL PLATED
RJ45 CONTACTS - COPPER ALLOY, GOLD PLATED
 3. SPECIFICATIONS:
RJ45 CONNECTOR MEETS TIA/EIA-568 STANDARD.
PHYSICAL CHARACTERISTICS
INSERTION LIFE: 750 MATING CYCLES WITH FCC PLUG
OPERATING TEMP: -10°C TO +60°C (14°F TO +140°F)
ELECTRICAL
INSULATION RESISTANCE: 500MOHM
DIELECTRIC WITHSTANDING VOLTAGE: 1000V
DC CURRENT RATING: 1.5 AMPS
DC RESISTANCE: 0.1OHM
CONTACT RESISTANCE: 20mOHM
 4. THESE PRODUCTS ARE RoHS COMPLIANT.

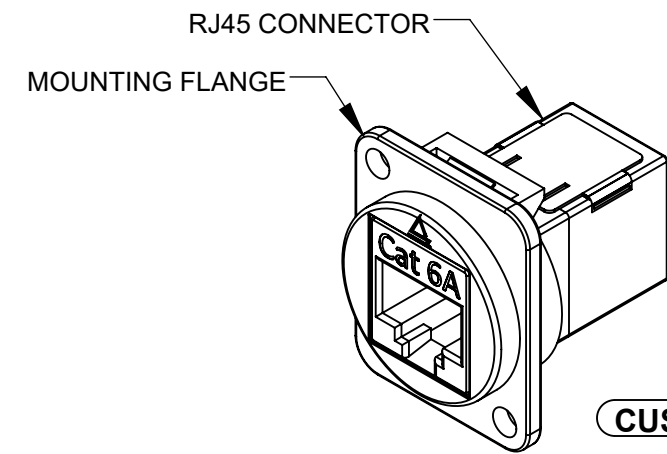

CUSTOMER DRAWING

					<div>UNLESS OTHERWISE SPECIFIED</div> <div>1. ALL DIMENSIONS IN INCHES [mm]</div> <div>- TWO PLACE DECIMALS ±0.02 [0.5]</div> <div>- THREE PLACE DECIMALS ±0.005 [0.13]</div>	THIS DRAWING DESCRIBES A DESIGN CONSIDERED PROPRIETARY IN NATURE, DEVELOPED AND MANUFACTURED BY SWITCHCRAFT INC. AND IS RELEASED ON A CONFIDENTIAL BASIS FOR IDENTIFICATION PURPOSES ONLY.														
						SIZE	WIDTH		MULT		LBS/M		TEMPER							
						FINISH SPEC No.					MATERIAL SPEC No.									
						FIRST USED ON				SCALE 2:1		<div>Switchcraft®</div>								
						DATE DRAWN	BY	CHKD		APVD										
A	28221	10/31/19	PC	TJK		6/21/19	JGK	JGK 7/10/19		TJK 7/10/19		SHEET 1 OF 1								
REV	ECO NUMBER	DATE	BY	APVD		NAME					PART No.					REV				
REVISIONS					DO NOT SCALE DRAWING					METAL FLANGE, REAR MOUNT RJ45, CAT6A CONNECTOR. SHIELDED, RoHS					EHRJ45D6AS SERIES					A

Mouser Electronics

Authorized Distributor

Click to View Pricing, Inventory, Delivery & Lifecycle Information:

[Switchcraft:](#)

[EHRJ45D6ASB](#) [EHRJ45D6AS](#) [EHRJ45D6ASBM3](#) [EHRJ45D6ASM3](#) [EHRJ45D6ASB440](#) [EHRJ45D6AS440](#)