

PART NUMBER	INSERT COLOR & WIRING	HOUSING FINISH
EHW800X2	RED - CROSS WIRED	NICKEL
EHW800X2B	RED - CROSS WIRED	BLACK CHROME

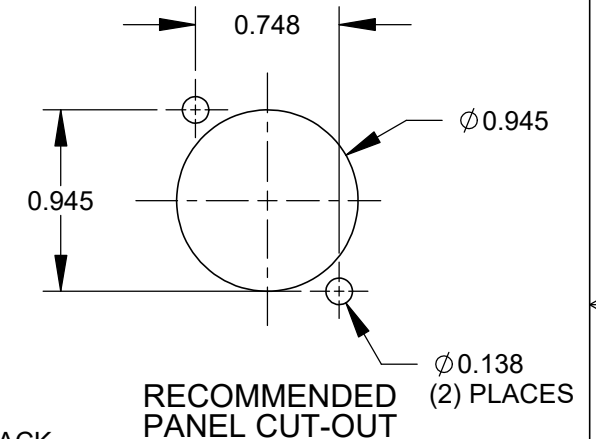
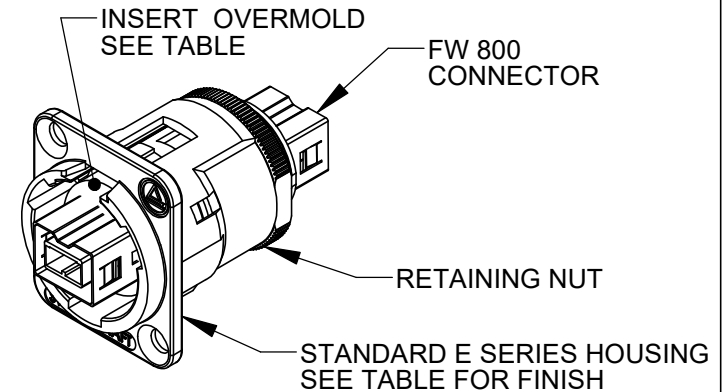
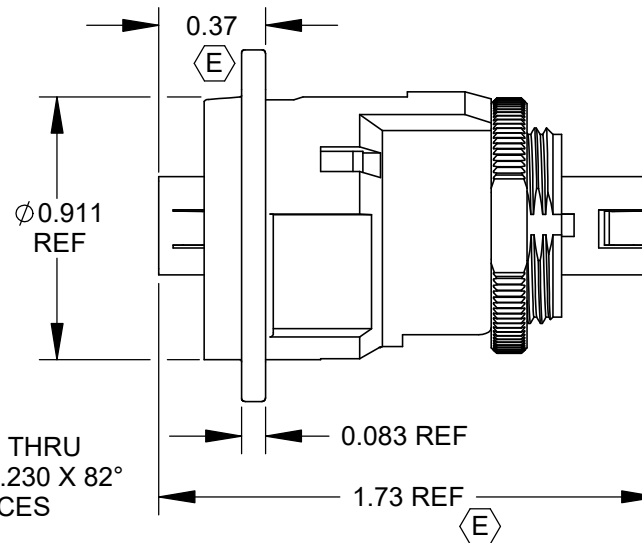
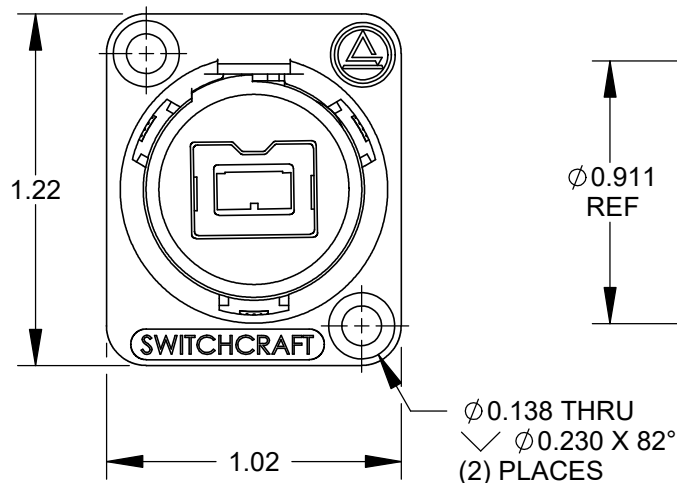

NOTES:

1. MATERIALS:
INSERT OVERMOLD - THERMOPLASTIC, BLACK
RETAINING NUT - BRASS, NICKEL PLATED
HOUSING - ZINC ALLOY
2. THERE IS NO CONNECTION BETWEEN PINS 7 AND 7.
3. THIS PRODUCT IS RoHS COMPLIANT.

CUSTOMER DRAWING

PIN ASSIGNMENT										
EHFW800X2 & EHW800X2B CROSS WIRED										
1	2	3	4	5	6	7	8	9	SHIELD	
						NC				
3	4	1	2	9	6	7	8	5	SHIELD	



					<div>UNLESS OTHERWISE SPECIFIED</div> <div>1. ALL DIMENSIONS IN INCHES</div> <div>- TWO PLACE DECIMALS ±0.02</div> <div>- THREE PLACE DECIMALS ±0.005</div>	THIS DRAWING DESCRIBES A DESIGN CONSIDERED PROPRIETARY IN NATURE, DEVELOPED AND MANUFACTURED BY SWITCHCRAFT INC. AND IS RELEASED ON A CONFIDENTIAL BASIS FOR IDENTIFICATION PURPOSES ONLY.								
						SIZE	WIDTH		MULT	LBS/M	TEMPER			
E	28603	06/08/23	PC	TJK		FINISH					MATERIAL			
D	26611	09/08/10	JEB	TJK		SPEC No.					SPEC No.			
C	26467	11/30/09	RS	TJK		FIRST USED ON			SCALE 1.5:1		<div>Switchcraft®</div>			
B	26415	7/17/09	TJK	TJK		DATE DRAWN	BY	CHKD	APVD					
A	26308	12/1/08	RS	TJK		1/9/08	JGK	RS 5/1/09	TJK 5/1/09					
REV	ECO NUMBER	DATE	BY	APVD		NAME					PART No.	REV		
REVISIONS					DO NOT SCALE DRAWING					FIREWIRE 800 FEED-THRU SERIES		EHFW800 SERIES		E
										SHEET 1 OF 1				

DO NOT SCALE DRAWING

SolidWorks CAD File



Mouser Electronics

Authorized Distributor

Click to View Pricing, Inventory, Delivery & Lifecycle Information:

Switchcraft:

[EHFW800X2PKG](#) [EHFW800X2B](#) [EHFW800X2](#)