

Ø0.138 THRU  
 ✓ Ø0.230 X 82°  
 (2) PLACES  
 REF

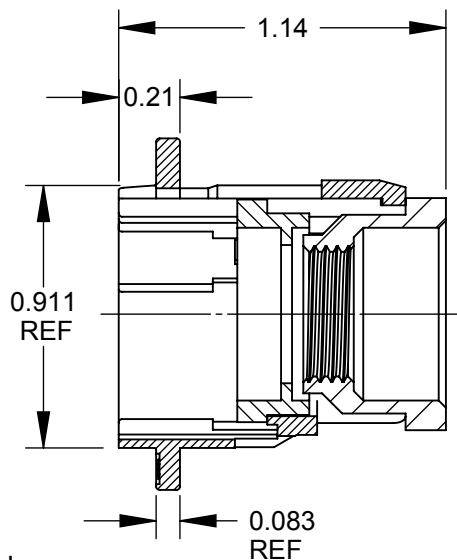

**SECTION A-A**

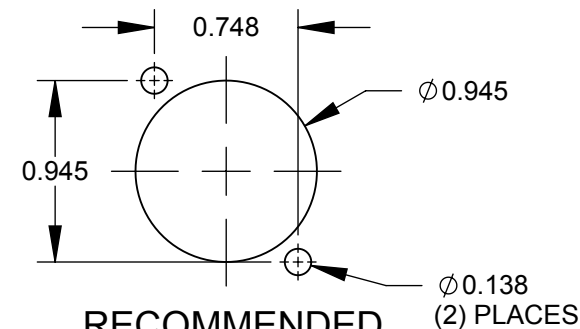
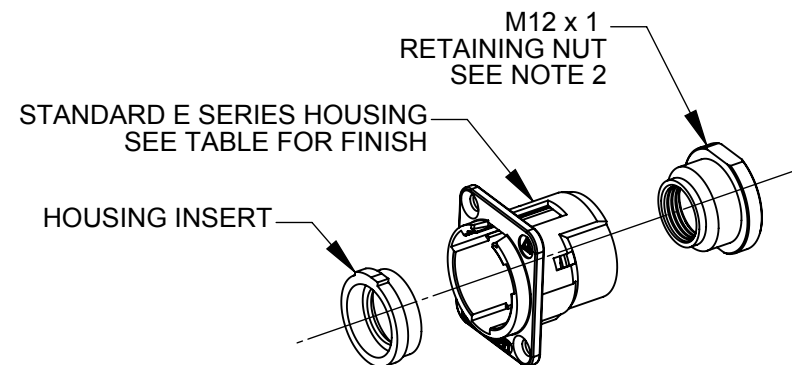

**RECOMMENDED  
 PANEL CUT-OUT**

**NOTES:**

1. USED WITH BPJJ SERIES BULKHEAD RCA JACKS. SAME AS EHRCA2X WITHOUT JACKS.
2. MAX TORQUE: 240 OZ-IN.
3. ADD "PKG" SUFFIX TO INCLUDE MOUNTING SCREWS AND INDIVIDUAL PACKAGING.
4. MATERIALS:  
 HOUSING - ZINC ALLOY  
 HOUSING INSERT - THERMOPLASTIC, BLACK  
 RETAINING NUT - THERMOPLASTIC, BLACK
5. THIS PRODUCT IS RoHS COMPLIANT.

PART NUMBER	HOUSING FINISH
EH1	NICKEL
EHB1	BLACK CHROME

**CUSTOMER DRAWING**

					<div>UNLESS OTHERWISE SPECIFIED</div> <div>1. ALL DIMENSIONS IN INCHES</div> <div>- TWO PLACE DECIMALS     ±0.02</div> <div>- THREE PLACE DECIMALS   ±0.005</div>	THIS DRAWING DESCRIBES A DESIGN CONSIDERED PROPRIETARY IN NATURE, DEVELOPED AND MANUFACTURED BY SWITCHCRAFT INC. AND IS RELEASED ON A CONFIDENTIAL BASIS FOR IDENTIFICATION PURPOSES ONLY.										
						SIZE	WIDTH		MULT		LBS/M		TEMPER			
						FINISH						MATERIAL				
						SPEC No.						SPEC No.				
						FIRST USED ON				SCALE		<div>Switchcraft®</div>				
										1.5:1						
A	26411	7/10/09	RS	TJK	DO NOT SCALE DRAWING	DATE DRAWN	BY	CHKD		APVD		SHEET    1                      OF    1				
						6/25/09	RS	RS		TJK						
REV	ECO NUMBER	DATE	BY	APVD					6/25/09		7/10/09					
REVISIONS						NAME    E SERIES CONNECTOR RCA FEEDTHROUGH KIT w/o JACK, RoHS						PART No.    EH1-EHB1				REV    A

# Mouser Electronics

Authorized Distributor

Click to View Pricing, Inventory, Delivery & Lifecycle Information:

Switchcraft:

[EH1PKG](#) [EHB1PKG](#)