

PART NUMBER	PANEL ID NUMBER	PANEL THICKNESS
EAC405030	030	0.026 - 0.040 [0.66 - 1.02]
EAC405040	040	0.036 - 0.050 [0.91 - 1.27]
EAC405050	050	0.046 - 0.060 [1.17 - 1.52]
EAC405060	060	0.056 - 0.070 [1.42 - 1.78]

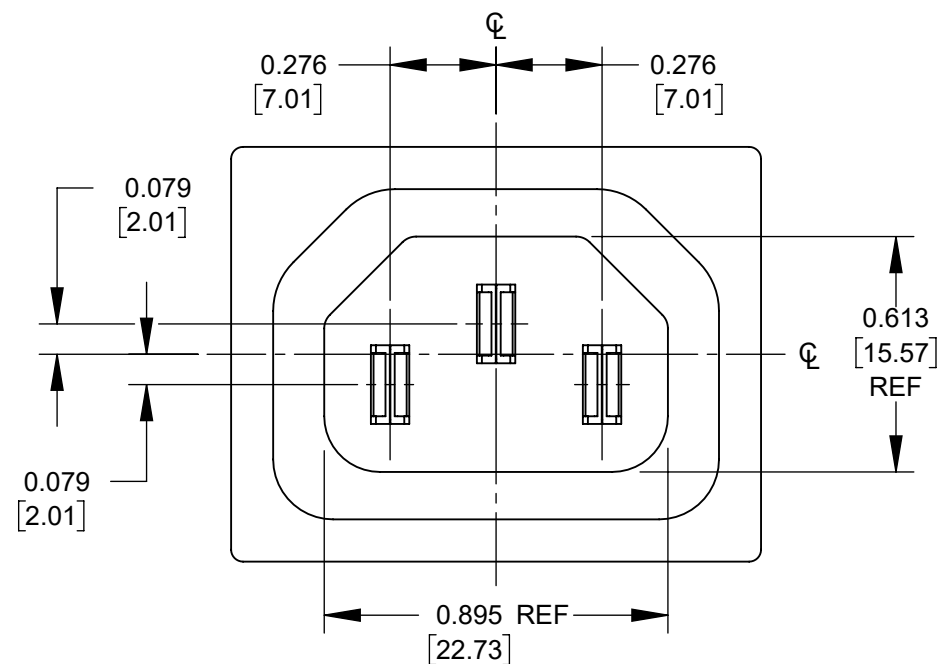

- NOTES:
1. MEETS IEC 60320 SPECIFICATION
  2. AGENCY APPROVAL & RATING:  
UL & CSA:15A, 250V~ AC.
  3. MATERIALS:  
HOUSING, BLACK POLYESTER  
COVER, BLACK POLYESTER  
CONTACTS, TIN PLATED COPPER ALLOY

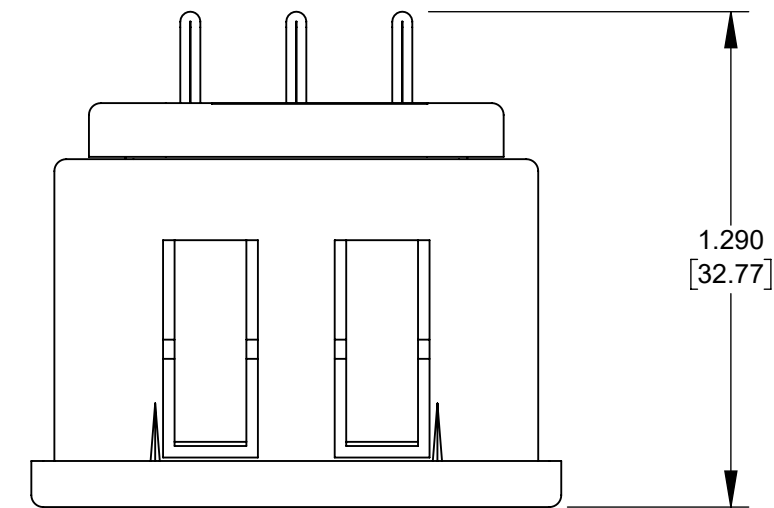
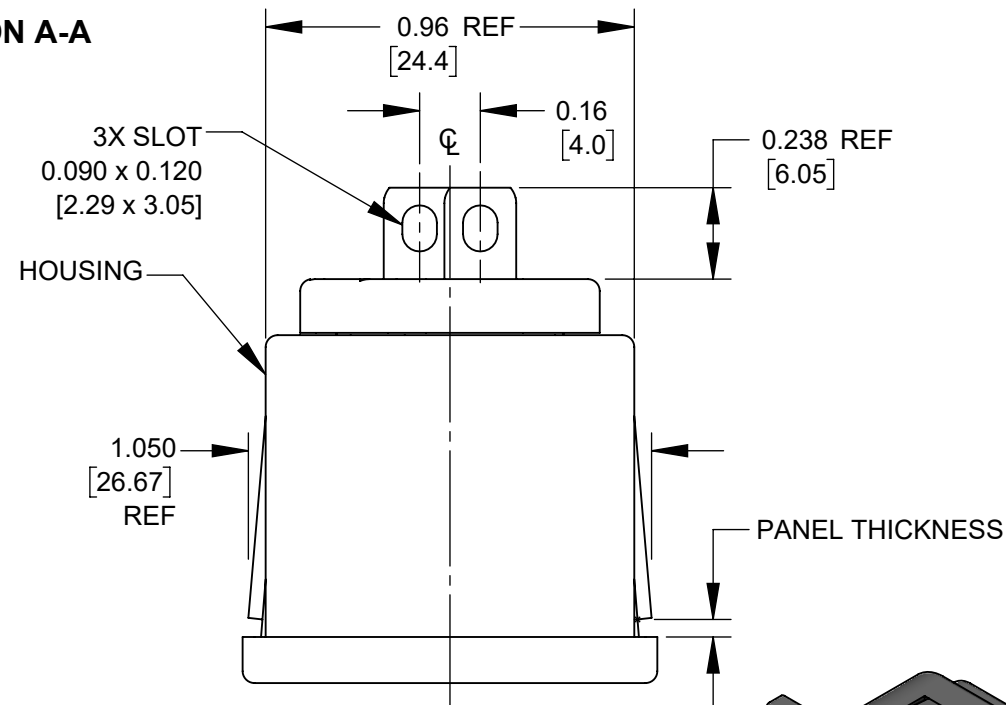
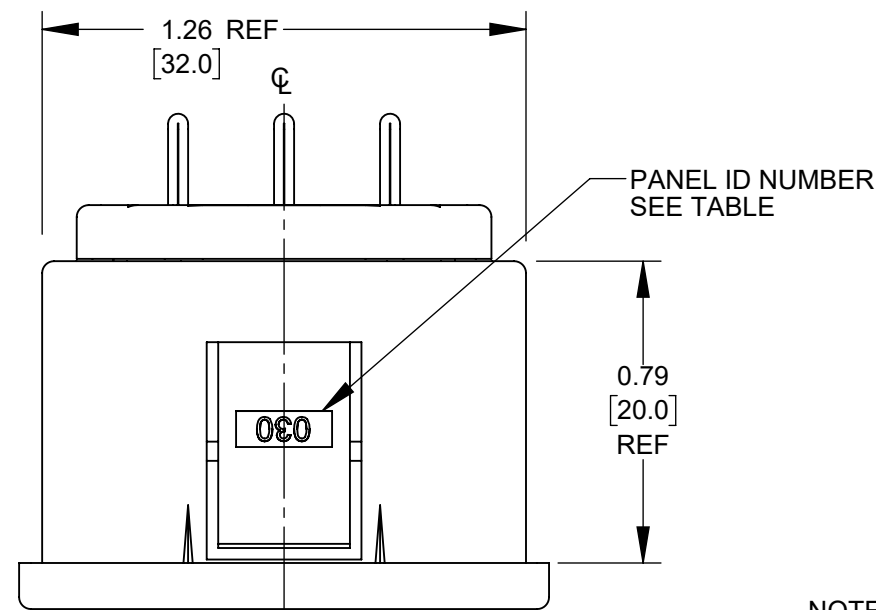
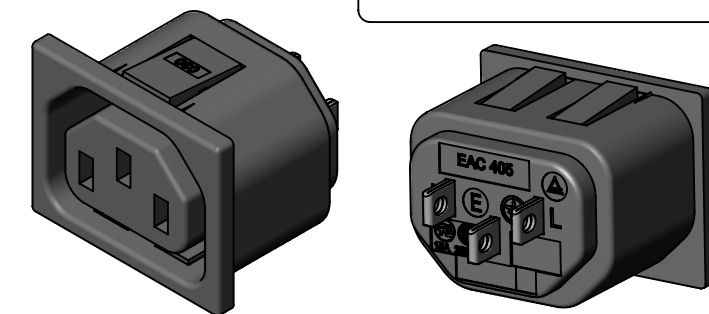

CUSTOMER DRAWING

					<div>UNLESS OTHERWISE SPECIFIED</div> <div>1. ALL DIMENSIONS IN INCHES [mm]</div> <div>- TWO PLACE DECIMALS ±0.02 [0.5]</div> <div>- THREE PLACE DECIMALS ±0.005 [0.13]</div>	THIS DRAWING DESCRIBES A DESIGN CONSIDERED PROPRIETARY IN NATURE, DEVELOPED AND MANUFACTURED BY SWITCHCRAFT INC. AND IS RELEASED ON A CONFIDENTIAL BASIS FOR IDENTIFICATION PURPOSES ONLY.											
						SIZE	WIDTH		MULT	LBS/M	TEMPER						
						FINISH SPEC No.				MATERIAL SPEC No.							
J	28549	01/16/23	PC	TJK		FIRST USED ON				SCALE 2:1							
H	28175	6/4/19	TJK	TJK		DATE DRAWN 11/03/86				BY LH		CHKD AM 11/17/86		APVD RP 05/06/87		<div>Switchcraft®</div> <div>SHEET 1 OF 1</div>	
G	26912	02/16/12	BL	TJK													
F	25129	03/27/02	BL	TJK													
REV	ECO NUMBER	DATE	BY	APVD													
REVISIONS																	

# Mouser Electronics

Authorized Distributor

Click to View Pricing, Inventory, Delivery & Lifecycle Information:

Switchcraft:

[EAC405060](#) [EAC405040](#)