

982A01RX

1 "A" CIRCUIT

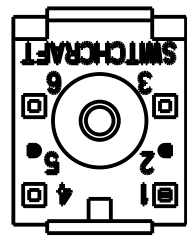

982A02RX

1 "B" CIRCUIT

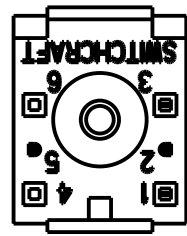

982A03RX

1 "C" CIRCUIT

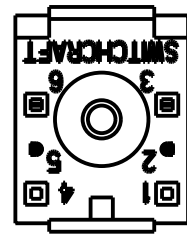

982A04RX

2 "A" CIRCUITS

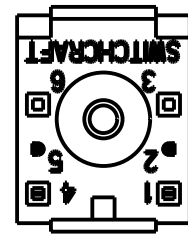

982A05RX

2 "B" CIRCUITS

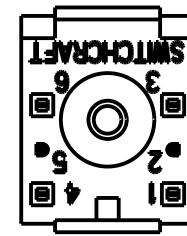

982A06RX

2 "C" CIRCUITS

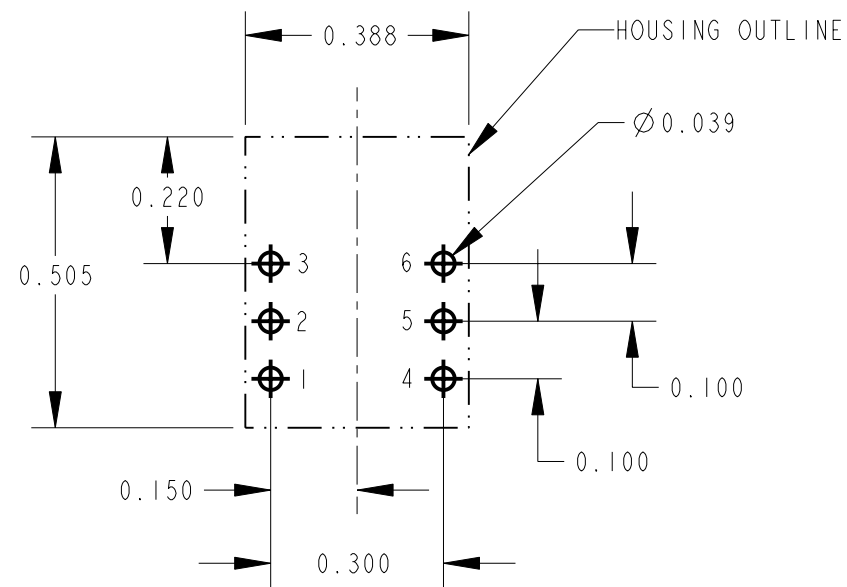
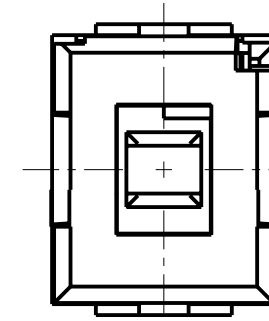

RECOMMENDED PC BOARD LAYOUT
SCALE 3:1

TERMINAL FUNCTION BY TERMINAL NUMBER						
CIRCUIT	FIRST POLE			SECOND POLE		
	N.O.	N.C.	COMMON	N.O.	N.C.	COMMON
1-A	3	-	2	-	-	5*
1-B	-	1	2	-	-	5*
1-C	3	1	2	-	-	5*
2-A	3	-	2	6	-	5
2-B	-	1	2	-	4	5
2-C	3	1	2	6	4	5

* PIN 5 IS USED AS A SUPPORT PIN FOR MOUNTING AND HAS NO ELECTRICAL CONNECTION.

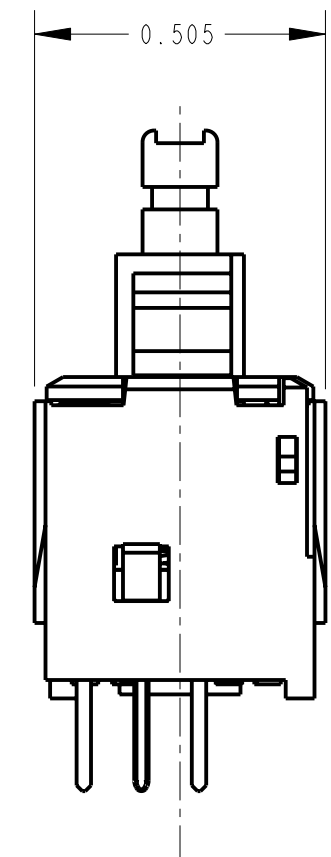
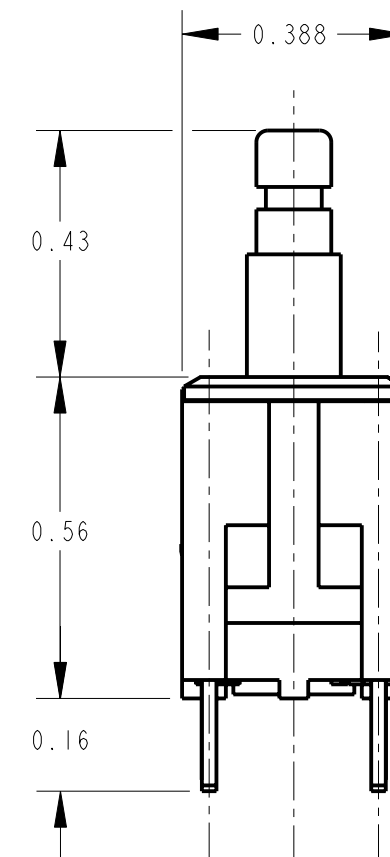

CUSTOMER DRAWING

NOTES:

1. ACTUATION FORCE:
MOMENTARY SWITCHES 12-15 OZ.,
2. PLUNGER TRAVEL: 0.14
3. CONTACT RESISTANCE 0.010 OHMS. MAXIMUM
WHEN SWITCH IS IN CLOSED POSITION.
4. ALL DIMENSIONS ARE FOR REFERENCE ONLY.
5. THESE PRODUCTS ARE RoHS COMPLIANT.

					★ STAR SYMBOL DENOTES CRITICAL DIMENSION	THIS DRAWING DESCRIBES A DESIGN CONSIDERED PROPRIETARY IN NATURE, DEVELOPED AND MANUFACTURED BY SWITCHCRAFT INC. AND IS RELEASED ON A CONFIDENTIAL BASIS FOR IDENTIFICATION PURPOSES ONLY.											
					UNLESS OTHERWISE SPECIFIED	SIZE		WIDTH		MULT		LBS/M		TEMPER			
					1. ALL DIMENSIONS IN INCHES - TWO PLACE DECIMALS ±0.01 - THREE PLACE DECIMALS ±0.005 - ANGLES ±1° - ALL DIA. CONCENTRIC WITHIN 0.005 T.I.R.	FINISH SPEC No.				MATERIAL SPEC No.							
					2. FEATURES ON THE SAME CENTERLINE MUST BE ALIGNED WITHIN ±0.002	FIRST USED ON			SCALE 3:1			<div>Switchcraft®</div>					
B	25464	9-29-06	TJK	TJK	3. REMOVE ALL BURRS	DATE DRAWN	BY	CHKD	APVD		SHEET OF						
A	26090	7-22-06	TJK	TJK		25-Feb-10	TJK	TJK 2-25-10	TJK 2-25-10								
REV	ECO NUMBER	DATE	BY	APVD		NAME				PART No.				REV			
REVISIONS					DO NOT SCALE DRAWING	MOMENTARY IBS SWITCH SHORT TERMINALS. RoHS				982A0_RX SERIES				B			

Mouser Electronics

Authorized Distributor

Click to View Pricing, Inventory, Delivery & Lifecycle Information:

Switchcraft:

[987A03RX](#) [987A06RX](#)