

1. ALL DIMENSIONS REFERENCE UNLESS OTHERWISE SPECIFIED.
2. MATERIALS:
 - HOUSING - STEEL, ZINC PLATED
 - BUTTON - THERMOPLASTIC, BLACK
 - SPRING - MUSIC WIRE
 - TERMINALS & CONTACT SLIDER - BRASS, SILVER PLATED
 - TERMINAL BOARD - PHENOLIC
3. SWITCH RATING:
 - 3 AMP, 125 V.A.C., 0.5 AMP, 125 V.D.C.
4. THIS PRODUCT IS RoHS COMPLIANT.

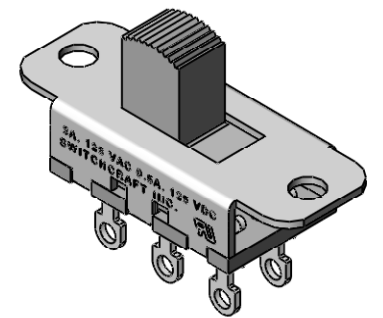
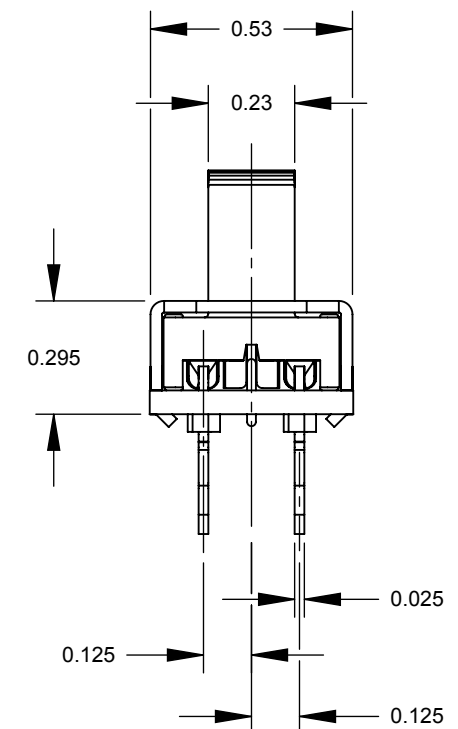

46206MRX SHOWN

CUSTOMER DRAWING

					<div>UNLESS OTHERWISE SPECIFIED</div> <div>1. ALL DIMENSIONS IN INCHES</div> <div>- TWO PLACE DECIMALS ±0.02</div> <div>- THREE PLACE DECIMALS ±0.005</div>	THIS DRAWING DESCRIBES A DESIGN CONSIDERED PROPRIETARY IN NATURE, DEVELOPED AND MANUFACTURED BY SWITCHCRAFT INC. AND IS RELEASED ON A CONFIDENTIAL BASIS FOR IDENTIFICATION PURPOSES ONLY.									
						SIZE	WIDTH		MULT		LBS/M		TEMPER		
						FINISH SPEC No.						MATERIAL SPEC No.			
						FIRST USED ON				SCALE 2:1		<div>Switchcraft®</div>			
						DATE DRAWN	BY	CHKD		APVD					
A	26224	2/6/07	RS	TJK		7/7/09	RS	RS 7/7/09		TJK 3/8/11					
REV	ECO NUMBER	DATE	BY	APVD	NAME 46200MRX SERIES MOMENTARY SLIDE SWITCH, RoHS						PART No. 46200MRX SERIES				REV A
REVISIONS					DO NOT SCALE DRAWING										

SolidWorks CAD File 

Mouser Electronics

Authorized Distributor

Click to View Pricing, Inventory, Delivery & Lifecycle Information:

[Switchcraft:](#)

[46206MRX](#)