

46202LRX

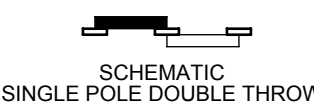

46203LRX

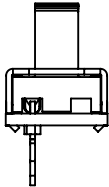
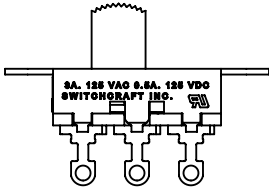
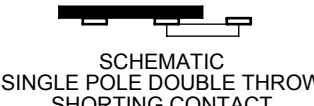
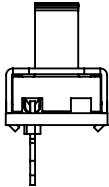
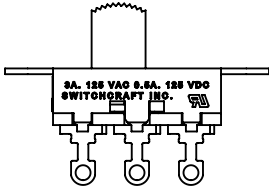

46203LSRX

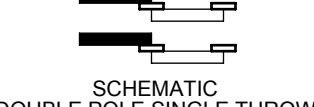
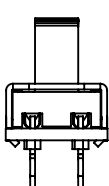
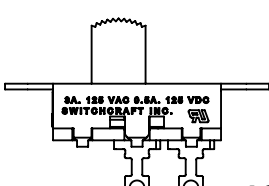

46204LRX

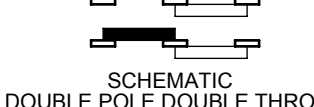
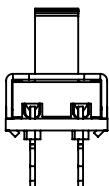
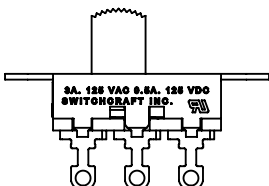

46206LRX

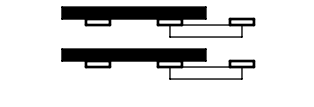
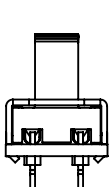
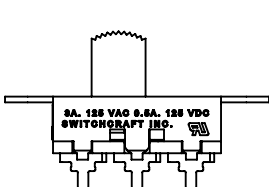

46206LSRX

- NOTES:
- ALL DIMENSIONS REFERENCE UNLESS OTHERWISE SPECIFIED.
  - MATERIALS:  
HOUSING - STEEL, ZINC PLATED  
BUTTON - THERMOPLASTIC, BLACK  
TERMINALS & CONTACT SLIDER - BRASS, SILVER PLATED  
TERMINAL BOARD - PHENOLIC
  - SWITCH RATING:  
3 AMP, 125 V.A.C., 0.5 AMP, 125 V.D.C.
  - THIS PRODUCT IS RoHS COMPLIANT.

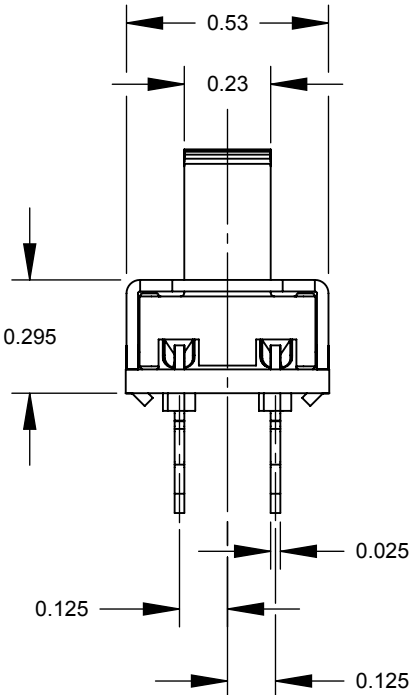
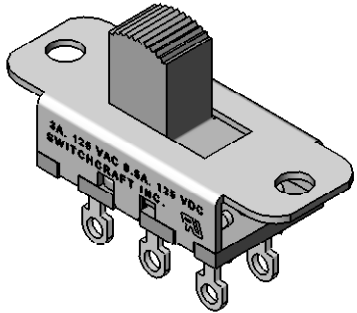
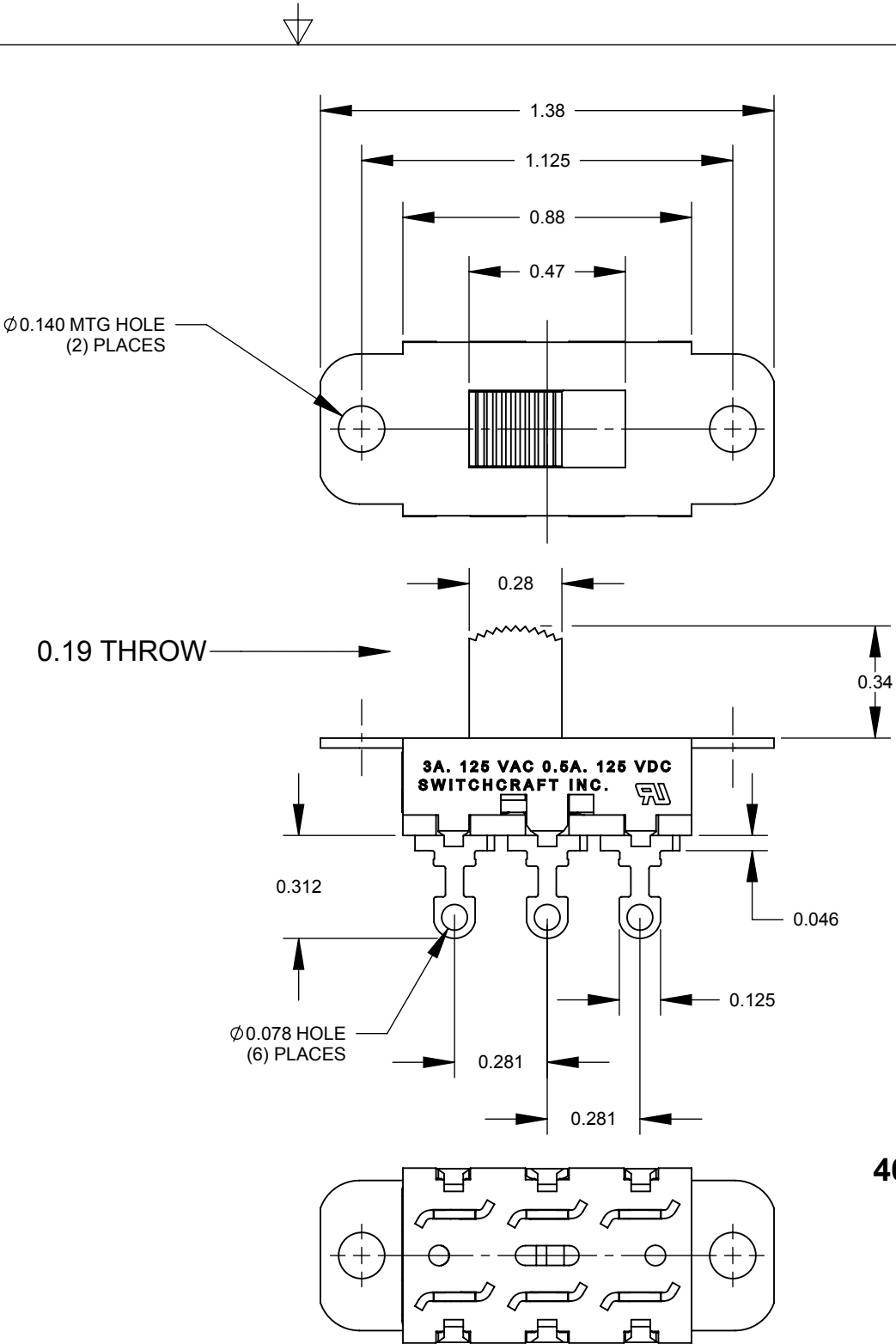

46206LRX SHOWN

CUSTOMER DRAWING

					<div>UNLESS OTHERWISE SPECIFIED</div> <div>1. ALL DIMENSIONS IN INCHES</div> <div>- TWO PLACE DECIMALS    ±0.02</div> <div>- THREE PLACE DECIMALS    ±0.005</div>	THIS DRAWING DESCRIBES A DESIGN CONSIDERED PROPRIETARY IN NATURE, DEVELOPED AND MANUFACTURED BY SWITCHCRAFT INC. AND IS RELEASED ON A CONFIDENTIAL BASIS FOR IDENTIFICATION PURPOSES ONLY.															
						SIZE	WIDTH		MULT		LBS/M		TEMPER								
						FINISH						MATERIAL									
						SPEC No.						SPEC No.									
						FIRST USED ON				SCALE		<div>Switchcraft®</div>									
								2:1													
A	26008	8/5/06	RS	TJK		DATE DRAWN	BY	CHKD		APVD		SHEET 1 OF 1									
					2/19/09	RS	RS		TJK												
											2/19/09		2/19/09								
REV	ECO NUMBER	DATE	BY	APVD	NAME						PART No.				REV						
REVISIONS					DO NOT SCALE DRAWING					46200LR SERIES						46200LRX SERIES				A	
										SLIDE SWITCH, RoHS											

# Mouser Electronics

Authorized Distributor

Click to View Pricing, Inventory, Delivery & Lifecycle Information:

[Switchcraft:](#)

[46202LRX](#) [46206LRX](#) [46203LRX](#)