

1. ELECTRICAL:
CONTACT RESISTANCE: 20 MILLIOHMS MAX. INITIAL
100 MILLIOHMS MAX. AFTER LIFE
INSULATION RESISTANCE: 100 MEGAOHMS MIN.
DIELECTRIC WITH STANDING VOLTAGE: 250 VAC.

2. MECHANICAL:
LIFE: 5000 CYCLES
INSERTION FORCE: 0,4 KG TO 1,6 KG
WITHDRAWAL FORCE: 0,4 KG TO 1,4 KG

3. MATERIALS:
HOUSING: PBT BLACK, UL94-V0
BUSHING: BRASS, NICKEL PLATED
SPRINGS: COPPER ALLOY, SILVER PLATED 
COVER: POLYCARBONATE, CLEAR, UL94-V0

4. MOUNTING NUT HARDWARE INCLUDED.

5. THIS PRODUCT IS RoHS COMPLIANT.

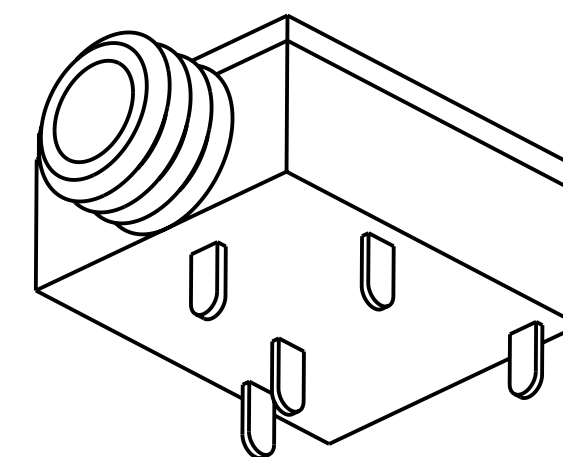
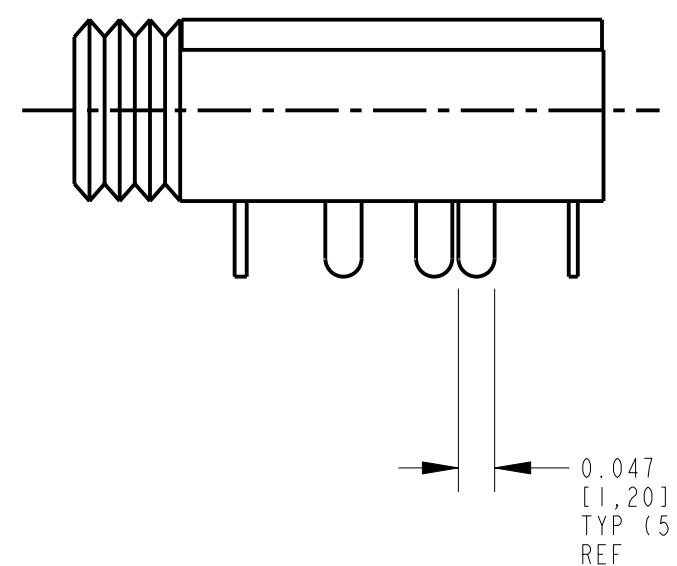
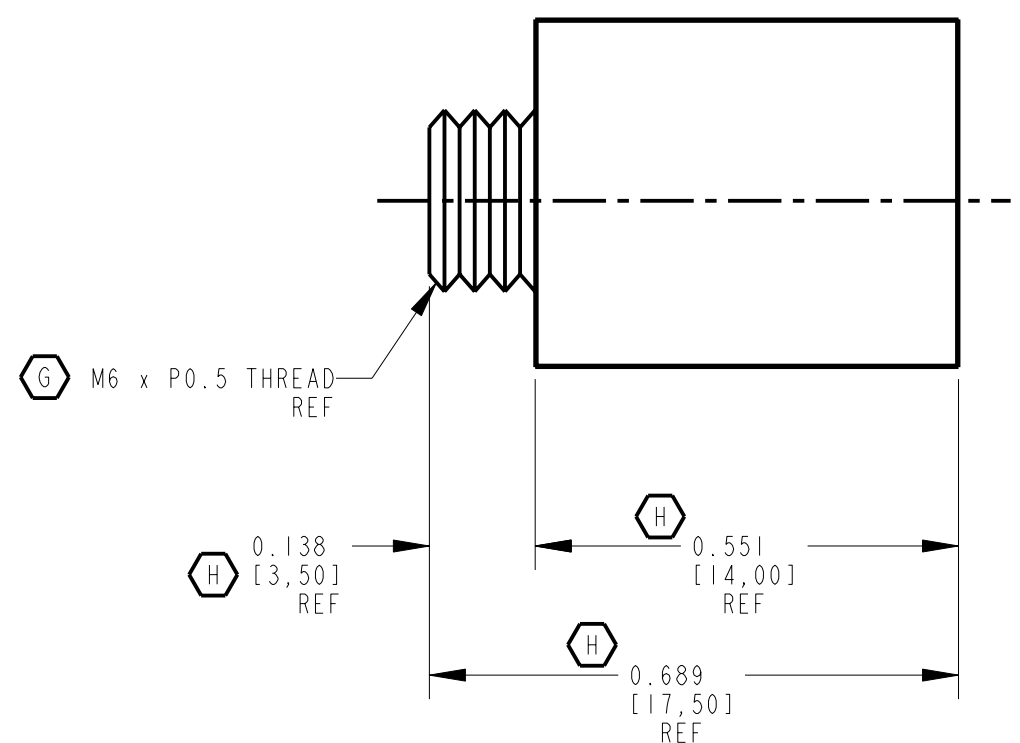
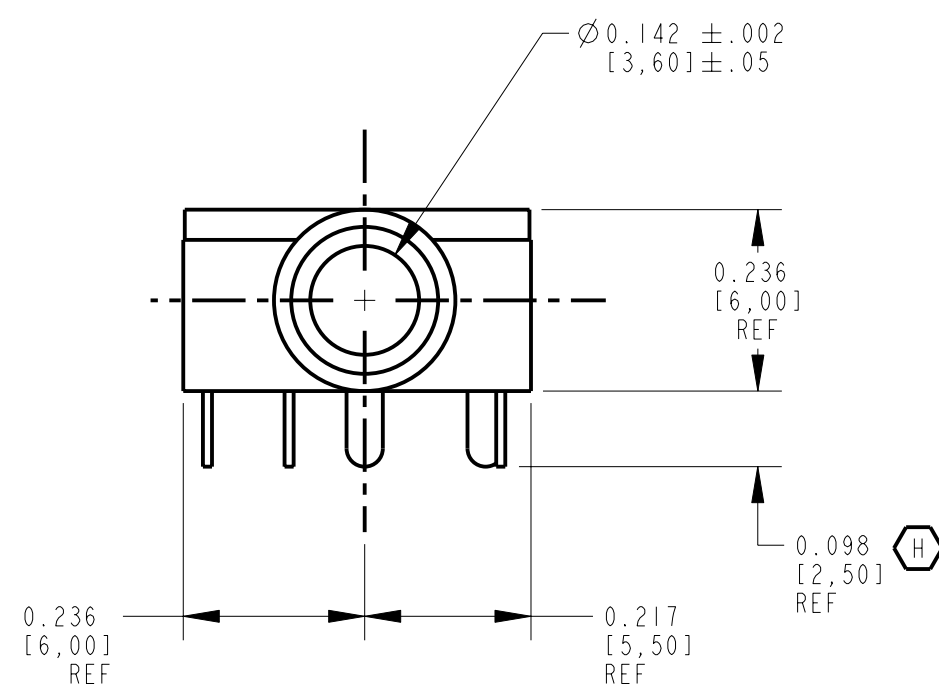

SCALE 4:1

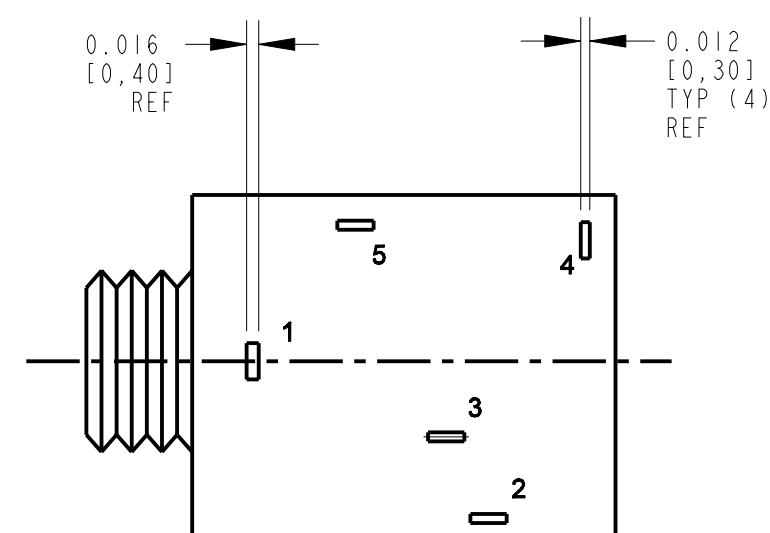
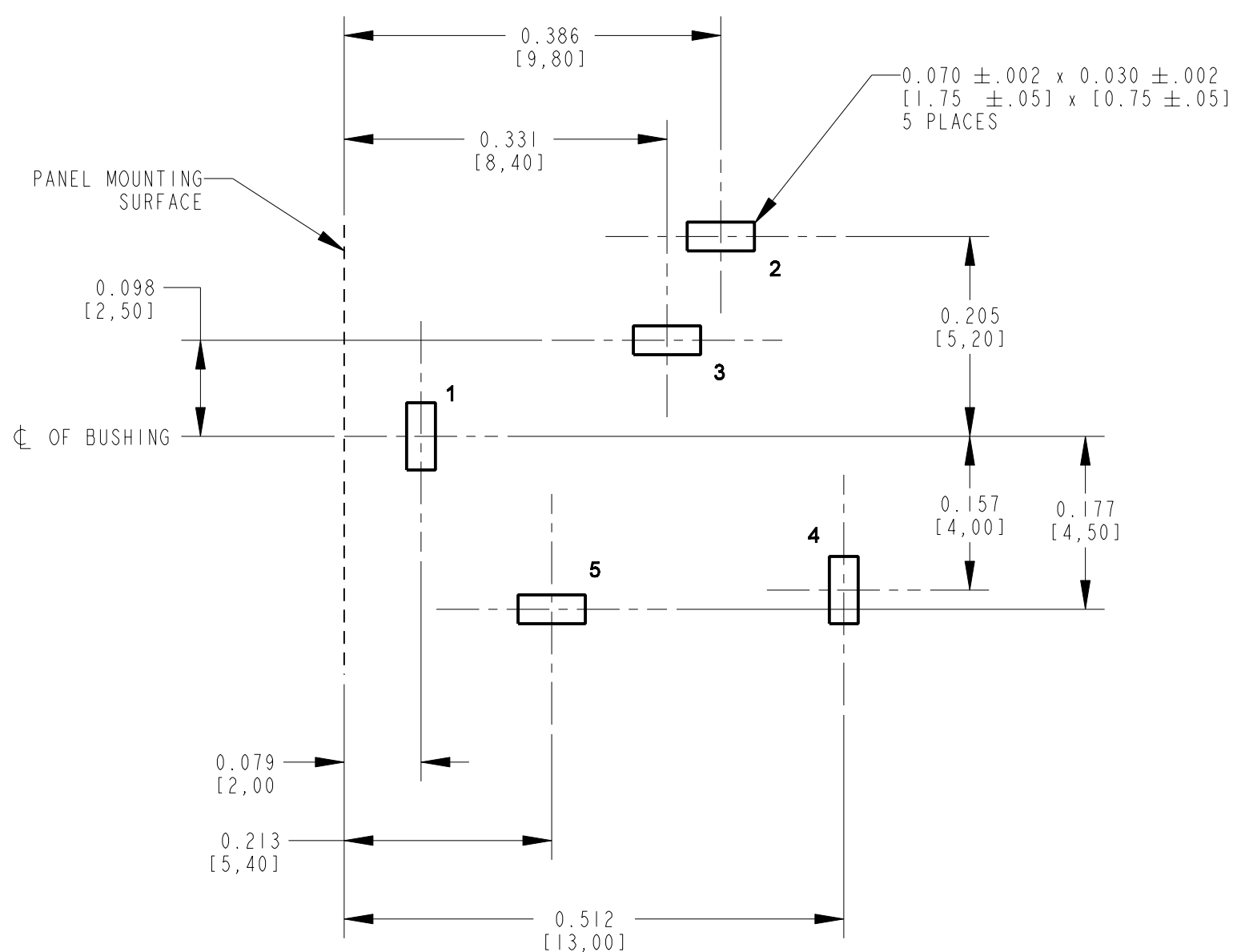
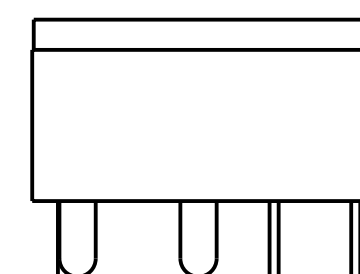

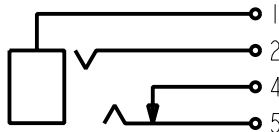
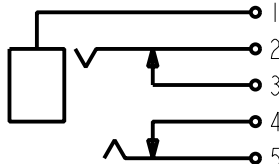
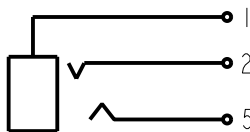
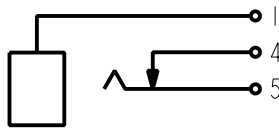
PART NO.	SCHEMATIC
35RAPC3BH3	
35RAPC4BH3	
35RAPC2BH3	
35RAPC2AH3	

(CUSTOMER DRAWING)

						★ STAR SYMBOL DENOTES CRITICAL DIMENSION	THIS DRAWING DESCRIBES A DESIGN CONSIDERED PROPRIETARY IN NATURE, DEVELOPED AND MANUFACTURED BY SWITCHCRAFT INC. AND IS RELEASED ON A CONFIDENTIAL BASIS FOR IDENTIFICATION PURPOSES ONLY					
						UNLESS OTHERWISE SPECIFIED	SIZE	WIDTH	MULT	LBS/M	TEMPER	
J	27551	8-4-15	TO	TJK	1. ALL DIMENSIONS IN INCHES - TWO PLACE DECIMALS ±0.01 - THREE PLACE DECIMALS ±0.005 - FRACTIONAL DIMENSIONS ±1/64 - ANGLES ±1° - ALL DIA. CONCENTRIC WITHIN 0.005 T.I.R.	FINISH	MATERIAL					
H	26998	7-20-12	TO	TJK		SPEC No.	SPEC No.					
G	26658	11-10-10	TO	TJK		FIRST USED ON	SCALE 4:1		Switchcraft			
F	26553	6-8-10	TJK	TJK		DATE DRAWN	BY	CHKD				APVD
E	21847	7-29-97	RC	JJ		9-Dec-93	ES	ES 12-10-93	EBR 12-10-93	SHEET OF		
REV	ECO NUMBER	DATE	BY	APVD	DO NOT SCALE DRAWING	NAME 3.5MM HORIZONTAL STEREO JACK, RoHS					PART No. 35RAPC H3	REV J

Pro/Engineer CAD File

ROUTING 146

Mouser Electronics

Authorized Distributor

Click to View Pricing, Inventory, Delivery & Lifecycle Information:

Switchcraft:

[35RAPC4BH3](#) [35RAPC2BH3](#) [35RAPC2AH3](#) [35RAPC3BH3](#)