

VIEW WITHOUT HANDLE AND INSULATOR

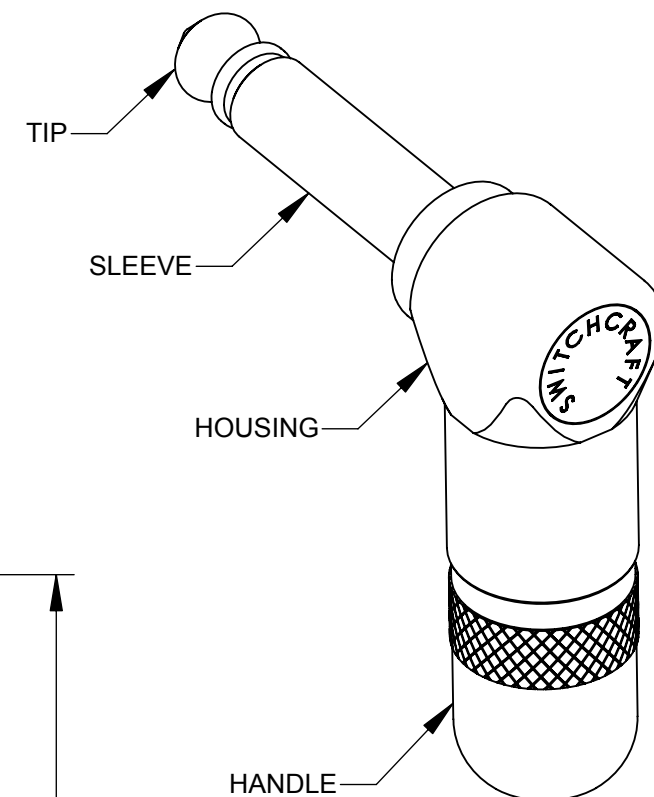
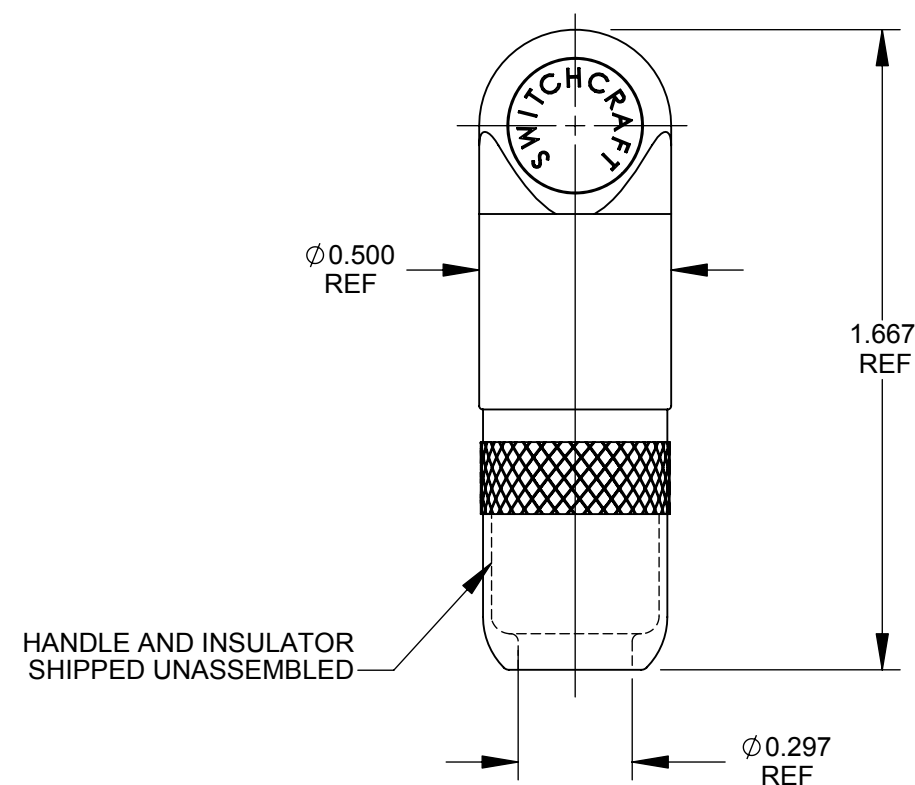

SPECIFICATIONS:

MATERIAL

- TIP ROD AND HANDLE - BRASS, NICKEL PLATED
- HOUSING AND SLEEVE - ZINC DIE CAST, COPPER AND NICKEL PLATED
- TIP TERMINAL - BRASS, TIN PLATED
- SLEEVE (CLAMP) TERMINAL - STEEL, TIN PLATED
- INSULATION - THERMOPLASTIC

ELECTRICAL

- DIELECTRIC WITHSTANDING VOLTAGE : 500 VAC
- INSULATION RESISTANCE: 50,000 MEGOHMS MINIMUM (INITIAL)

OPERATING TEMPERATURE

- 20°C TO +65°C

MATING JACK

- TYP, 1/4 INCH, COMMERCIAL TYPE, 2 CONDUCTOR PHONE JACK



THIS PRODUCT IS RoHS COMPLIANT

CUSTOMER DRAWING

					<div>UNLESS OTHERWISE SPECIFIED</div> <div>1. ALL DIMENSIONS IN INCHES</div> <div>- TWO PLACE DECIMALS ±0.02</div> <div>- THREE PLACE DECIMALS ±0.005</div>	THIS DRAWING DESCRIBES A DESIGN CONSIDERED PROPRIETARY IN NATURE, DEVELOPED AND MANUFACTURED BY SWITCHCRAFT INC. AND IS RELEASED ON A CONFIDENTIAL BASIS FOR IDENTIFICATION PURPOSES ONLY.				
						SIZE *	WIDTH *	MULT *	LBS/M *	TEMPER *
						FINISH SPEC No.				

Mouser Electronics

Authorized Distributor

Click to View Pricing, Inventory, Delivery & Lifecycle Information:

Switchcraft:

226 226PKG