

VIEW WITHOUT HANDLE AND INSULATOR

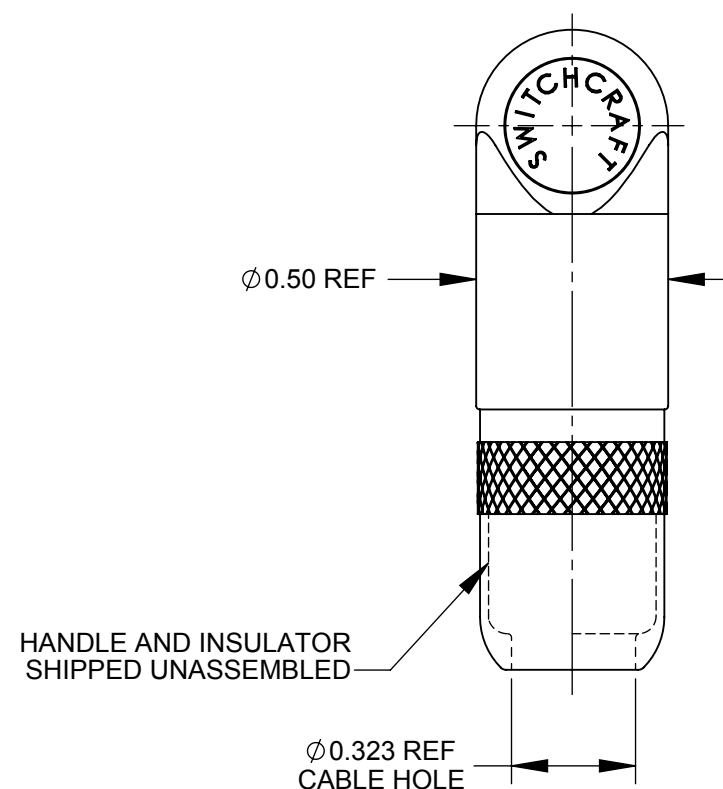

HANDLE AND INSULATOR  
SHIPPED UNASSEMBLED

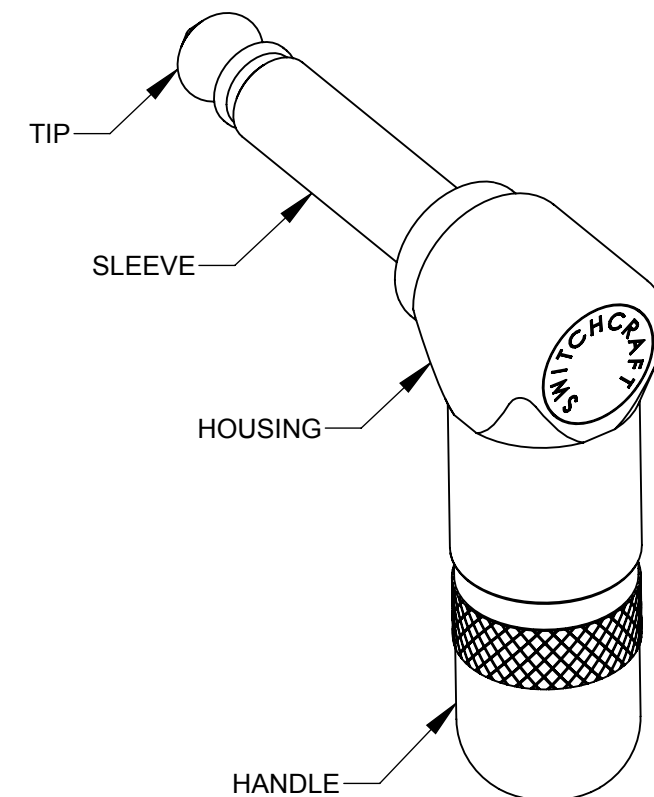

NOTES:

1. MATERIALS:
- TIP ROD AND HANDLE - BRASS, NICKEL PLATED
  - HOUSING AND SLEEVE - ZINC DIE CAST, COPPER AND NICKEL PLATED
  - TIP TERMINAL - BRASS, TIN PLATED
  - SLEEVE (CLAMP) TERMINAL - STEEL, TIN PLATED
  - INSULATION - THERMOPLASTIC

ELECTRICAL

- DIELECTRIC WITHSTANDING VOLTAGE : 500 VAC
- INSULATION RESISTANCE: 50,000 MEGOHMS MINIMUM (INITIAL)

OPERATING TEMPERATURE

- 20°C TO +65°C

MATING JACK

- TYP, 1/4 INCH, COMMERCIAL TYPE, 2 CONDUCTOR PHONE JACK

2. THIS PRODUCT IS RoHS COMPLIANT

CUSTOMER DRAWING

					<div>UNLESS OTHERWISE SPECIFIED</div> <div>1. ALL DIMENSIONS IN INCHES</div> <div>- TWO PLACE DECIMALS    ±0.02</div> <div>- THREE PLACE DECIMALS    ±0.005</div>	THIS DRAWING DESCRIBES A DESIGN CONSIDERED PROPRIETARY IN NATURE, DEVELOPED AND MANUFACTURED BY SWITCHCRAFT INC. AND IS RELEASED ON A CONFIDENTIAL BASIS FOR IDENTIFICATION PURPOSES ONLY.				
						SIZE	WIDTH	MULT	LBS/M	TEMPER
						*	*	*	*	*
						FINISH			MATERIAL	
						SPEC No.			SPEC No.	
						FIRST USED ON		SCALE		Switchcraft®
						*		2:1		
						DATE DRAWN	BY	CHKD	APVD	
A	REL TO PROD 25868	10-28-09	JEB	TJK		04-21-08	BDS	BDS	BDS	
								04-21-08	04-21-08	
REV	ECO NUMBER	DATE	BY	APVD	NAME				PART No.	REV
REVISIONS					DO NOT SCALE DRAWING				226L	A

# Mouser Electronics

Authorized Distributor

Click to View Pricing, Inventory, Delivery & Lifecycle Information:

[Switchcraft:](#)

[226L](#)