

TERMINATIONS SMA

UP TO **26.5 GHz**
1 WATT

api 
technologies corp.
> INMET

MODELS: TSXXXM, TSXXXMC, TSXXXF, TSXXXFC

SPECIFICATIONS:

Electrical:

Frequency Range _____ DC – 26.5 GHz
Standard Freq. Values _____ 6, 12.4, 18 & 26.5 GHz
VSWR

DC – 4 GHz _____ 1.05:1 Max.

4 – 8 GHz _____ 1.10:1 Max.

8 – 12.4 GHz _____ 1.15:1 Max.

12.4 – 18 GHz _____ 1.20:1 Max.

18 – 26.5 GHz _____ 1.35:1 Max.

Impedance _____ 50 Ohms

Input Power _____ 1 Watt Avg. @ +25°C
Derated Linearly to 0 Watts @ +125°C

Peak Power _____ 1kW Max.
(5uSec Pulse, .05% Duty Cycle)

Temperature Coefficient _____ ±250 ppm/°C

Operating Temp Range _____ -65°C to +125°C

Mechanical:

SMA Connectors _____ Passivated Stainless Steel**
Mates with MIL-STD-348

Conductors _____ Gold Plated Beryllium Copper

Bead Chain _____ Passivated Stainless Steel

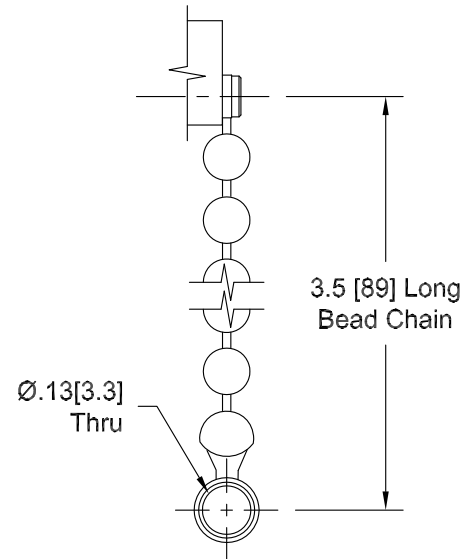

CHAIN DETAIL

** For Gold Plated Connectors add /AU to the Model Number

Model Number: **TSXXXM**
SMA Male Connector

Model Number: **TSXXXF**
SMA Female Connector

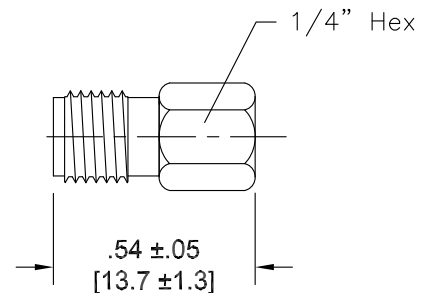
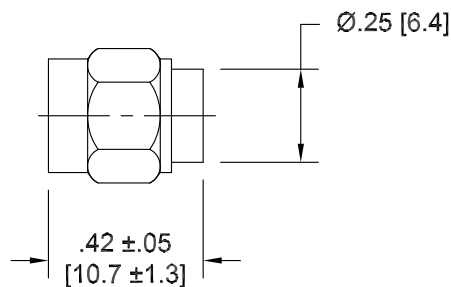

HOW TO ORDER:

Model Number: **TSXXXYZ/FF**

Frequency Range _____

060 = DC – 6 GHz
120 = DC – 12.4 GHz
180 = DC – 18 GHz
260 = DC – 26.5 GHz

Finish _____

/AU = Gold Plated Conn.
= Passivated Conn.

Style _____

C = Chain Included
= No Chain

Connector Config. _____

M = Male
F = Female

Ordering Examples:

Model Number: **TS180MC**

DC – 18 GHz; SMA Male; Chain Included

Model Number: **TS060F/AU**

DC – 6 GHz; SMA Female; No Chain; Gold Plate

Model Number: **TS260M**

DC – 26.5 GHz; SMA Male; No Chain

Note: Dimensions in Brackets are Expressed in Millimeters and are for Reference Only.

Design specifications are subject to change without notice.

Contact factory for technical specifications before purchasing or use.

TS260; REV J

300 Dino Drive • Ann Arbor, MI 48103-9457 U.S.A. • 888-244-6638 or 734-426-5553 • FAX 734-426-5557 • inmet.apitech.com

Mouser Electronics

Authorized Distributor

Click to View Pricing, Inventory, Delivery & Lifecycle Information:

[Spectrum Control:](#)

[TS180M](#)