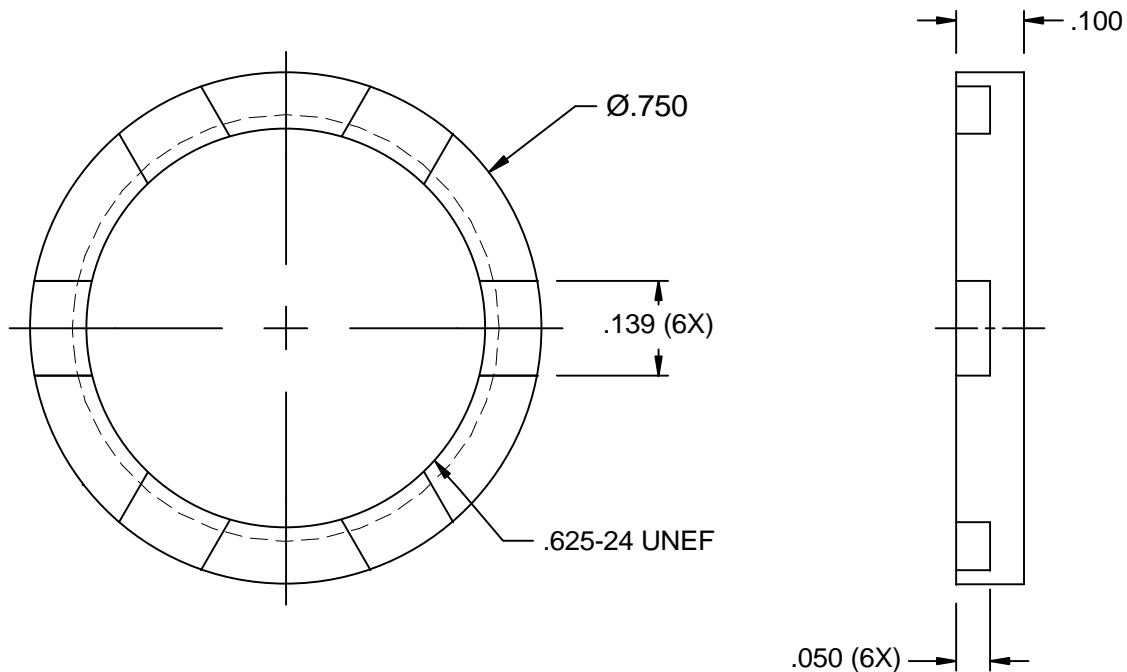

## NOTES:

- 1) DRAWINGS IN ACCORDANCE WITH STANDARD ANSI Y14.5M-1994.
- 2) UNTOLERANCED DIMENSIONS LOCATING TRUE POSITION ARE BASIC.
- 3) THIS DOCUMENT CONTAINS PROPRIETARY INFORMATION AND IS COPYRIGHTED. EXCEPT WITH THE WRITTEN PERMISSION OF SPECTRUM CONTROL, INC. OR ITS SUBSIDIARIES, SUCH INFORMATION SHALL NOT BE PUBLISHED OR DISCLOSED TO OTHERS, OR USED FOR ANY PURPOSE AND THIS DOCUMENT SHALL NOT BE DUPLICATED IN WHOLE OR IN PART.
- 4) MATERIALS: STAINLESS STEEL, PASSIVATED, SAND-BLASTED.
- 5) FINISH: NONE.
- 6) ALL STAINLESS MATERIAL SHALL BE IN ACCORDANCE WITH SAE AMS 5639, OR TYPE 304 CONDITION B, HARDENED IN ACCORDANCE WITH SAE AMS-QQ-S-763, OR TYPE 303 CONDITION A, COLD ROLLED ANNEALED IN ACCORDANCE WITH ASTM A582.

[illegible]

# Mouser Electronics

Authorized Distributor

Click to View Pricing, Inventory, Delivery & Lifecycle Information:

[Spectrum Control:](#)

[24-0010-2900](#)