

COUPE A-A  
ECHELLE 3/1

MATING FACE

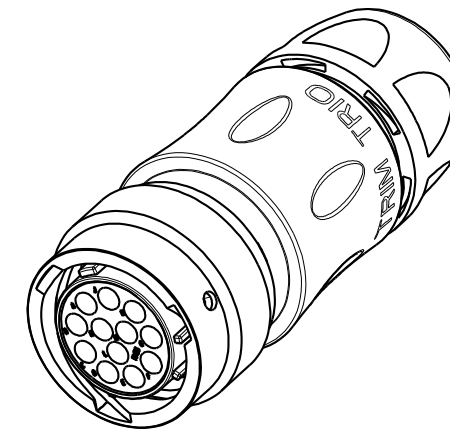
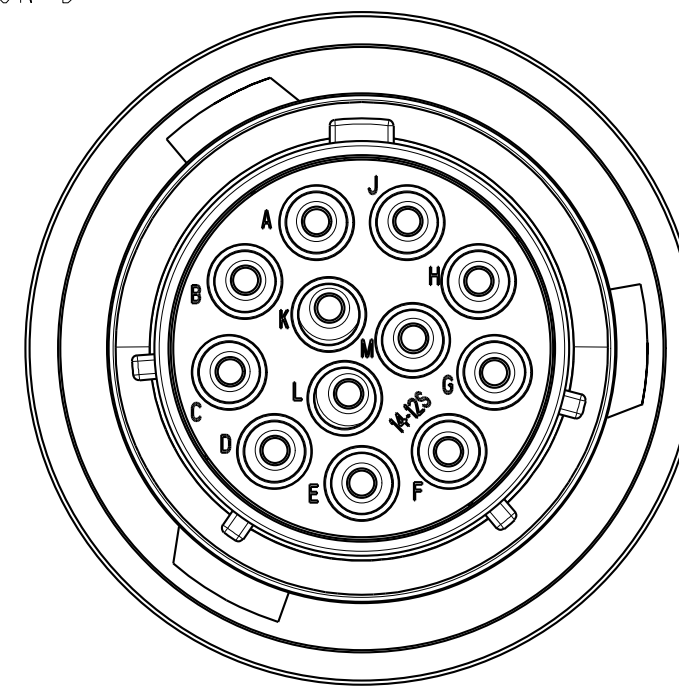

SHELL SIZE	LAYOUT	Ø A	B MINI	CAPACITY C		HEXAGON D	E MAX
				STANDARD	REDUCING SEAL		
14	SEE NOTE 4	29.75	70	7.00/14.00	5.00/12.00	26.00	36.70
12	SEE NOTE 4	25.50	65.5	5.00 / 12.00	3.00 / 9.00	24.00	32.70
10	SEE NOTE 4	22	62	2.50 / 8.00	1.50 / 5.00	18.50	29

## MATERIAL :

Coupling Nut:Aluminium alloy  
Inset:Polyamid UL94 V0  
Backshell body :Polyamid UL94 V-0  
Backshell nut:Polyamid UL94 V-0  
Shell : Aluminium alloy  
Coupling spring : Stainless steel  
O'seal : Nitril

## PERFORMANCE CHARACTERISTICS :

Operating temperature:-40°C up to 105°C  
Insulation resistance:5000 MΩmin  
Test potential:2000 Vrms for #16 layout and 1500Vrms for #20 layout  
Corrosion salt spray:500 hours  
Durability:250 matings and unmatings  
Sealing in mated conditions:  
-IP68 1 bar during 1 week : immersion under 10 m of water.  
(IEC 60529)  
-IP69K : exposure to high pressure water of cleaning  
equipment(DIN 40050)

## NOTES :

- 1-Plug,backshell and the reducing seal are delivered as a kit  
The backshell already includes the standard seal.
- 2-Contact to be ordered separately :refer to TRIM TRIO catalog
- 3-Colored ring to be order separately refer to customer drawing  
C006-UTSI-A
- 4-developed Grommet arrangements : refer to C042-UTSI-A

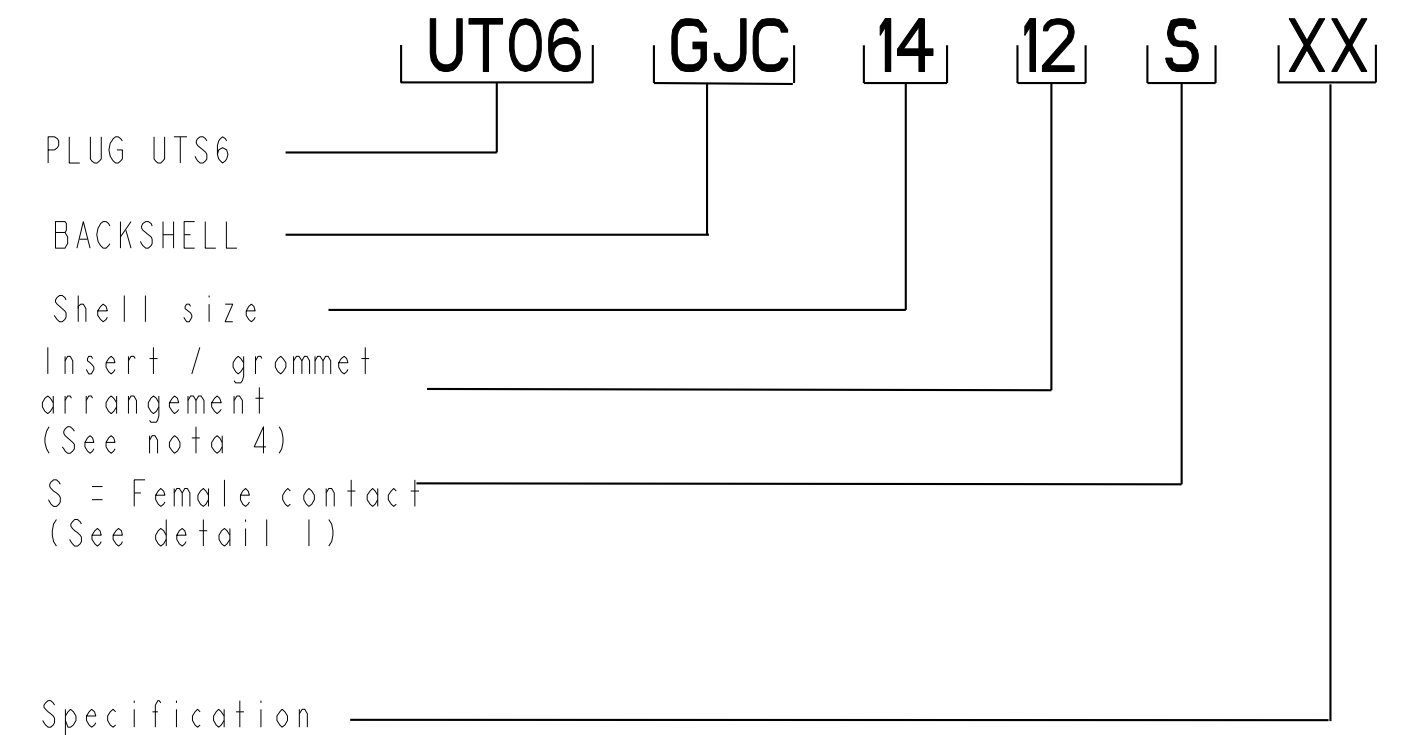

## FEMALE CONNECTOR

(detail 1)

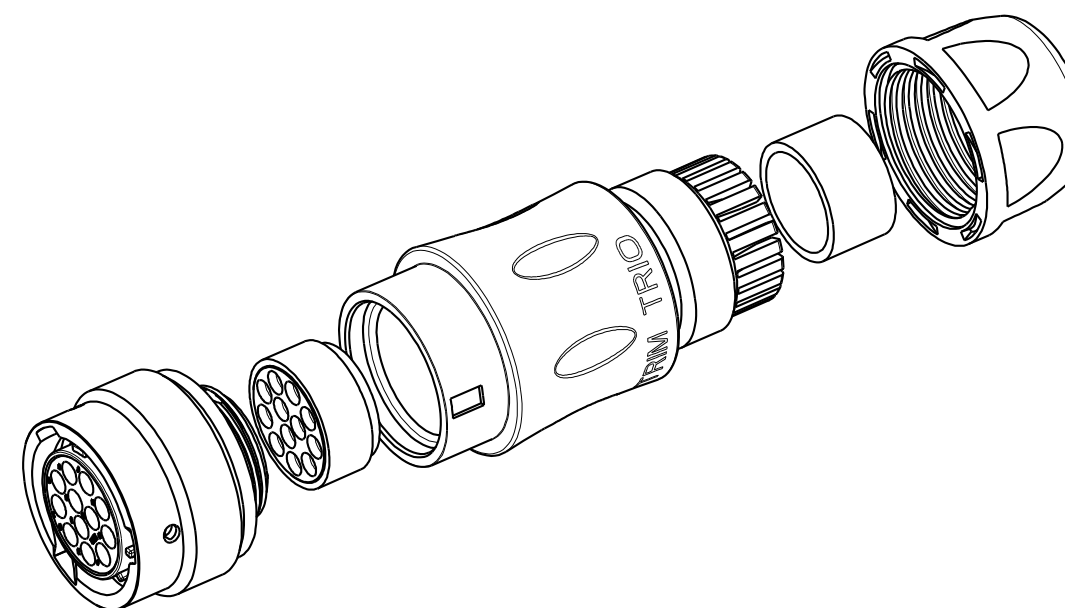
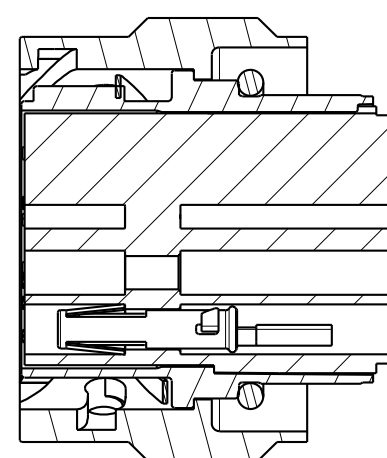

## CUSTOMER DRAWING

Q	07/02/08	--	Add shell size 12 and 14	--
ISS	DATE	Latest modification - by: RAGAINÉ M.		MOD N°
Designed by:		RAGAINÉ M. Date:07/06/07		CUSTOMER DRAWING
TITLE		CABLE PLUG + GROMMET BACKSHELL UTS CONNECTOR		
Scale	2/1		General linear Tolerances: ±0.1	NPRDS / PROJECT <b>UTSI</b>
		WWW.SOURIAU.COM		This document is the property of SOURIAU It must not be reproduced or communicated without permission
FORMAT	A2	SOURIAU DRG N° UT06GJCXXXXS-C		SHEET 1/1

NOT EXPORT CONTROLLED

# Mouser Electronics

Authorized Distributor

Click to View Pricing, Inventory, Delivery & Lifecycle Information:

Souriau:

UT06GJC147SH