

BVL

WIDE RANGE LEAD ACID CHARGERS



BVL WIDE RANGE LEAD ACID CHARGERS

- 100-250 VAC
- In Case IEC 320
- Automatic Fast/Float Function
- LED Indicators
- Charges Lead Acid Batteries
- Optimizes Battery Life
- Meets Safety Agency Requirements
- Complies with EMI-RFI Regulations
- Impact Resistant Polycarbonate Enclosure
- Private Label Marking Available
- 3 Year Warranty
- Modified and Custom Designs Also Available

BVL

Ault Part No.	Voltage DC	Output Amps	Fast Charge Volts DC	Float Charge Volts DC	Max Watts
BVL061000003K	6V	1.0	7.35	6.90	7.35
BVL062000003K	6V	2.0			14.70
BVL120600003K	12V	0.6	14.70	13.80	8.82
BVL121200003K	12V	1.2			17.64
BVL240300003K	24V	0.3	29.40	27.60	8.82
BVL240600003K	24V	0.6			17.64

Ault Part No. Key

BVL	06	100	00	03	K
Product Family Name	Voltage DC	Output Amps	Denotes standard or custom requirements	Connector	Manufacturing Location



AULT INCORPORATED

7105 Northland Terrace | Minneapolis, Minnesota 55428 | USATEL (1) 763-592-1900

FAX (1) 763-592-1911 | E-MAIL info@aultinc.com | WEB www.aultinc.com

© Copyright 2002 Ault Inc.

BVL

WIDE RANGE LEAD ACID CHARGERS

Input

Voltage	100-250 VAC -10%, +6%
Line Frequency	47 - 63 Hz
Current	0.5 (Lower current with higher voltage)
Protection	Internal primary current fuse Inrush limiting

Electrical

Topology	Switching - DC battery charger
Dielectric Withstand	3000 VAC, 4242 VDC primary- secondary 1500 VAC, 2121 VDC primary-ground 500 DC secondary-ground
EMI	Complies with EMC Directives
CE	CE Compliant
MTBF	100,000 calculated hours
MTBF	100,000 calculated hours
Protection	Foldback overcurrent. Short circuit protection

Safety Approvals

Agency Listings	CULus 60950; TUV EN60950
-----------------	--------------------------

Input Configuration



IEC320
w/ground
C14
(F)

Configuration: In Case IEC320 with ground

LED Indicators

Indicator #1 (Green)	On (unit energized) Off (unit de-energized)
Indicator #2 (Amber)	On (battery discharged) Off (battery charged)

Environmental

Operating Temperature	5° to 40° C with no derating
Storage Temperature	-30° to +85° C
Relative Humidity	5% to 95% non-condensing 0-10,000 feet
Altitude	0-10,000 feet
Cooling	Convectional - non vented case

Mechanical

Case and Dimensions	LP6 - Desktop 4.20 L x 2.60 W x 1.46 H (in) 107 L x 66 W x 37 H (mm)
Case Material	Black 94V0 polycarbonate
Weight	8 ounces, 210 grams (excluding cord)
Cords and Connectors	6 ft., 2 conductor, 18 AWG, Ault #3 connector. Other connectors are also available.

Connector

3

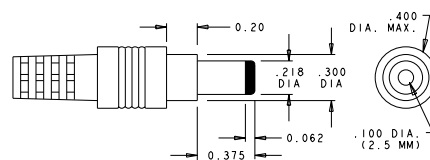

Pinout Code	Center contact: positive
Description	Switchcraft 760 plug or equivalent
Suggested Mating	Switchcraft 712A jack or equivalent
Other Connectors are available by special order	



AULT INCORPORATED

7105 Northland Terrace | Minneapolis, Minnesota 55428 | USATEL (1) 763-592-1900

FAX (1) 763-592-1911 | E-MAIL info@aultinc.com | WEB www.aultinc.com

© Copyright 2002 Ault Inc.

Mouser Electronics

Authorized Distributor

Click to View Pricing, Inventory, Delivery & Lifecycle Information:

SL Power:

[BVL061000003N](#) [BVL062000003N](#) [BVL120600003N](#) [BVL240600003N](#)