

Connection with Stranded Cable



See below:

Approvals and Compliances

Description

- Flexible wire :
- Push-mounted rear-side
- 1 Function Connection with stranded Cable
- Quick connect terminals 4.8 x 0.8 mm
- Approved together with power entry module

References

Fits to type: [CE](#); [CG](#); [CG-Bowdencable](#); [KE](#); [KG](#); [KG-Bowdencable](#)

Weblinks

[pdf data sheet](#), [html datasheet](#), [General Product Information](#), [Approvals](#), [Distributor-Stock-Check](#), [Accessories](#), [Detailed request for product](#)

Approvals and Compliances

Detailed information on product approvals, code requirements, usage instructions and detailed test conditions can be looked up in [Details about Approvals](#)

SCHURTER products are designed for use in industrial environments. They have approvals from independent testing bodies according to national and international standards. Products with specific characteristics and requirements such as required in the automotive sector according to IATF 16949, medical technology according to ISO 13485 or in the aerospace industry can be offered exclusively with customer-specific, individual agreements by SCHURTER.



Application standards

Application standards where the product can be used

Organization	Design	Standard	Description
	Suitable for applications acc.	IEC/UL 62368-1	Audio/video, information and communication technology equipment - Part 1: Safety requirements
	Suitable for applications acc.	IEC 60601-1	Medical electrical equipment - Part 1: General requirements for basic safety and essential performance

Compliances

The product complies with following Guide Lines

Identification	Details	Initiator	Description
	RoHS	SCHURTER AG	Directive RoHS 2011/65/EU, Amendment (EU) 2015/863
	REACH	SCHURTER AG	On 1 June 2007, Regulation (EC) No 1907/2006 on the Registration, Evaluation, Authorization and Restriction of Chemicals 1 (abbreviated as "REACH") entered into force.
	Medical Equipment	SCHURTER AG	Suitable for use in medical equipment according to IEC/UL 60601-1 (1 MOOP, 1 MOPP)

Dimension [mm]

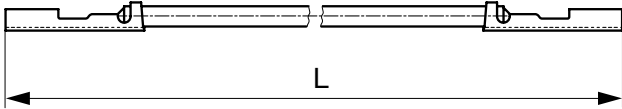
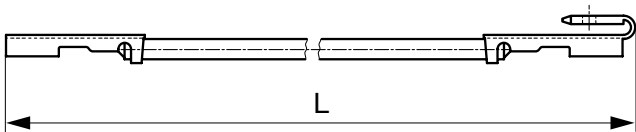

Type A, (Lenght see order table)

Type B (Length see order table)

All Variants

Type	L [mm]	System 1 Anzahl	System 2 Anzahl	System 3 Anzahl	System 4 Anzahl	Order Number
Type A	70 mm	1	1	1	-	0881.0074
Type A	100 mm	1	1	1	-	0881.0075
Type B	70 mm	1	-	-	1	0881.0076
Type B	100 mm	-	-	-	1	0881.0077

Availability for all products can be searched real-time: <https://www.schurter.com/en/info-center/support-tools/stock-check-distributors>

For 2-pole versions 2 x 0881.0074 is needed in system no. 2 and 3 resp. 2 x 0881.0076 in system no. 4

Packaging unit	100 Pcs
----------------	---------

Mouser Electronics

Authorized Distributor

Click to View Pricing, Inventory, Delivery & Lifecycle Information:

[Schurter:](#)

[0881.0074](#) [0881.0075](#) [0881.0076](#) [0881.0077](#)