

Product availability: Non-Stock - Not normally stocked in distribution facility

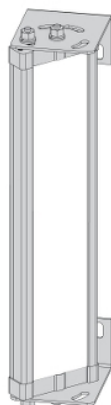

Main

Range of product	Preventa Safety detection
Accessory / separate part category	Adaptation accessories
Accessory / separate part type	90° mirror adaptor
Product compatibility	XUSL.E...76
Accessory / separate part destination	Safety light curtain type 2 Safety light curtain type 4
Material	Glass
Mirror height	34.84 in (885 mm)
Height protected	29.92 in (760 mm)

Complementary

Sensing distance reduction coefficient	0.85 Sn
Product weight	6.17 lb(US) (2.8 kg)

Ordering and shipping details

Category	22455 - LIGHT CURTAINS - XUSL
Discount Schedule	DS2
GTIN	003389119618793
Nbr. of units in pkg.	1
Package weight(Lbs)	0.01
Returnability	N
Country of origin	IT

Offer Sustainability

Sustainable offer status	Green Premium product
RoHS (date code: YYWW)	Compliant - since 1425 - Schneider Electric declaration of conformity Schneider Electric declaration of conformity
REACH	Reference not containing SVHC above the threshold
Product environmental profile	Available
Product end of life instructions	Available
California proposition 65	WARNING: This product can expose you to chemicals including:
- - - - - Substance 1	Diisononyl phthalate (DINP), which is known to the State of California to cause cancer, and
- - - - - Substance 2	Diisodecyl phthalate (DIDP), which is known to the State of California to cause birth defects or other reproductive harm.
- - - - - More information	For more information go to www.p65warnings.ca.gov

Dimensions

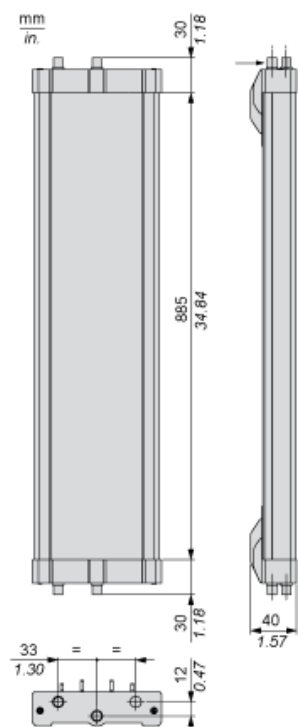

Mouser Electronics

Authorized Distributor

Click to View Pricing, Inventory, Delivery & Lifecycle Information:

[Schneider Electric:](#)

[XUSZMD076](#)