

Product availability: Stock - Normally stocked in distribution facility



Main

Range of product	Harmony XVC1
Accessory / separate part designation	Metal fixing bracket
Accessory / separate part type	Fixing bracket
Accessory / separate part category	Mounting and fixing accessories
Accessory / separate part destination	Complete pre-wired monolithic tower light
Product specific application	For mounting on vertical support

Complementary

Product weight	0.84 lb(US) (0.38 kg)
----------------	-----------------------

Ordering and shipping details

Category	22617 - XVC TOWER LIGHTS
Discount Schedule	XV
GTIN	00785901811114
Nbr. of units in pkg.	1
Package weight(Lbs)	0.8499999999999998
Returnability	Y
Country of origin	JP

Offer Sustainability

Sustainable offer status	Green Premium product
RoHS (date code: YYWW)	Compliant - since 0808 - Schneider Electric declaration of conformity Schneider Electric declaration of conformity
REACH	Reference not containing SVHC above the threshold
Product environmental profile	Available
Product end of life instructions	Need no specific recycling operations
California proposition 65	WARNING: This product can expose you to chemicals including:
- - - - - Substance 1	Nickel compounds, which is known to the State of California to cause cancer, and
- - - - - Substance 2	Di-isodecyl phthalate (DIDP), which is known to the State of California to cause birth defects or other reproductive harm.
- - - - - More information	For more information go to www.p65warnings.ca.gov

Contractual warranty

Warranty period	18 months
-----------------	-----------

Dimensions and Mounting

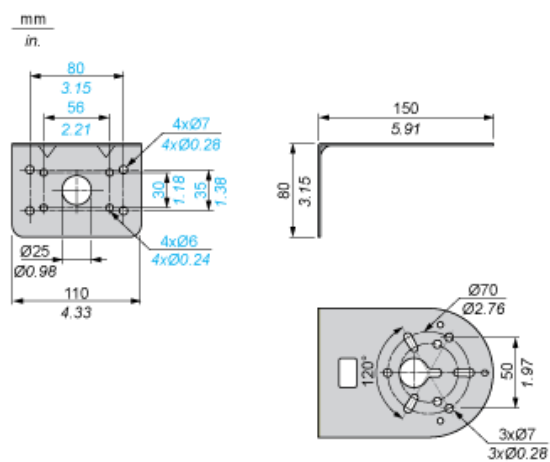

Mouser Electronics

Authorized Distributor

Click to View Pricing, Inventory, Delivery & Lifecycle Information:

[Schneider Electric:](#)

[XVCZ23](#)