

# SH Series Threaded Studs

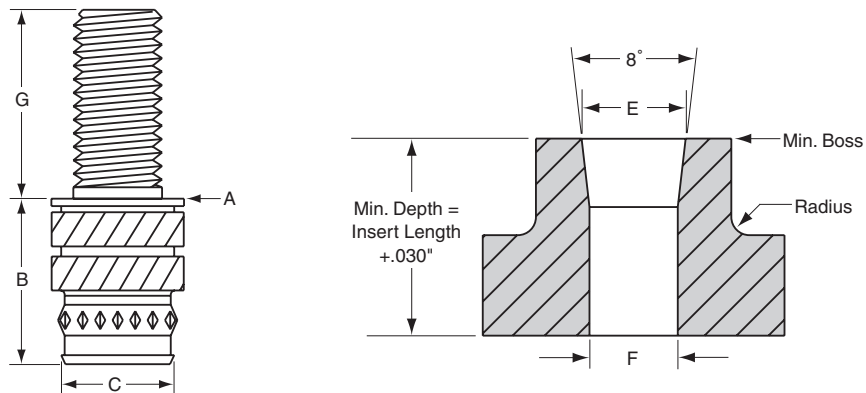

The body of this threaded stud is specifically modeled after our H Series Insert. Its key feature is the tapered design, which allows for easy insertion into tapered molded or drilled holes. They may be installed using the thermal or ultrasonic method or can be molded in place.

Recommended Hole Size – See chart for installation hole size.  
Additional information can be found on page 5, Design Guidelines.



INCH		METRIC		A	B	C	Hole E	Hole F	G	Min. Boss
Thread Size	Part Number	Thread Size	Part Number	±.004	±.004	±.004	+ .002 – .000	+ .002 – .000	±.010	
2-56	S256 x	M2.0 x 0.4	SM20 x	.141	.188	.112	.123	.107	S P E C I F Y *	.246
4-40	S440 x	M2.5 x 0.45	SM25 x	.172	.219	.146	.159	.141		.318
6-32	S632 x	M3.0 x 0.5	SM30 x	.219	.250	.190	.206	.185		.412
		M3.5 x 0.6	SM35 x	.219	.250	.190	.206	.185		.412
8-32	S832 x	M4.0 x 0.7	SM40 x	.250	.312	.213	.234	.208		.468
10-24	S1024 x	M5.0 x 0.8	SM50 x	.297	.375	.251	.277	.246		.554
10-32	S1032 x			.297	.375	.251	.277	.246		.554
1/4-20	S2520 x	M6.0 x 1.0	SM60 x	.375	.500	.332	.363	.321		.726
1/4-28	S2528 x			.375	.500	.332	.363	.321		.726
5/16-18	S3118 x	M8.0 x 1.25	SM80 x	.469	.562	.406	.448	.401		.896
5/16-24	S3124 x			.469	.562	.406	.448	.401		.896
3/8-16	S3816 x	M10 x 1.5	SM100 x	.563	.625	.493	.540	.488		1.080
3/8-24	S3824 x			.563	.625	.493	.540	.488		1.080

\* When ordering, customer needs to specify the "G" dimension to form the part number.  
Example: 8-32 with a thread length 1/2" (.500") = S832 x 500H

Part numbers for Stainless Steel Inserts are the same as listed in the chart, but ending with -SS.

# Mouser Electronics

Authorized Distributor

Click to View Pricing, Inventory, Delivery & Lifecycle Information:

## RAF Electronic Hardware:

[S1024X375C](#) [S1032X375C](#) [S2520X500C](#) [S2528X500C](#) [S256XC375C](#) [S832X375C](#) [S3118X625C](#) [S3124X625C](#)  
[S3816X750C](#) [S3824X750C](#) [S440X250C](#) [S632X375C](#)