

SMT Power Inductors

Unshielded Drum Core - PF0504NL Series



- Height:** 11.43 Max
- Footprint:** 18.54mm x 15.24mm Max
- Current Rating:** up to 20A
- Inductance Range:** 0.68μH to 150μH
- 260°C reflow peak temperature qualified
- Leaded technology compatible

Electrical Specifications @ 25°C - Operating Temperature -40°C to +125°C⁶

Part ⁵ Number	Inductance ¹ @ I _{rated} (μH ± 15%)	I _{rated} ² (A)	DCR (MAX) (mΩ)	Inductance @ 0A _{DC} (μH ± 20%)	Saturation Current ³ I _{sat} (A)	Heating Current ⁴ I _{hc} (A)
PF0504.681NL	0.68	20.0	2.0	0.68	64	20.0
PF0504.122NL	1.2	17.1	2.6	1.2	48	17.7
PF0504.222NL	2.2	14.7	3.7	2.2	35	14.7
PF0504.332NL	3.3	13.7	4.3	3.3	29	13.7
PF0504.392NL	3.9	11.7	6.7	3.9	26	11.7
PF0504.472NL	4.7	10.8	6.9	4.7	24	10.8
PF0504.682NL	6.8	9.0	9.8	6.8	20	9.0
PF0504.103NL	10	7.1	15	10	16	7.1
PF0504.183NL	18	6.0	25	18	13	6.0
PF0504.223NL	22	5.4	27	22	11	5.4
PF0504.333NL	33	4.4	42	33	9	4.4
PF0504.403NL	40	4.0	50	40	8	4.0
PF0504.473NL	47	3.5	55	47	7	3.5
PF0504.104NL	100	2.3	153	100	5	2.3
PF0504.154NL	150	2	200	150	4	2

Mechanical

Schematic

PF0504.XXXNL

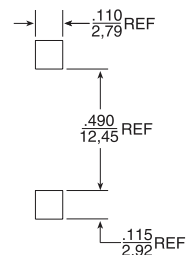
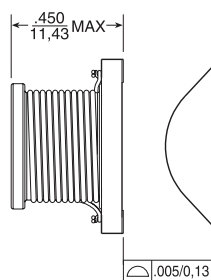
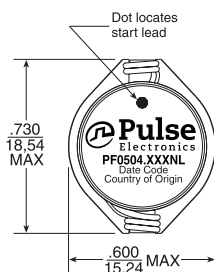

SUGGESTED PAD LAYOUT

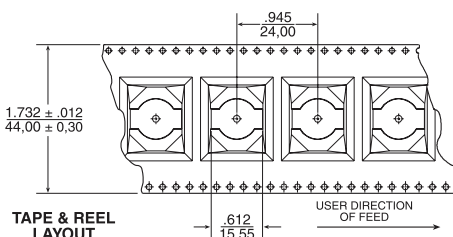
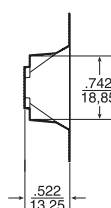
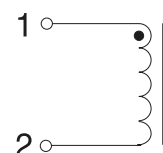

TAPE & REEL LAYOUT

Weight6.0 grams
Tape & Reel160/reel

Dimensions: $\frac{\text{Inches}}{\text{mm}}$

Unless otherwise specified,
all tolerances are $\pm \frac{.004}{0.10}$

SMT Power Inductors

Unshielded Drum Core - PF0504NL Series

Notes from Tables:

1. Inductance at I_{rated} is a typical inductance value measured when the inductor is subjected to the rated current.
2. The rated current listed is the lower of the saturation current @ 25°C or the heating current.
3. The saturation current, I_{sat} , is the current at which the component inductance drops by 20% (maximum) at an ambient temperature of 25°C. This current is determined by placing the component in the specified ambient environment and applying a short duration pulse current (to eliminate self-heating effects) to the component.
4. The heating current, I_{hc} , is the DC current required to raise the component temperature by approximately 40°C. The heating current is determined by mounting the component on a typical PCB and applying current for 30 minutes.
5. Optional Tape & Reel packaging can be ordered by adding a "T" suffix to the part number (i.e. PF0504.681NL becomes PF0504.681NLT). Pulse complies to industry standard tape and reel specification EIA481.
6. The temperature of the component (ambient plus temperature rise) must be within the stated operating temperature range.

Inductance vs Current Characteristics

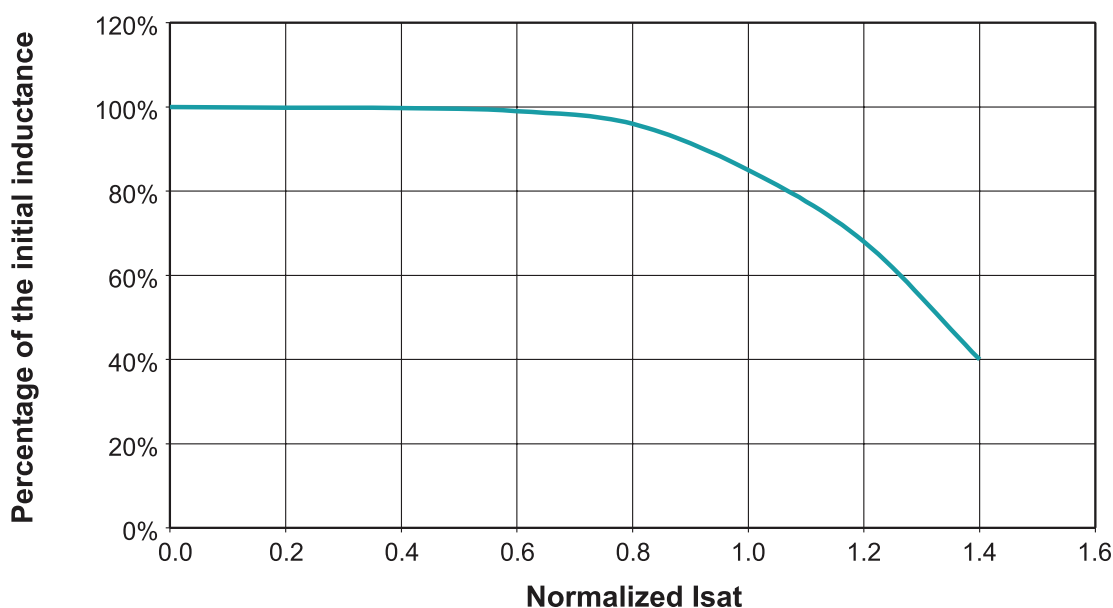

For More Information

Pulse Worldwide Headquarters

15255 Innovation Drive Ste 100
San Diego, CA 92128
U.S.A.

Pulse Europe

Pulse Electronics GmbH
Am Rottland 12
58540 Meinerzhagen
Germany

Pulse China Headquarters

Pulse Electronics (ShenZhen) CO., LTD
D708, Shenzhen Academy of
Aerospace Technology,
The 10th Keji South Road,
Nanshan District, Shenzhen,
P.R. China 518057

Pulse North China

Room 2704/2705
Super Ocean Finance Ctr.
2067 Yan An Road West
Shanghai 200336
China

Pulse South Asia

3 Fraser Street 0428
DUO Tower
Singapore 189352

Pulse North Asia

1F., No.111 Xiyuan Road
Zhongli District
Taoyuan City 32057
Taiwan (R.O.C)

Tel: 858 674 8100
Fax: 858 674 8262

Tel: 49 2354 777 100
Fax: 49 2354 777 168

Tel: 86 755 33966678
Fax: 86 755 33966700

Tel: 86 21 62787060
Fax: 86 21 62786973

Tel: 65 6287 8998
Fax: 65 6280 0080

Tel: 886 3 4356768
Fax: 886 3 4356820

Performance warranty of products offered on this data sheet is limited to the parameters specified. Data is subject to change without notice. Other brand and product names mentioned herein may be trademarks or registered trademarks of their respective owners. © Copyright, 2019. Pulse Electronics, Inc. All rights reserved.

Mouser Electronics

Authorized Distributor

Click to View Pricing, Inventory, Delivery & Lifecycle Information:

Pulse:

[PF0504.103NLT](#) [PF0504.104NLT](#) [PF0504.154NLT](#) [PF0504.223NLT](#) [PF0504.333NLT](#) [PF0504.403NLT](#)
[PF0504.472NLT](#) [PF0504.682NLT](#) [PF0504.332NLT](#) [PF0504NLKIT](#)