

Device connector, rear mounting - RC-06S1NA2H000 - 1614175

Please be informed that the data shown in this PDF Document is generated from our Online Catalog. Please find the complete data in the user's documentation. Our General Terms of Use for Downloads are valid (<http://phoenixcontact.com/download>)



Device connector for rear wall, straight, shielded: yes, Screw locking, M23, No. of pos.: 6, type of contact: Socket, Solder-in connection, Axial O-ring, Central fastening M25 x 1.5, Panel thickness min.: 0.8 mm, Panel thickness max.: 6.5 mm

The figure shows the 12-pos. product version

RoHS

Key Commercial Data

| | |
|--------------|---|
| Packing unit | 12 pc |
| GTIN |  4 046356 404082 |
| GTIN | 4046356404082 |

Technical data

Dimensions

| | |
|------------------------|--------|
| free solder pin length | 3.5 mm |
|------------------------|--------|

Data of the insulating body

| | |
|---|----------------------|
| Coding | N |
| Insertion/withdrawal cycles mechanical | 50 |
| Contact connection method | Solder-in connection |
| Type of contacts | Socket |
| Application | Signal |
| Number of positions | 6 |
| Contact diameter of power contacts | 2 mm |
| Nominal current per power contact at 25°C | 20 A |
| Nominal voltage, power contact | 300 V |
| Rated surge voltage | 2.5 kV |
| Overvoltage category | II |
| Degree of pollution | 3 |
| Overvoltage category | II |
| Degree of pollution | 3 |

Device connector, rear mounting - RC-06S1NA2H000 - 1614175

Technical data

Housing data

| | |
|--|---------------|
| Housing material | Metal |
| Type of locking | Screw locking |
| Degree of protection (when plugged in) | IP67 |
| Thread type | M23 |

Environmental Product Compliance

| | |
|------------|---|
| REACH SVHC | Lead 7439-92-1 |
| China RoHS | Environmentally Friendly Use Period = 50 |
| | For details about hazardous substances go to tab "Downloads", Category "Manufacturer's declaration" |

Drawings

Schematic diagram

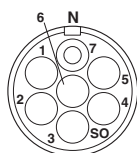

6-pos.

Drilling diagram

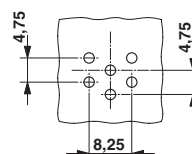

Dimensional drawing

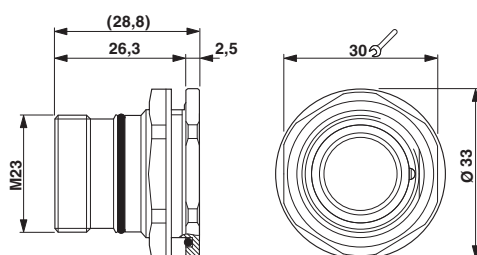

Dimensional drawing

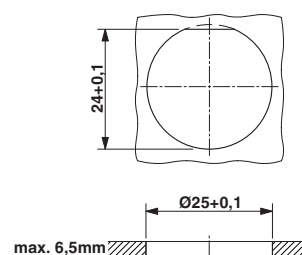

Installation dimensions

Approvals

Approvals

Approvals

EAC

Ex Approvals

Device connector, rear mounting - RC-06S1NA2H000 - 1614175

Approvals

Approval details

| | | |
|-----|---|---------|
| EAC |  | B.01742 |
|-----|---|---------|

Phoenix Contact 2018 © - all rights reserved
<http://www.phoenixcontact.com>

PHOENIX CONTACT GmbH & Co. KG
Flachsmarktstr. 8
32825 Blomberg
Germany
Tel. +49 5235 300
Fax +49 5235 3 41200
<http://www.phoenixcontact.com>

Mouser Electronics

Authorized Distributor

Click to View Pricing, Inventory, Delivery & Lifecycle Information:

Phoenix Contact:

1614175