

THIS COPY IS PROVIDED ON A RESTRICTED BASIS AND IS NOT TO BE USED IN ANY WAY DETRIMENTAL TO THE INTERESTS OF PANDUIT CORP.

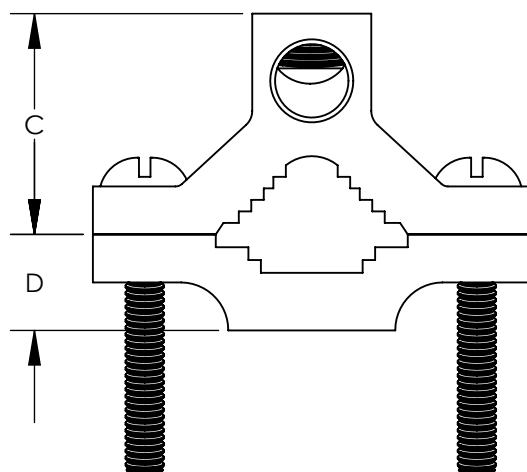
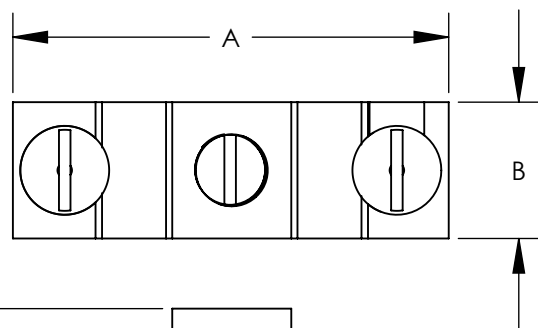

NOTES:

1. ANTI-OXIDANT JOINT COMPOUND RECOMMENDED FOR ALL ALUMINUM CONNECTIONS
2. CLAMP AND SET SCREWS ARE TIN PLATED ALUMINUM
3. MADE IN U.S.A.
4. SEE TABLE BELOW FOR RIGID CONDUIT, GALVANIZED STEEL WATER PIPE OR COPPER WATER TUBE SIZE:

CAT. NO.	TUBE SIZE
GC-15A-Q	1/2 - 3/4 - 1 IN.
GC-18A-X	1-1/4 - 1-1/2 - 2 IN.
GC-22A-4	2-1/2 - 3 - 3-1/2 - 4 IN.

CAT. NO.	WIRE RANGE COPPER AND ALUMINUM	INSTALLATION TOOL	DIM A IN.	DIM B IN.	DIM C IN.	DIM D IN.
GC-15A-Q	1/0 - 14 AWG STR. 10 - 14 AWG SOL.	SLOTTED SCREW DRIVER	2.25	0.69	(A) 1.150	(B) 0.50
GC-18A-X	250 kcmil - 6 AWG STR.	5/16 HEX ALLEN WRENCH	3.75	0.81	1.81	(C) 0.875
GC-22A-4	250 kcmil - 6 AWG STR.	5/16 HEX ALLEN WRENCH	6.31	1.00	(D) 2.58	(E) 1.62

								<div><div>PANDUIT</div><div>CORP. TINLEY PARK, ILLINOIS</div><div>ALUMINUM GROUND CLAMP GC SERIES</div><div>CUSTOMER DRAWING</div></div>	
03	2/12	JHNU	JHNU	ADDED CSA LOGO TO DRAWING	N41103BB-C41103	RGB	RGB		
02	10/08	JHNU	JHNU	REVISED UL LISTING CONVERTED DWG. TO SOLIDWORKS					
01	11/03	SAC		DWG TITLE WAS CUSTOMER DWG TYPE GCA, PART #'S WERE GCA2-X & GCA4-4, DIM A WAS 1.09, DIM B WAS 0.69, DIM C WAS 1.25, DIM D WAS 2.31, DIM E WAS 1.75	○				
00	6/93	MJC	RAK	DWG. RELEASED	01769				
REV	DATE	BY	CHK	DESCRIPTION	ECN	-R	CHK	SCALE N/A	DRAWING NO / CAD FILE C41103_03

Mouser Electronics

Authorized Distributor

Click to View Pricing, Inventory, Delivery & Lifecycle Information:

Panduit:

[GC-15A-Q](#) [GC-22A-4](#) [GC-18A-X](#)