

THIS COPY IS PROVIDED ON A RESTRICTED BASIS AND IS NOT TO BE USED IN ANY WAY DETRIMENTAL TO THE INTERESTS OF PANDUIT CORP.

FIGURES DEPICT
PRODUCT NEAR
FULL RETRACTION
OF SHADE

NOTES:

1. MAX TEMPERATURE RATING OF PRODUCT IS 50°C (122°F) CONTINUOUS;
70°C (158°F) INTERMITTENT
2. SHADE FABRIC IS STATIC DISSIPATIVE.
3. MINIMUM RACK UNIT TO BE BLANKED IS 4RU; MAXIMUM RACK UNIT TO BE BLANKED IS 51RU
4. PRODUCT TO BE USED WITH MOUNTING RAILS THAT HAVE 3/8" SQUARE PUNCHED HOLES, AND FOR RACKS WITH M5, M6, #10 OR #12 THREADED HOLES.
5. PRODUCT MAY BE USED WITH 11ga - 14ga THICK STEEL OR UP TO .185" THK ALUMINUM MOUNTING RAILS.
6. SHADE IS INSTALLED FROM BACK OF MOUNTING RAIL.
7. REFER TO PANDUIT WEBSITE FOR INSTALLATION INSTRUCTIONS.
8. PRODUCT IS RoHS COMPLIANT.

18.310
CENTER TO CENTER
MTG HOLE DISTANCE

THREADED KNOBS FOR
MOUNTING OF UPPER
HOUSING (2 PLACES)

11ga - 14ga
(0.120 - 0.075)
AND EXTRUDED ALUM
UP TO 0.185"

3/8" SQUARE
PUNCHED HOLES OR
M5, M6, #10, #12
TAPPED HOLES

MOUNTING RAILS

LATCH SLIDES HORIZONTALLY
TO ENGAGE MOUNTING RAILS. ALLOWS
QUICK ADJUSTMENT OF BOTTOM PULL
TO ADD OR REMOVE EQUIPMENT IN
CABINET OR RACK.

REPLACE SQUARE HOLE PIN WITH
ROUND HOLE PIN FOR RACKS WITH
TAPPED HOLES. REMOVE RETAINERS
FROM BACK OF SHADE, CHANGE
PINS AND REPLACE RETAINERS.

DETAIL V

TITLE

FULL LENGTH BLANKING SHADE (FLBSIM-51)

CUSTOMER DRAWING

ITEM REVISION NAME

13K003AD/00

DATASET FILE NAME

13K003AD_DC_C11482/00A

UNLESS OTHERWISE SPECIFIED,
DIMENSIONAL TOLERANCES ARE: IN [mm]

.x ± .1 [2.54]

.xxx ± .005 [.127]

.xx ± .01 [.25]

ANGLES ± 5 °

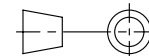

THIRD ANGLE
PROJECTION

MATERIAL:

DRAWING NUMBER:

C11482

0 10/1/14 DFA DJW KLN INITIAL RELEASE

GAECN02077

REV DATE BY CHK APR DESCRIPTION

ECN

DRAWN BY

DATE

CHK

SCALE

DFA

9/17/14

KLN

NONE

SHT 1 OF 1

SIZE
A

Mouser Electronics

Authorized Distributor

Click to View Pricing, Inventory, Delivery & Lifecycle Information:

Panduit:

FLBSIM-51