

ALL DIMENSIONS ARE IN (mm)														
Part Number	Wire Size	Wire Class	Stud Size	Wire Strip Length	l ±2.76	o ±.50	i ±.50	a ±2.25	m (ref)	c ±.50	n	d ±.50	b	t
LCMDX10-8-Q	10 mm ²	5f & 6f	M8	16.0	79.0	7.20	5.50	14.5	10.3	44.50	6.5±1.25	9.00	13.0±1.25	1.20±.40
LCMDX16-8-Q	16 mm ²	5f & 6f	M8	16.5	81.5	8.80	6.90	15.0	10.0	44.50	8.0±1.25	9.00	15.5±1.25	1.60±.40
LCMDX25-8-Q	25 mm ²	5f & 6f	M8	19.0	86.5	10.40	8.20	17.5	12.3	44.50	8.5±2.25	9.00	15.5±2.25	2.05±.40
LCMDX25-10-Q	25 mm ²	5f & 6f	M10	19.0	86.5	10.40	8.20	17.5	12.3	44.50	8.5±2.25	11.00	15.5±2.25	2.05±.40
LCMDX25-12-Q	25 mm ²	5f & 6f	M12	19.0	92.5	10.40	8.20	17.5	14.5	44.50	11.5±2.25	14.00	21.5±2.25	1.50±.40
LCMDX35-10-Q	35 mm ²	5f & 6f	M10	21.8	91.0	12.30	9.80	20.3	11.5	44.50	10.0±2.25	11.00	18.0±2.25	2.50±.40
LCMDX35-12-Q	35 mm ²	5f & 6f	M12	21.8	94.5	12.30	9.80	20.3	14.0	44.50	11.0±2.25	14.00	23.0±2.25	1.80±.40
LCMDX50-10-X	50 mm ²	5f & 6f	M10	24.8	98.0	14.20	11.50	23.3	14.5	44.50	11.5±2.25	11.00	20.8±2.25	2.85±.40
LCMDX50-12-X	50 mm ²	5f & 6f	M12	24.8	98.0	14.20	11.50	23.3	14.5	44.50	11.5±2.25	14.00	20.8±2.25	2.80±.40
LCMDX70-10-X	70 mm ²	5f & 6f	M10	26.0	105.0	16.50	13.50	24.5	15.0	44.50	13.5±2.25	11.00	24.5±2.25	3.00±.40
LCMDX70-12-X	70 mm ²	5f & 6f	M12	26.0	105.0	16.50	13.50	24.5	15.0	44.50	13.5±2.25	14.00	24.5±2.25	3.00±.40
LCMDX95-12-X	95 mm ²	5f & 6f	M12	26.0	109.5	18.60	15.20	24.5	15.5	44.50	14.5±2.25	14.00	27.5±2.25	3.50±.45
LCMDX95-14-X	95 mm ²	5f & 6f	M14	26.0	109.5	18.60	15.20	24.5	15.5	44.50	14.5±2.25	16.00	27.5±2.25	3.40±.45
LCMDX120-12-X	120 mm ²	5f & 6f	M12	29.0	115.0	21.00	16.50	27.5	18.0	44.50	16.5±2.25	14.00	30.5±2.25	4.45±.45
LCMDX120-14-X	120 mm ²	5f & 6f	M14	29.0	118.5	21.00	16.50	27.5	22.0	44.50	16.5±2.25	16.00	30.5±2.25	4.30±.45
LCMDX150-12-X	150 mm ²	5f & 6f	M12	29.7	117.0	23.00	18.60	28.2	16.5	44.50	17.5±2.25	14.00	33.5±2.25	4.55±.50
LCMDX150-14-X	150 mm ²	5f & 6f	M14	29.7	121.5	23.00	18.60	28.2	21.0	44.50	17.5±2.25	16.00	33.5±2.25	4.40±.50
LCMDX185-12-X	185 mm ²	5f & 6f	M12	36.5	131.0	26.00	20.80	35.0	21.0	44.50	19.5±2.25	14.00	37.5±2.25	5.30±.50
LCMDX185-14-X	185 mm ²	5f & 6f	M14	36.5	131.0	26.00	20.80	35.0	21.0	44.50	19.5±2.25	16.00	37.5±2.25	5.30±.50
LCMDX240-12-5	240 mm ²	5f & 6f	M12	41.8	139.0	29.00	23.50	40.3	22.0	44.50	20.0±2.25	14.00	42.5±2.25	5.40±.55
LCMDX240-14-5	240 mm ²	5f & 6f	M14	41.8	139.0	29.00	23.50	40.3	22.0	44.50	20.0±2.25	16.00	42.5±2.25	5.40±.55
LCMDX300-12-5	300 mm ²	5f	M12	46.3	151.5	33.00	26.20	44.8	26.5	44.50	23.5±2.25	14.00	48.0±2.25	6.70±.55
LCMDX300-14-5	300 mm ²	5f	M14	46.3	151.5	33.00	26.20	44.8	26.5	44.50	23.5±2.25	16.00	48.0±2.25	6.70±.55

- NOTES: 1. Material: High conductivity seamless copper tube.
2. Plating: Parts are annealed and tin plated.
3. WireType: Class 5 and 6 Flexible Stranded Copper Conductor per DIN VDE 0295, IEC 60228, and HD 383.
4. UL Listed & CSA Certified Wire Connectors for applications up to 35kv, when crimped per instruction sheet included with Panduit packaging. Consult cable manufacturer for voltage stress relief instructions with applications greater than 2000 volts.
5. UL & CSA Temperature Rating: 90°C

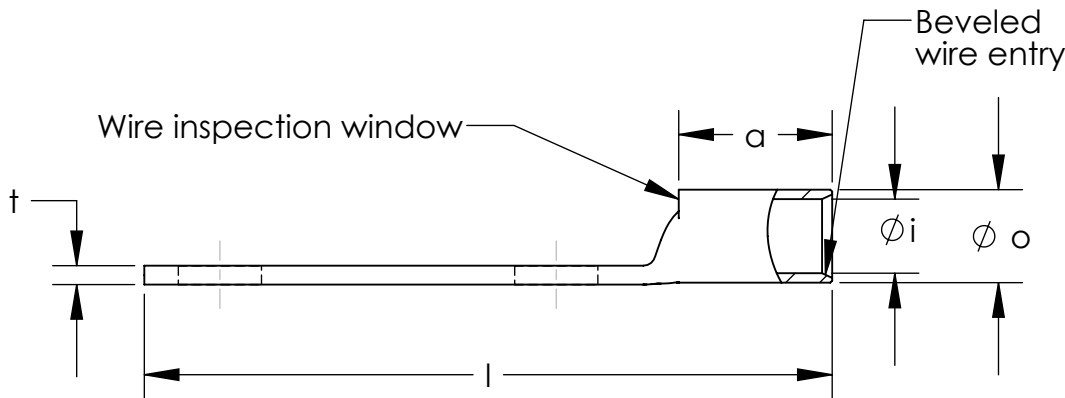

LISTED
Wire Connector

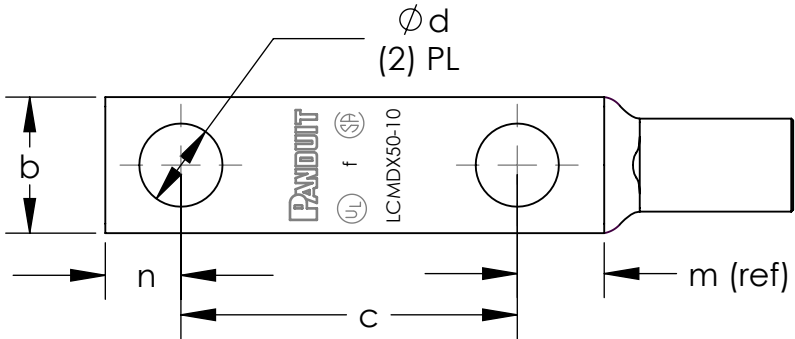

CERTIFIED

PANDUIT CORP. TINLEY PARK, ILLINOIS

METRIC FLEX LUGS - LCMDX SERIES 10-300mm²
CUSTOMER DRAWING

UNLESS OTHERWISE SPECIFIED
DIMENSIONAL TOLERANCES ARE:
(.X) ±
(.XX) ±
(.XXX) ±
ANGLES ±

UNLESS OTHERWISE SPECIFIED,
ALL DIMENSIONS ARE GIVEN IN
INCHES, THIRD ANGLE PROJECTION

DRAWN BY
TLCO
DATE
5/11
CHK'D
TLCO

MAT'L:

SEE
NOTES
ABOVE

SCALE
NONE

DRAWING NO / CAD FILE

10N014BB-NC

DWG
B
SIZE

00	11/12	TLCO	TLCO	DRAWING RELEASED	10N014BB-NC	RGB	RGB
REV	DATE	BY	CHK	DESCRIPTION	ECN	-R	SUP

Mouser Electronics

Authorized Distributor

Click to View Pricing, Inventory, Delivery & Lifecycle Information:

Panduit:

[LCMDX240-12-5](#) [LCMDX16-8-Q](#) [LCMDX50-12-X](#) [LCMDX185-14-X](#) [LCMDX25-10-Q](#) [LCMDX50-10-X](#) [LCMDX150-12-X](#) [LCMDX10-8-Q](#) [LCMDX35-12-Q](#) [LCMDX185-12-X](#) [LCMDX25-8-Q](#) [LCMDX300-14-5](#) [LCMDX70-12-X](#) [LCMDX120-12-X](#) [LCMDX150-14-X](#) [LCMDX70-10-X](#) [LCMDX25-12-Q](#) [LCMDX95-12-X](#) [LCMDX35-10-Q](#) [LCMDX240-14-5](#) [LCMDX95-14-X](#) [LCMDX120-14-X](#) [LCMDX300-12-5](#)