

THIS COPY IS PROVIDED ON A RESTRICTED BASIS AND IS NOT TO BE USED IN ANY WAY DETRIMENTAL TO THE INTERESTS OF PANDUIT CORP.

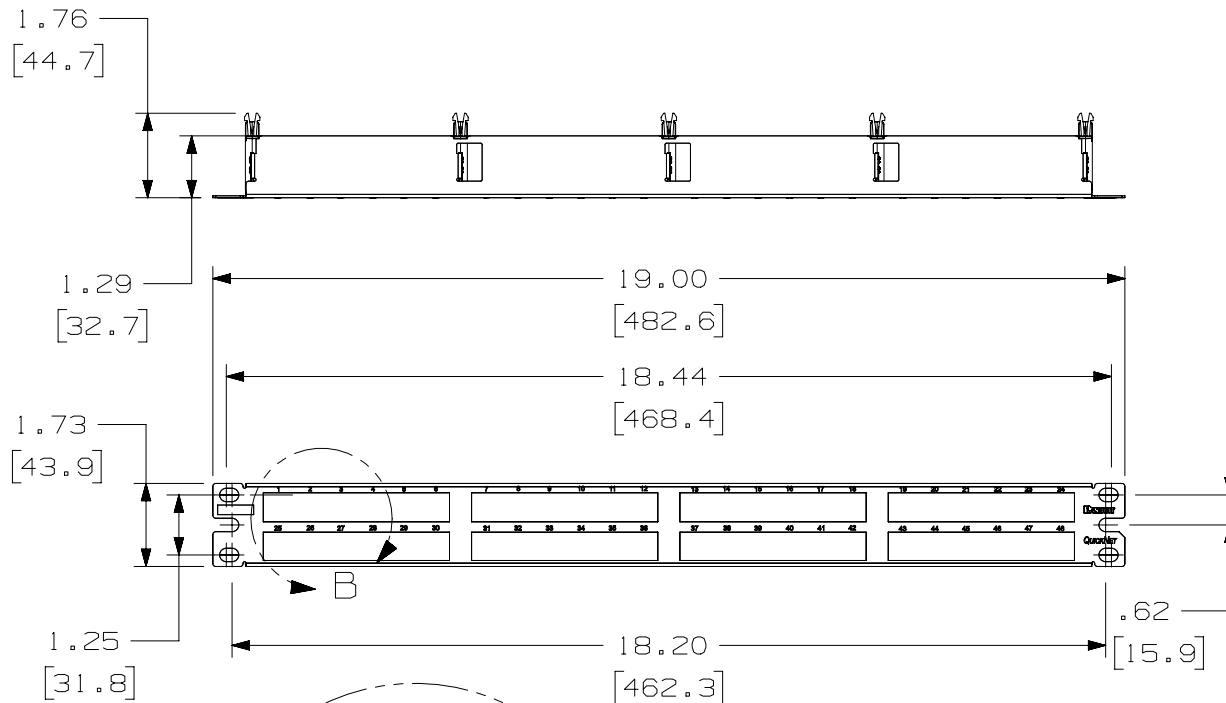

DETAIL B

| PANDUIT PART NO. | WEIGHT (APPOX.) |
|---------------------|--------------------|
| QPP48HDVNSBL | 0.65 lb (294.8 g) |
| QPP48HDVNSWH | 0.65 lb (294.8 g) |

NOTES:

1. SEE CURRENT CATALOG FOR VARIOUS APPLICATIONS.
2. THE PATCH PANEL HAS A VERTICAL NUMBERING SEQUENCE AND IS DESIGNED FOR MOUNTING TO 19" UNIVERSAL RACKS.
3. DIMENSIONS IN BRACKETS ARE IN METRIC.
4. PACKAGE CONTENTS:
1- METAL STAMPING WITH SLIDE GUIDES
1- SCREW KIT (INCLUDES FOUR #12-24 SCREWS)
1- SCREW KIT (INCLUDES FOUR M6 SCREWS)
5. QPP48HDVNSBL IS BLACK WITH WHITE SILKSCREENING.
QPP48HDVNSWH IS WHITE WITH BLACK SILKSCREENING.

QPP48HDVNSWH
HAS NO MARKING PAD

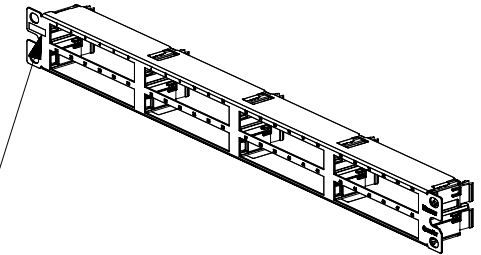

PART NUMBER

QPP48HDVNSBL/QPP48HDVNSWH

TITLE

QUICKNET 48 PORT PATCH PANEL WITH VERTICAL
NUMBERING SEQUENCE

CUSTOMER DRAWING

ITEM REVISION NAME

M02582DK/01

DATASET FILE NAME

M02582DK_DC63/01A

UNLESS OTHERWISE SPECIFIED,
DIMENSIONAL TOLERANCES ARE: IN [mm]

.x ±
.xx ± .03 (.8)

.xxx ± .010 (.3)
ANGLES ±

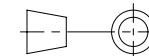

THIRD ANGLE
PROJECTION

MATERIAL:

PANEL: C.R.S.
GUIDES: ABS

DRAWING NUMBER:

02582-63

DRAWN BY

DATE

CHK

SCALE

MDJr

9-01-06

WFMi

NONE

SHT 1 OF 1

SIZE

A

| REV | DATE | BY | CHK | APR | DESCRIPTION | ECN |
|-----|----------|------|------|------|---------------------------------|----------|
| 2 | 12-28-17 | BAME | KRKE | RWB | QPP48HDVNSBL | M09000HA |
| 1 | 5/23/14 | JSP | REFR | TMBA | A. REVISED DRAWING TITLE BLOCK. | 02582-63 |
| R | 1-02-08 | MDJr | WFMI | TRW | RELEASED TO PRODUCTION | 02582-63 |

Mouser Electronics

Authorized Distributor

Click to View Pricing, Inventory, Delivery & Lifecycle Information:

Panduit:

[QPP48HDVNSWH](#)