

Hinged Tactile Switch

B3J

Through-hole-mounting Switches with Hinges for a Sharp Snap Action

- Quick, superior snap action through hook-type hinge construction.
- Available with 1 or 2 LEDs or without LEDs.
- The hinge button is available in a wide variety of colors (five standard colors).

RoHS Compliant

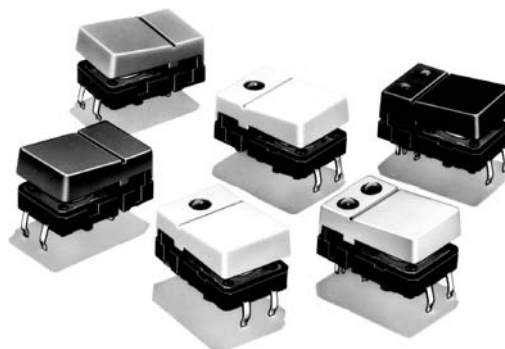

■ List of Models

| Operation type | Contact material | Operating force (OF) | Color of hinged button | Box | |
|---------------------------------|------------------|----------------------|------------------------|----------|----------------------|
| | | | | Model | Minimum packing unit |
| Non-lighted: B3J-1000 Series | Silver plated | 1.27 N {130 gf} | Ivory | B3J-1000 | 300 pcs |
| | | | Black | B3J-1100 | |
| | | | Orange | B3J-1200 | |
| | | | Yellow | B3J-1300 | |
| | | | Blue | B3J-1400 | |

| Operation type | Contact material | Operating force (OF) | Color of hinged button | Box | | | |
|---|------------------|----------------------|------------------------|-----------|----------|----------|----------------------|
| | | | | LED color | | | Minimum packing unit |
| | | | | Red | Yellow | Green | |
| One LED: B3J-2000 Series B3J-3000 Series B3J-4000 Series | Silver plated | 1.27 N {130 gf} | Ivory | B3J-2000 | B3J-3000 | B3J-4000 | 300 pcs |
| | | | Black | B3J-2100 | B3J-3100 | B3J-4100 | |
| | | | Orange | B3J-2200 | B3J-3200 | B3J-4200 | |
| | | | Yellow | B3J-2300 | B3J-3300 | B3J-4300 | |
| | | | Blue | B3J-2400 | B3J-3400 | B3J-4400 | |

| Operation type | Contact material | Operating force (OF) | Color of hinged button | Box | | | Minimum packing unit |
|--|------------------|----------------------|------------------------|------------|-----------|--------------|----------------------|
| | | | | LED color | | | |
| | | | | Red/Yellow | Red/Green | Yellow/Green | |
| Two LEDs: B3J-5000 Series B3J-6000 Series B3J-7000 Series | Silver plated | 1.27 N {130 gf} | Ivory | B3J-5000 | B3J-6000 | B3J-7000 | 300 pcs |
| | | | Black | B3J-5100 | B3J-6100 | B3J-7100 | |
| | | | Orange | B3J-5200 | B3J-6200 | B3J-7200 | |
| | | | Yellow | B3J-5300 | B3J-6300 | B3J-7300 | |
| | | | Blue | B3J-5400 | B3J-6400 | B3J-7400 | |

■ Ratings/Characteristics

| | |
|---|---|
| Rating (resistive load) | 1 to 50 mA, 3 to 24 VDC |
| Minimum applicable load (reference value) | 10 μ A at 1 VDC (resistive load) |
| Ambient operating temperature | -25°C to +70°C at 60%RH max. (with no icing or condensation) |
| Ambient operating humidity | 35% to 85% (at +5 to +35°C) |
| Contact form | SPST-NO |
| Contact resistance (initial value) | 100 m Ω max. |
| Insulation resistance | 100 M Ω min. (at 250 VDC with insulation tester) |
| Dielectric strength | 500 VAC, 50/60 Hz for 1 min |
| Bounce time | 5 ms max. |
| Vibration resistance | Malfunction: 10 to 55 Hz, 1.5-mm double amplitude |
| Shock resistance | Destruction: 1,000 m/s ² {approx. 100G} max. Malfunction: 100 m/s ² {approx. 10G} max. |
| Durability | 3,000,000 operations min. |
| Weight | Approx. 1.5 to 1.7 g |
| Degree of protection | IEC IP00 |
| Washing | Not possible |

■ Operating Characteristics

| | |
|----------------------|--|
| Operating force (OF) | 1.27 \pm 0.49 N {130 \pm 50 gf} |
| Releasing force (RF) | 0.29 N {30 gf} min. |
| Pretravel (PT) | 0.3 ^{+0.2} / _{-0.1} mm |

■ LED Specifications

| Item | | Red | Yellow | Green |
|--------------------|-----------------------------|-----|--------|-------|
| Forward voltage VF | Standard value (V) | 2.0 | 2.0 | 2.1 |
| Forward current IF | Standard value (mA) | 20 | 20 | 20 |
| Permissible loss P | Absolute maximum value (mW) | 84 | 84 | 84 |
| Reverse voltage VR | Absolute maximum value (V) | 5 | 5 | 5 |

Note: Since the built-in LED does not contain any limiting resistors, externally connect limiting resistors within the limits shown in the above table.

■ Dimensions (Unit: mm)

Types with no LED

B3J-1□00

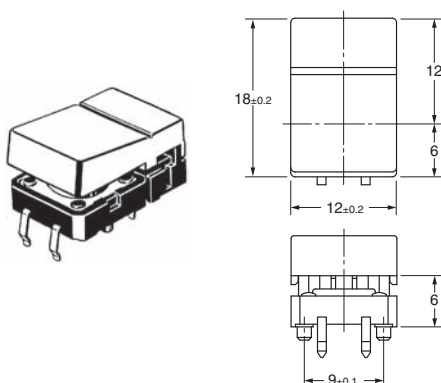

PCB Processing Dimensions (Reference Only) (Top View)

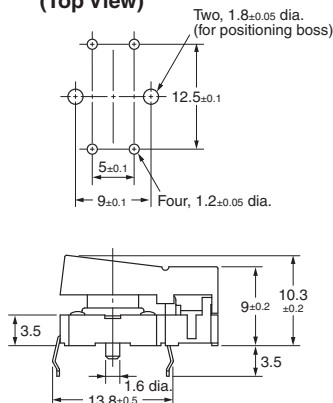

Panel Cutout Terminal Arrangement /Internal Connections (Top View)

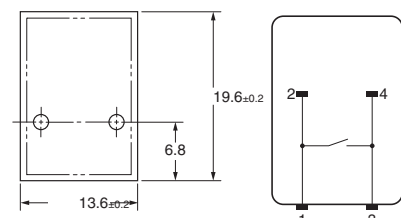

1 LED Types

B3J-2□00

B3J-3□00

B3J-4□00

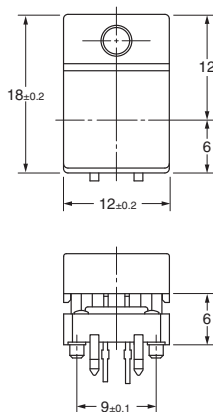
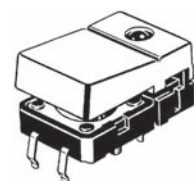

PCB Processing Dimensions (Reference Only) (Top View)

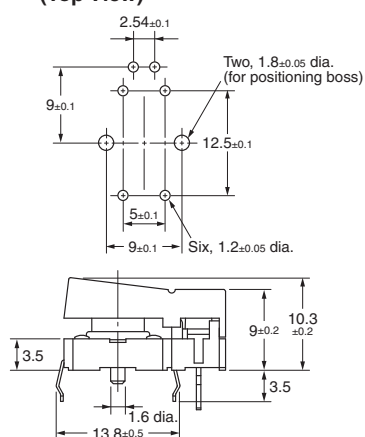

Panel Cutout Terminal Arrangement /Internal Connections (Top View)

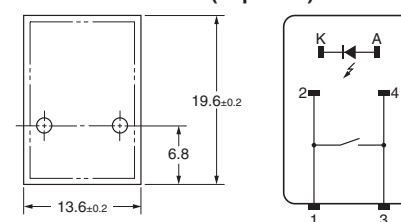

2 LED Types

B3J-5□00

B3J-6□00

B3J-7□00

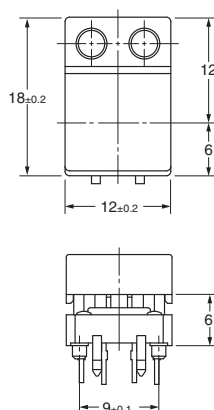
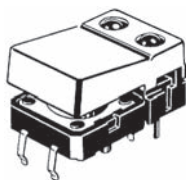

PCB Processing Dimensions (Reference Only) (Top View)

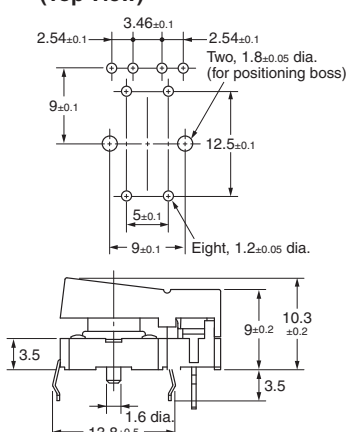

Panel Cutout Terminal Arrangement /Internal Connections (Top View)

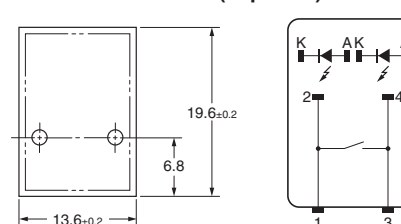

Note: Unless otherwise specified, a tolerance of ± 0.4 mm applies to all dimensions.

■ Precautions

Be sure to read the safety precautions common to all Tactile Switches for correct use.

- Application examples provided in this document are for reference only. In actual applications, confirm equipment functions and safety before using the product.
- Consult your OMRON representative before using the product under conditions which are not described in the manual or applying the product to nuclear control systems, railroad systems, aviation systems, vehicles, combustion systems, medical equipment, amusement machines, safety equipment, and other systems or equipment that may have a serious influence on lives and property if used improperly. Make sure that the ratings and performance characteristics of the product provide a margin of safety for the system or equipment, and be sure to provide the system or equipment with double safety mechanisms.

Note: Do not use this document to operate the Unit.

OMRON Corporation

Electronic and Mechanical Components Company

Contact: www.omron.com/ecb

Cat. No. A071-E1-07
1014(0207)(O)

Mouser Electronics

Authorized Distributor

Click to View Pricing, Inventory, Delivery & Lifecycle Information:

[Omron:](#)

[B3J-2100](#) [B3J-1000](#) [B3J-1100](#) [B3J-1400](#)