

HSF Cable Leaded Aluminium Housed Resistors

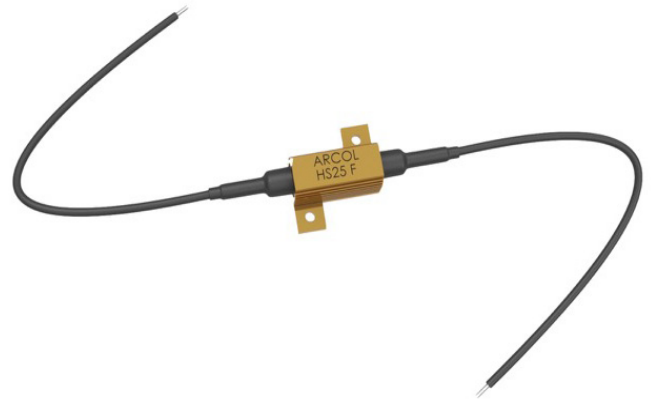

Leaded version of ARCOL's aluminium housed resistor, comes with factory fitted cable terminations for ease of assembly into your application.

- High Power to volume
- Wound to maximise High Pulse Capability
- 200 mm flying lead terminations
- Radox 1800V Traction Cable
- Values from R005 to 70K



Characteristics

Tolerance (Code):	Standard $\pm 1\%$ (F). Also available $\pm 5\%$ (J)
Tolerance for low Ω values:	Typically $\geq R05 \pm 5\% \leq R047 \pm 10\%$
Temperature coefficients:	Typical values $< 1K$ 100ppm Std. $> 1K$ 25ppm Std. For lower TCR's please contact Arcol
Insulation resistance (Dry):	10,000 M Ω minimum
Power dissipation:	At high ambient temperature dissipation derates linearly to zero at 200°C
Ohmic values:	From R005 to 70K depending on wattage size
Cable Nominal Value:	1800 V AC

Electrical Specifications

Size	Power rating on std. heatsink @25°C	Watts with no heatsink @25°C	Resistance range	Limiting element voltage	Voltage proof AC Peak	Voltage proof AC rms.	Approx weight gms	Typical surface rise HS mounted	Standard heatsink	
									cm ²	Thickness mm
HS25F (M404)	25	9	R005-36K	550	3500	2500	14	4.2	535	1
HS50F (M404)	50	14	R01-86K	1250	3500	2500	32	3.0	535	1
HS100F (M372)	100	30	R01-70K	1800	6363	4500	115	1.0	995	3

Ordering Procedure

Standard Resistor. To specify standard: Series, Watts, Ohmic Value, Tolerance Code, Drawing Number

e.g.: HS25F 10R F M404, HS50F 10R F M404, HS100F 10R F M372

Non Inductive Resistor. To specify add N, e.g.:

NHS25F 10R J M404, NHS50F 10R J M404, NHS100F 10R J M372

ARCOL UK Limited,
Threemilestone Ind. Estate,
Truro, Cornwall, TR4 9LG, UK.
T +44 (0) 1872 277431
F +44 (0) 1872 222002
E sales@arcolresistors.com

www.arcolresistors.com

The information contained herein does not form part of a contract and is subject to change without notice. ARCOL operate a policy of continual product development, therefore, specifications may change.

It is the responsibility of the customer to ensure that the component selected from our range is suitable for the intended application. If in doubt please ask ARCOL.

HSF Cable leaded Aluminium Housed Resistors

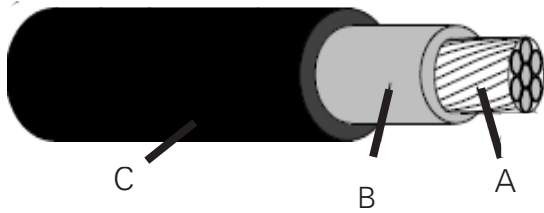

- 3.2mm Radox traction cable 1.5 mm²
- A. Conductor: Stranded tin plated copper
- B. Inner layer insulation: RADOX EI 110
- C. Outer layer insulation: RADOX EI 109

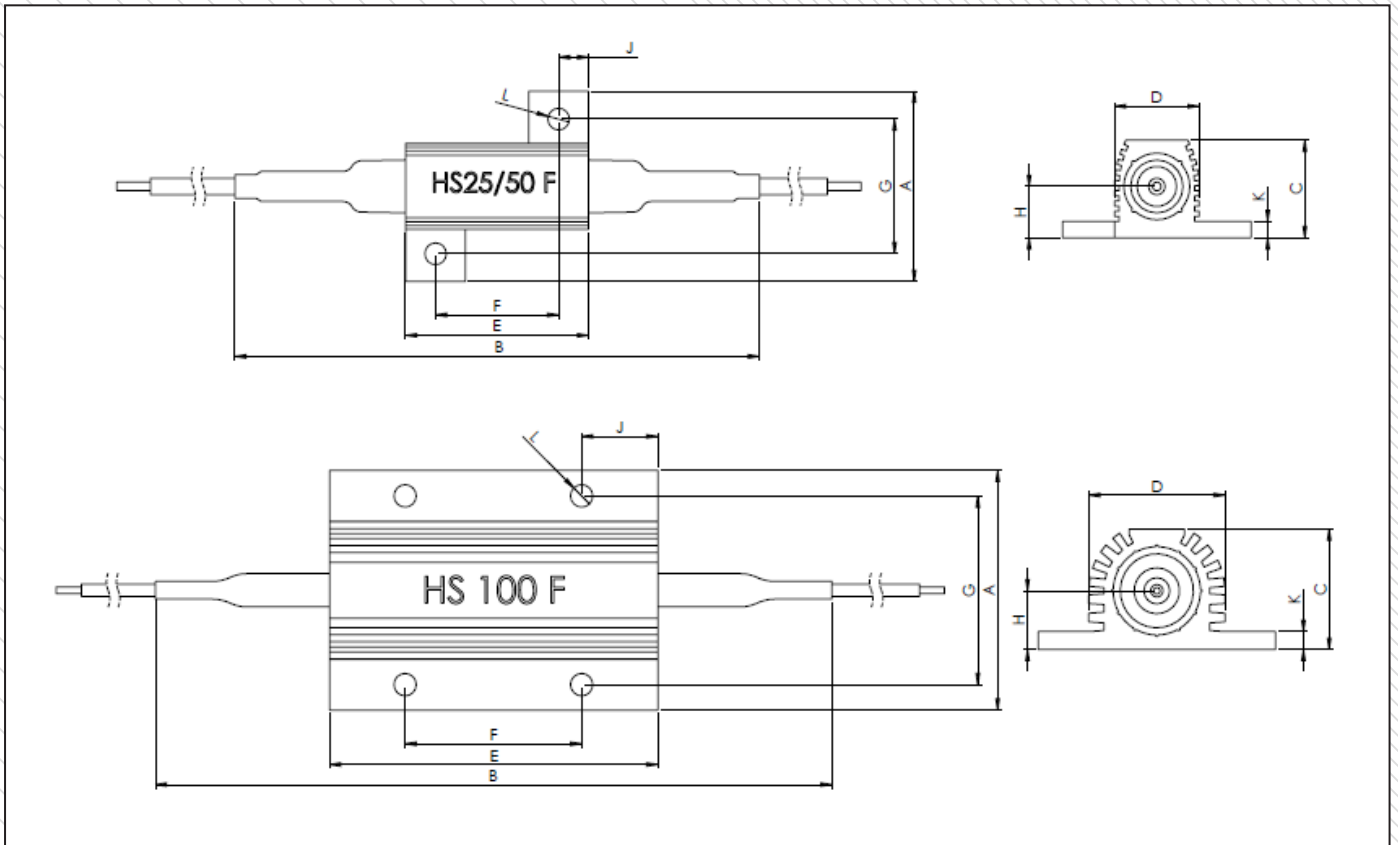

Dimensions (mm)

Size	A Max	B Max	C Max	D Max	E Max	F±0.3	G±0.3	H Max	J Max	K Max	L ±0.25*
HS25F	28.0	82.0	14.8	14.2	27.3	18.3	19.8	7.7	5.2	2.6	3.2
HS50F	28.0	104.0	14.8	14.2	49.1	39.7	21.4	8.4	5.2	2.6	3.2
HS100F	47.5	140.0	24.1	27.3	65.2	35.0	37.0	11.8	15.4	3.7	4.4

Mouser Electronics

Authorized Distributor

Click to View Pricing, Inventory, Delivery & Lifecycle Information:

Ohmite:

[HS50F 330R J](#) [HS100F 50R F](#) [HS100F 1K F](#) [HS100F 1K5 F](#) [HS100F 1R F](#) [HS100F 1R5 F](#) [HS100F 220R F](#)
[HS25F 4R F](#) [HS25F 4R7 F](#) [HS25F 50R F](#) [HS100F 10K F](#) [HS100F 10R F](#) [HS100F 12R F](#) [HS100F 150R F](#) [HS100F](#)
[15R F](#) [HS25F 4K7 F](#) [HS50F R05 J](#) [HS50F R1 J](#) [HS50F 25R F](#) [HS50F 27R F](#) [HS50F 2K2 F](#) [HS100F 100R F](#)
[HS50F 5R6 F](#) [HS50F 68R F](#) [HS50F 6R F](#) [HS50F 6R8 F](#) [HS50F 8R F](#) [HS50F 8R2 F](#) [HS50F 4R F](#) [HS50F 4R7 F](#)
[HS50F 50K F](#) [HS50F 50R F](#) [HS50F 56R F](#) [HS50F 5R F](#) [HS50F 3R3 F](#) [HS50F 3R9 F](#) [HS50F 470R F](#) [HS50F 47K F](#)
[HS50F 47R F](#) [HS50F 4K7 F](#) [HS50F 2R2 F](#) [HS50F 30R F](#) [HS50F 330R F](#) [HS50F 33R F](#) [HS50F 3K3 F](#) [HS50F 3R](#)
[F](#) [HS100F 8R F](#) [HS100F R1 J](#) [HS100F R22 J](#) [HS100F R47 J](#) [HS100F R5 J](#) [HS25F 100R F](#) [HS50F 20R F](#) [HS50F](#)
[220R F](#) [HS50F 22K F](#) [HS50F 22R F](#) [HS50F 24R F](#) [HS100F 6R8 F](#) [HS50F 18R F](#) [HS50F 1K F](#) [HS50F 1K2 F](#)
[HS50F 1K5 F](#) [HS50F 1R F](#) [HS50F 1R5 F](#) [HS50F 10K F](#) [HS50F 10R F](#) [HS50F 120R F](#) [HS50F 12R F](#) [HS50F 150R](#)
[F](#) [HS50F 15R F](#) [HS25F 5R F](#) [HS25F 68R F](#) [HS25F 6R8 F](#) [HS25F 8R F](#) [HS25F 8R2 F](#) [HS50F 100R F](#) [HS25F 470R](#)
[F](#) [HS25F 47R F](#) [HS25F 56R F](#) [HS50F 2R F](#) [HS50F R22 J](#) [HS50F R5 J](#) [HS25F 2K2 F](#) [HS25F 2R F](#) [HS25F 2R2 F](#)
[HS25F 33R F](#) [HS25F 39R F](#) [HS25F 3R3 F](#) [HS25F 1R F](#) [HS25F 1R5 F](#) [HS25F 220R F](#) [HS25F 22R F](#) [HS25F 24R F](#)
[HS25F 27R F](#) [HS25F 150R F](#) [HS25F 15K F](#) [HS25F 15R F](#) [HS25F 16R F](#) [HS25F 18R F](#) [HS25F 1K F](#)