

3

CABLE LENGTH TABLE
FINISHED LENGTH \pm 2% TOTAL

| MARK | PART NO | REV | 'L' |
|--------------|---------|-----|---------------|
| 3004-304-1M | B | | 1M (3.3 FT) |
| 3004-304-3M | B | | 3M (9.84 FT) |
| 3004-304-5M | B | | 5M (16.4 FT) |
| 3004-304-10M | B | | 10M (32.8 FT) |

APPLIED MOTION PRODUCTS
3004-304-3M B

LABEL DETAIL B

REVISIONS

| REV | DESCRIPTION | DATE | APPROVED |
|-----|-----------------------------|---------|----------|
| A | INITIAL RELEASE ECO 7263 | 8/24/15 | J KORDIK |
| B | REVISE RoHS NOTE - ECO 7451 | 6/13/16 | J KORDIK |
| | | | |
| | | | |

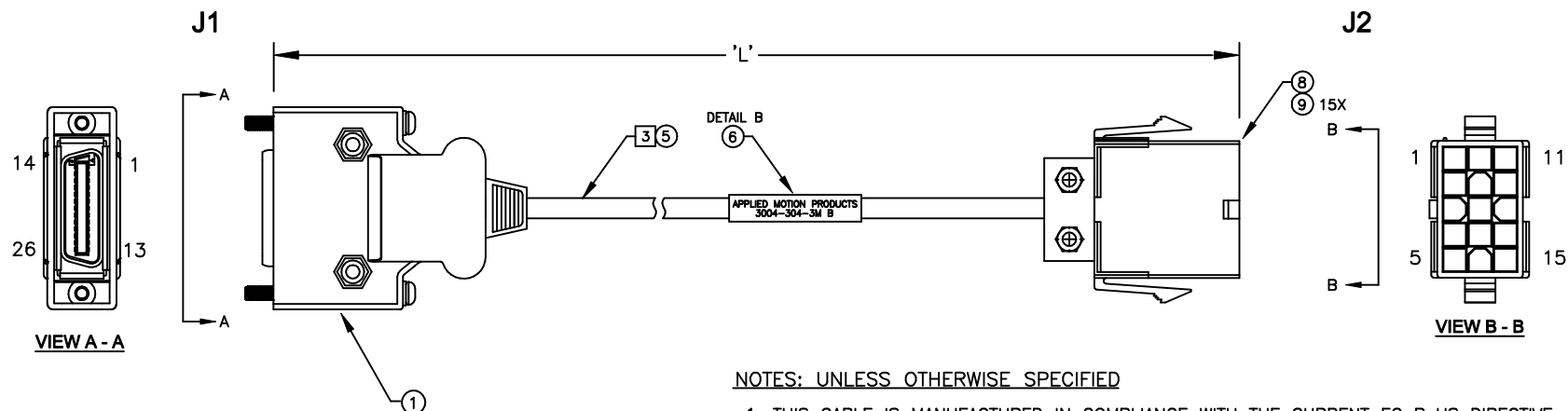

NOTES: UNLESS OTHERWISE SPECIFIED

- THIS CABLE IS MANUFACTURED IN COMPLIANCE WITH THE CURRENT EC RoHS DIRECTIVE.
- THIS CABLE INTENDED FOR USE WITH J-SERIES SERVO MOTORS AND SV200 SERIES SERVO DRIVES.
- FOR CABLES LONGER THAN THESE, USE RAW CABLE 666-2121.
- STRAIN RELIEF AT CONNECTORS WILL VARY.

CABLE CONNECTIONS

| J1 | J2 | SIGNAL | WIRE COLOR |
|----|----|--------|------------|
| 11 | 1 | +5V | RED |
| 24 | 2 | GND | BLK |
| 4 | 3 | U+ | BRN |
| 6 | 4 | U- | BRN/BLK |
| 17 | 5 | V+ | GRY |
| 19 | 6 | V- | GRY/BLK |
| 5 | 7 | W+ | WHT |
| 7 | 8 | W- | WHT/BLK |
| 1 | 9 | A+ | BLU/BLK |
| 14 | 10 | A- | BLU |
| 2 | 11 | B+ | GRN |
| 15 | 12 | B- | GRN/BLK |
| 3 | 13 | Z+ | YEL |
| 16 | 14 | Z- | YEL/BLK |
| - | 15 | DRAIN | SHIELD |

BILL OF MATERIALS

| ITEM | PART NUMBER | DESCRIPTION | QTY | UOM | MFR |
|------|--------------------|---|-----|-----|-------------------|
| 1 | 3-2232346-1 | CONNECTOR, SCSi 26 POSITION | 1 | EA | TYCO OR EQUIV. |
| 2 | | | | | |
| 3 | | | | | |
| 4 | | | | | |
| 5 | 666-2121 OR EQUIV. | CABLE, 7 PAIRS 28 AWG, SHIELDED, PVC JACKET | A/R | | UL 2574 OR EQUIV. |
| 6 | DAT-35-292-1 | LABEL, 1.875" X 3.167" | 1 | EA | BRADY OR EQUIV. |
| 7 | | | | | |
| 8 | 172163-1 | HOUSING, CONNECTOR | 1 | EA | AMP |
| 9 | 770834-1 | TERMINALS, CRIMP | 15 | EA | AMP |

TOLERANCES

DECIMALS: MM (INCH)
X.XXX = ± 0.013 (.005)
X.XX = ± 0.25 (.01)
X.X = ± 2.5 (0.1)
ANGLES:
MACH. = $\pm .5^\circ$
CHAM. = $\pm 5^\circ$

THIRD ANGLE PROJECTION

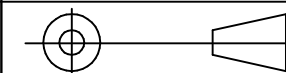

| APPROVALS | DATE |
|---------------|--------|
| DRAWN R.JONEZ | 8/3/15 |
| CHECKED | |
| APPROVED | |

ENCODER CABLE,
J-SERIES SERVO MOTORS

B DWG NO. 3004-304-XXX REV B

SCALE: NONE

SHEET 1 OF 1

Mouser Electronics

Authorized Distributor

Click to View Pricing, Inventory, Delivery & Lifecycle Information:

Applied Motion:

[3004-304-1M](#) [3004-304-3M](#) [3004-304-5M](#) [3004-304-10M](#)