

3

CABLE LENGTH TABLE
FINISHED LENGTH \pm 2% TOTAL

MARK	PART NO	REV	'L'
3004-304-1M	B		1M (3.3 FT)
3004-304-3M	B		3M (9.84 FT)
3004-304-5M	B		5M (16.4 FT)
3004-304-10M	B		10M (32.8 FT)

APPLIED MOTION PRODUCTS
3004-304-3M B

LABEL DETAIL B

REVISIONS

REV	DESCRIPTION	DATE	APPROVED
A	INITIAL RELEASE ECO 7263	8/24/15	J KORDIK
B	REVISE RoHS NOTE - ECO 7451	6/13/16	J KORDIK

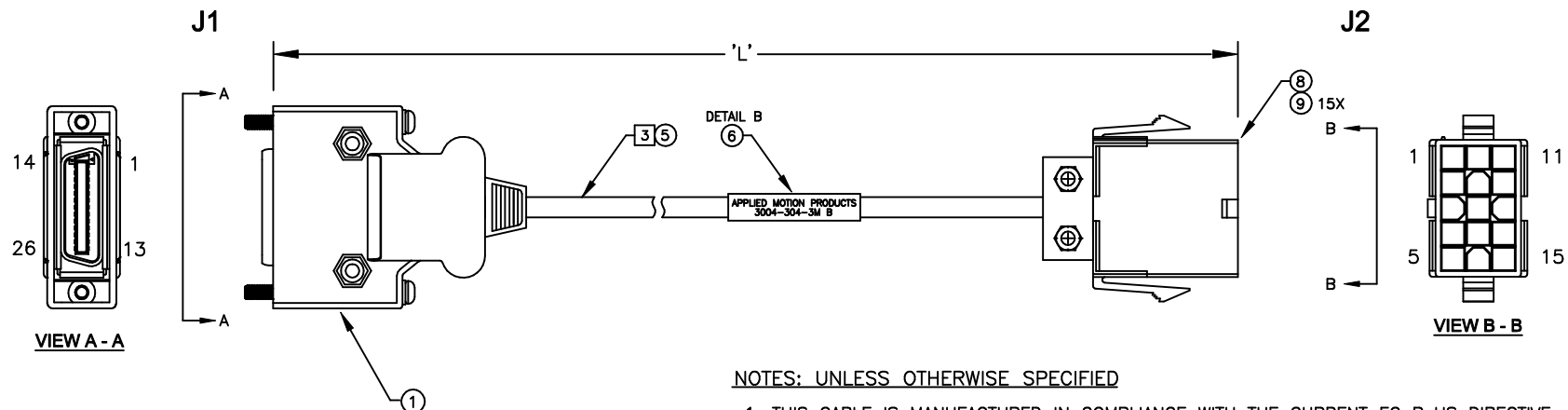

NOTES: UNLESS OTHERWISE SPECIFIED

- THIS CABLE IS MANUFACTURED IN COMPLIANCE WITH THE CURRENT EC RoHS DIRECTIVE.
- THIS CABLE INTENDED FOR USE WITH J-SERIES SERVO MOTORS AND SV200 SERIES SERVO DRIVES.
- FOR CABLES LONGER THAN THESE, USE RAW CABLE 666-2121.
- STRAIN RELIEF AT CONNECTORS WILL VARY.

CABLE CONNECTIONS

J1	J2	SIGNAL	WIRE COLOR
11	1	+5V	RED
24	2	GND	BLK
4	3	U+	BRN
6	4	U-	BRN/BLK
17	5	V+	GRY
19	6	V-	GRY/BLK
5	7	W+	WHT
7	8	W-	WHT/BLK
1	9	A+	BLU/BLK
14	10	A-	BLU
2	11	B+	GRN
15	12	B-	GRN/BLK
3	13	Z+	YEL
16	14	Z-	YEL/BLK
-	15	DRAIN	SHIELD

BILL OF MATERIALS

ITEM	PART NUMBER	DESCRIPTION	QTY	UOM	MFR
1	3-2232346-1	CONNECTOR, SCSi 26 POSITION	1	EA	TYCO OR EQUIV.
2					
3					
4					
5	666-2121 OR EQUIV.	CABLE, 7 PAIRS 28 AWG, SHIELDED, PVC JACKET	A/R		UL 2574 OR EQUIV.
6	DAT-35-292-1	LABEL, 1.875" X 3.167"	1	EA	BRADY OR EQUIV.
7					
8	172163-1	HOUSING, CONNECTOR	1	EA	AMP
9	770834-1	TERMINALS, CRIMP	15	EA	AMP

TOLERANCES

DECIMALS: MM (INCH)
X.XXX = ± 0.013 (.005)
X.XX = ± 0.25 (.01)
X.X = ± 2.5 (0.1)
ANGLES:
MACH. = $\pm .5^\circ$
CHAM. = $\pm 5^\circ$

THIRD ANGLE PROJECTION

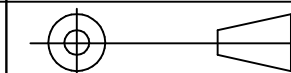

APPROVALS

DATE

DRAWN R.JONEZ

8/3/15

CHECKED

APPROVED

COMPUTER DATA
BASE DRAWINGAPPLIED
MOTION
PRODUCTS, INC.ENCODER CABLE,
J-SERIES SERVO MOTORS

B

DWG NO.

3004-304-XXX

REV B

SCALE: NONE

SHEET 1 OF 1

Mouser Electronics

Authorized Distributor

Click to View Pricing, Inventory, Delivery & Lifecycle Information:

[Applied Motion:](#)

[3004-304-1M](#)