

Molded SMD Power Inductor

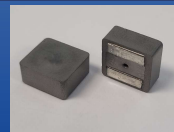

ASPI-F4030

Request Samples



Check Inventory



4.1 x 4.1 x 2.8mm

RoHS/RoHS II Compliant

MSL Level = 1

Features

- Shielded construction
- Soft saturation
- Low DCR, High Efficiency
- High temperature current rating

Applications

- Body electronics and comfort system
- Infotainment and entertainment
- Electric vehicles
- Lighting
- Solar inverters and power
- Industrial and robotics
- Medium and high-power switch mode power supplies.

Electrical Specifications

Part Number	Inductance	Tolerance	DC Resistance		Saturation Current	Temperature Rise Current
	0.1MHz/1.0V		Max	Typ.	Typ.	Typ.
Units	μH	%	mΩ		A	A
Symbol	L	M	DCR		Isat	Irms
ASPI-F4030-R47M-T	0.47	20	7.26	6.4	17	14
ASPI-F4030-R90M-T	0.9	20	10.1	8.9	10	11.2
ASPI-F4030-1R0M-T	1.0	20	10.1	8.9	9.8	11
ASPI-F4030-1R2M-T	1.2	20	11.5	10.1	9.2	9.8
ASPI-F4030-1R5M-T	1.5	20	13.2	11.6	8	9
ASPI-F4030-2R2M-T	2.2	20	22.6	20	7.0	7.8
ASPI-F4030-3R3M-T	3.3	20	28.6	25.3	6.2	6.6
ASPI-F4030-4R7M-T	4.7	20	44.1	38.8	4.5	5.1
ASPI-F4030-6R8M-T	6.8	20	74.1	65.2	3.6	3.9

Test Conditions

Isat: DC current at which the inductance drops 30% from its value without current.

Irms: DC current that causes the temperature rise (ΔT , approximate 40 °C) from 25°C ambient.

Operating Temperature: -55°C ~ +125°C (including self-temperature rise)

Storage Condition: -55°C ~ +125°C (on board), -10°C ~ +40°C (with packaging) and R.H. 70% max

ASPI-F4030 Series is **RoHS Compliant and Pb free**

Molded SMD Power Inductor

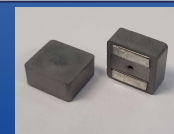

ASPI-F4030

Request Samples



Check Inventory



4.1 x 4.1 x 2.8mm
RoHS/RoHS II Compliant
MSL Level = 1

Part Identification

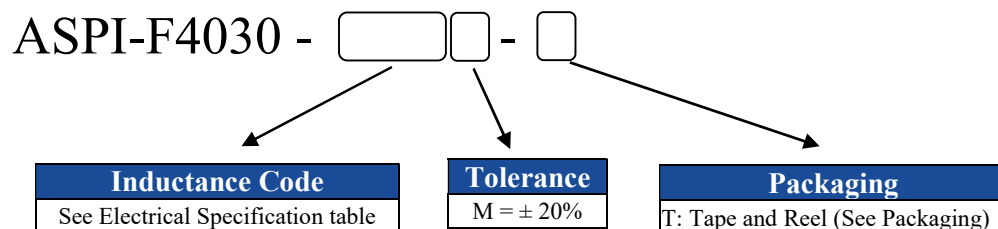

Marking

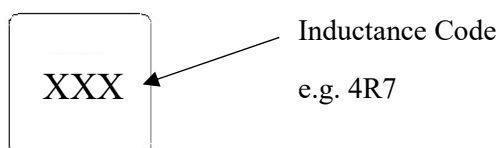

Marking Method = Ink Marking

Mechanical Specifications

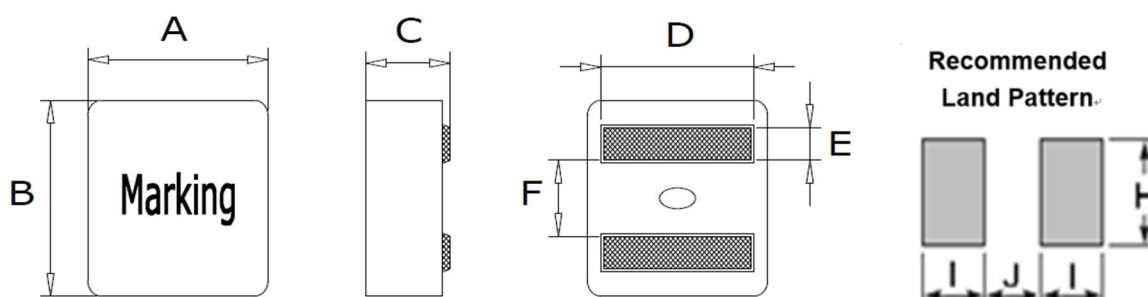

Series	A	B	C	D	E	F	I	H	J
ASPI-F4030	4.1 \pm 0.25	4.1 \pm 0.25	2.8 \pm 0.2	3.4 \pm 0.3	.88 \pm 0.3	1.7 \pm 0.3	1.0 Typ.	3.8 Typ.	1.4 Typ.

Dimensions: mm

Molded SMD Power Inductor

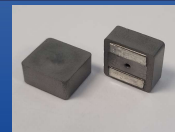

ASPI-F4030

Request Samples



Check Inventory



4.1 x 4.1 x 2.8mm
RoHS/RoHS II Compliant
MSL Level = 1

Reflow Profile

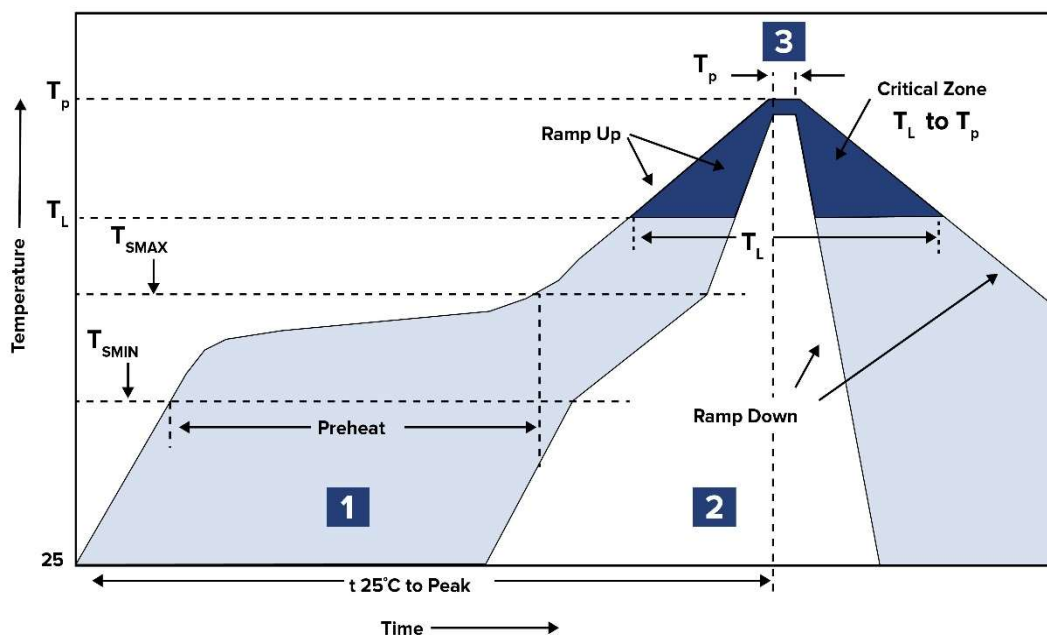

Zone	Description	Temperature	Times
1	Preheat	$T_{SMIN} \sim T_{SMAX}$ 150°C ~ 200°C	60 ~ 120 sec.
2	Reflow	T_L 217°C	60 ~ 90 sec.
3	Peak heat	T_p 260°C	10 sec. MAX

Molded SMD Power Inductor

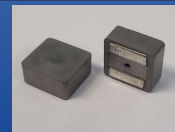

ASPI-F4030

Request Samples



Check Inventory



4.1 x 4.1 x 2.8mm
RoHS/RoHS II Compliant
MSL Level = 1

Packaging

Tape & Reel: 2000 pcs/reel

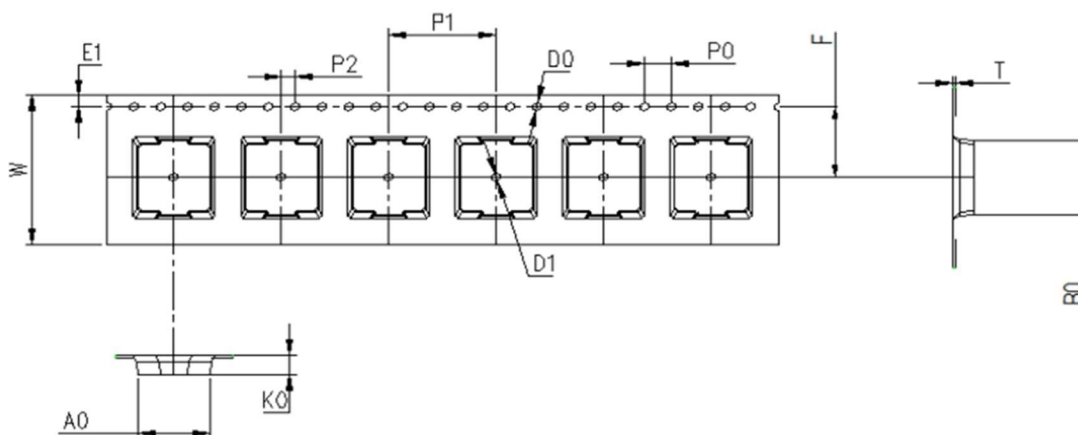

A0	B0	K0	P0	P1	P2	W	T	D0	F	E1
4.4	4.4	3.30	4.00	8.00	2.0	12.00	0.3	1.50	5.5	1.75

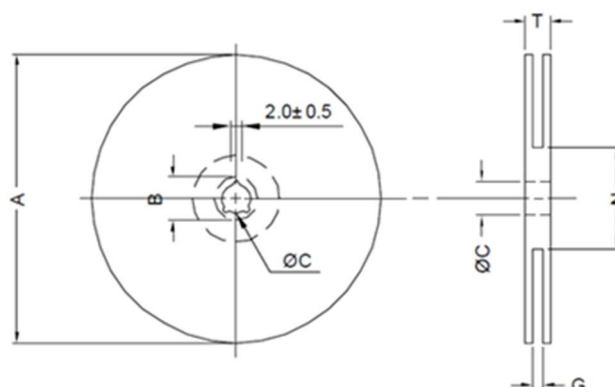

A	C	G	N	T
330.0 ± 2.0	13.0 ± 0.5	12.4 ± 1.0	100.0 ± 1.0	18.4 Max

Dimensions: mm

ATTENTION: Abracon LLC's products are COTS – Commercial-Off-The-Shelf products; suitable for Commercial, Industrial and, where designated, Automotive Applications. Abracon's products are not specifically designed for Military, Aviation, Aerospace, Life-dependent Medical applications or any application requiring high reliability where component failure could result in loss of life and/or property. For applications requiring high reliability and/or presenting an extreme operating environment, written consent and authorization from Abracon LLC is required. Please contact Abracon LLC for more information.



5101 Hidden Creek Ln Spicewood TX 78669
 Phone: 512-371-6159 | Fax: 512-351-8858
 For terms and conditions of sales, please visit:
www.abracon.com

REVISION: A 06-20-24

ABRACON IS
 ISO9001-2015
 CERTIFIED

Mouser Electronics

Authorized Distributor

Click to View Pricing, Inventory, Delivery & Lifecycle Information:

[ABRACON:](#)

[ASPI-F4030-100M-T](#) [ASPI-F4030-120M-T](#) [ASPI-F4030-1R0M-T](#) [ASPI-F4030-1R2M-T](#) [ASPI-F4030-1R5M-T](#) [ASPI-F4030-2R2M-T](#) [ASPI-F4030-3R3M-T](#) [ASPI-F4030-4R7M-T](#) [ASPI-F4030-5R6M-T](#) [ASPI-F4030-6R8M-T](#) [ASPI-F4030-8R2M-T](#) [ASPI-F4030-R13M-T](#) [ASPI-F4030-R27M-T](#) [ASPI-F4030-R30M-T](#) [ASPI-F4030-R40M-T](#) [ASPI-F4030-R47M-T](#)
[ASPI-F4030-R62M-T](#) [ASPI-F4030-R76M-T](#)