

THIS IS A C.A.D. GENERATED DRAWING
DO NOT MAKE MANUAL REVISIONS TO MASTER.



* UNLESS OTHERWISE SPECIFIED TOLERANCES
ON DECIMAL IS:
UNIT: MM

BACKSHELL KIT INCLUDES:

- (2)BACKSHELL HALVES
- (2)CLAMPS
- (2)CLAMP SCREWS
- (2)SHELL SCREWS
- (2)JACKSCREWS

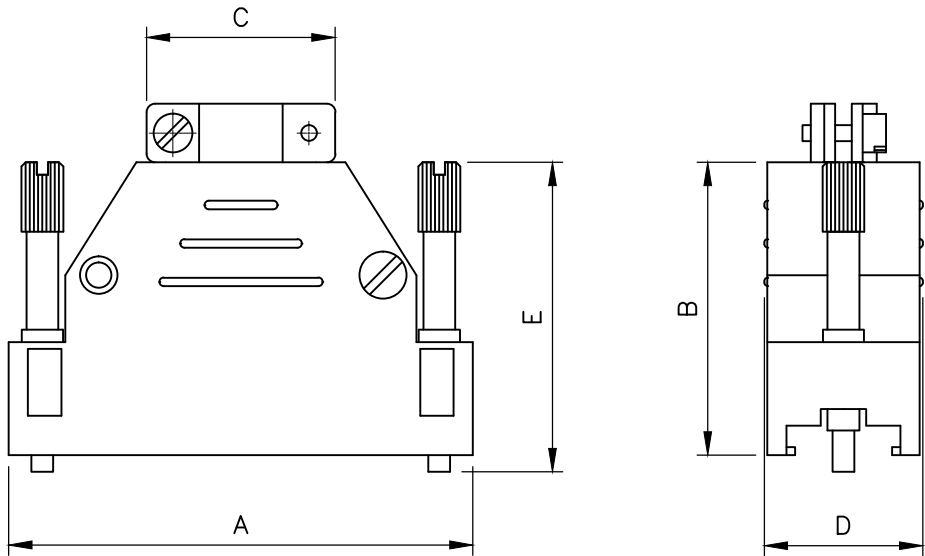

DIMENSIONS(mm)					
SIZE	A±1.0	B±1.0	C±0.6	D±0.8	E±0.6
09	31.4	24.0	16.1	18.2	38.0
15	42.0	30.0	21.1	18.2	38.0
25	55.5	36.0	24.0	18.2	38.0
37	69.8	38.0	30.7	18.2	38.0

Ordering information: Male Jackscrew

SIZE	P/N-Kitted	Product Code
9-WAY, Male JS	2801-0106-01	MHED-MD09T-K
15-WAY, Male JS	2801-0106-02	MHED-MD15T-K
25-WAY, Male JS	2801-0106-03	MHED-MD25T-K
37-WAY, Male JS	2801-0106-04	MHED-MD37T-K

BACKSHELL MATERIAL: ABS (METALLISED)
SCREWS: STEEL, ZINC PLATED

THESE DRAWINGS AND SPECIFICATIONS ARE THE
PROPERTY OF MH CONNECTORS LTD. AND SHALL NOT
BE REPRODUCED, COPIED OR USED AS THE BASIS FOR
THE MANUFACTURE OR SALE OF APPARATUS WITHOUT
WRITTEN PERMISSION.

DRAWN HALEY		DATE 07-29-14
APPROVED		DATE



THIS SERIES FULLY CONFORMS TO THE
EUROPEAN UNION DIRECTIVES 2002/95/EC
AND 2002/96/EC FOR RoHS COMPLIANCY.



MH CONNECTORS LTD.

SCALE NTS	SHEET OF 1 OF 1	REV: 2.0
DRAWING No MHED-MDXXT		

Mouser Electronics

Authorized Distributor

Click to View Pricing, Inventory, Delivery & Lifecycle Information:

[NorComp:](#)

[MHED-MD09T-K](#) [MHED-MD37T-K](#) [MHED-MD25T-K](#) [MHED-MD15T-K](#)