

MATERIAL:
BACKSHELL: NICKEL PLATED DIE-CAST ZINC ALLOY
HARDWARE: NICKEL PLATED STEEL
OPERATION TEMPERATURE: -40°C to 120°C

BACKSHELL KIT INCLUDES:
(2x) BACKSHELL HALVES
(2x) HOUSING SCREWS
(2x) HOUSING NUTS
(2x) STRAIN RELIEF CLAMPS
(2x) STRAIN RELIEF SCREWS

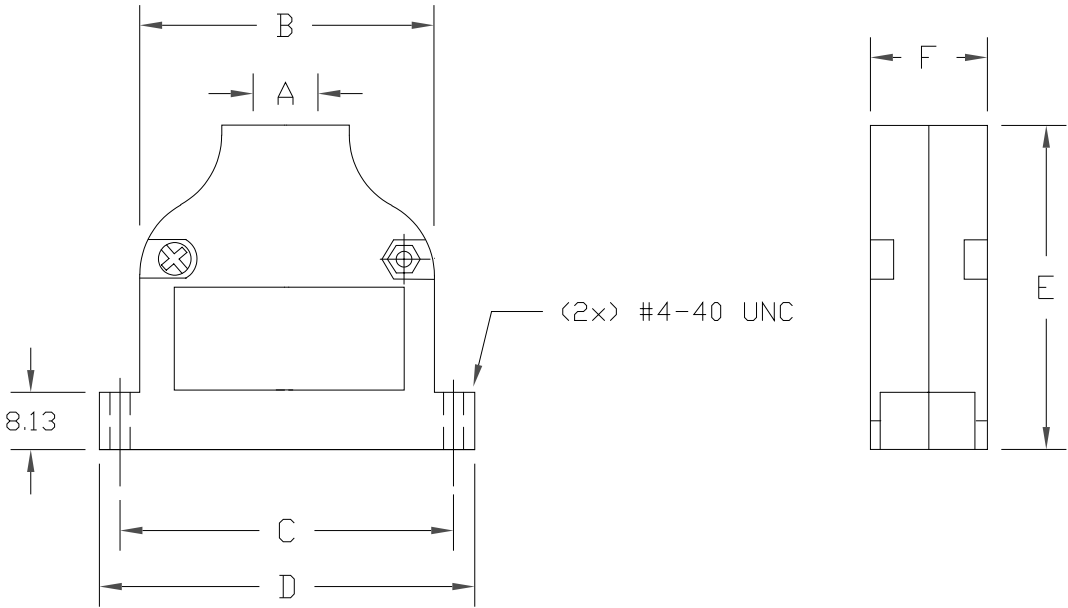

DIMENSIONS(mm) [All tolerances ±0.5mm]						
SIZE	A	B	C	D	E	F
9	11.00	20.07	24.99	31.80	46.00	16.00
15	11.00	28.83	33.32	40.00	46.00	16.90
25	11.00	41.66	47.04	53.50	46.00	16.10

994-YYY-030R121

SERIES _____
POSITIONS _____
009
015
025

RoHS COMPLIANT



THESE DRAWINGS AND SPECIFICATIONS ARE THE PROPERTY OF NorComp AND SHALL NOT BE REPRODUCED, COPIED OR USED AS THE BASIS FOR THE MANUFACTURE OR SALE OF APPARATUS WITHOUT WRITTEN PERMISSION.

DRAWN: P. JENKINS
DATE: 09/15/2005

UNITS = mm DO NOT SCALE FROM DRAWING

NorComp

SCALE: NTS
DWG NO. 994-0YY-030R121

SHEET 1 OF 1
REV 6

Mouser Electronics

Authorized Distributor

Click to View Pricing, Inventory, Delivery & Lifecycle Information:

[NorComp:](#)

[994-009-030R121](#) [994-015-030R121](#) [994-025-030R121](#)