

SPECIFICATIONS:

MATERIALS:

METALIZED PLASTIC:

MATERIAL: ABS HIGH TEMP PLASTIC 94HB

METALIZED PLATING: CHROME

PLASTIC:

MATERIAL: ABS HIGH TEMP PLASTIC 94HB

BACKSHELL KIT INCLUDES:

- (2) BACKSHELL HALVES
- (2) HOUSING SCREWS
- (2) HOUSING NUTS
- (2) #4-40 THUMBSCREWS
- (2) STRAIN RELIEF CLAMPS
- (2) STRAIN RELIEF SCREWS

**ASSEMBLY SCREW SIZE #4-40.
RECOMMENDED TORQUE 4 IN-LBS. MAX**

993-025-YYYRYY1

SERIES _____
MATERIAL _____
010 = PLASTIC
020 = METALIZED PLASTIC
COLOR _____
03 = GREY (ONLY AVAILABLE WITH 010 - PLASTIC OPTION ABOVE)
12 = CHROME (ONLY AVAILABLE WITH 020 - METALIZED PLASTIC ABOVE)

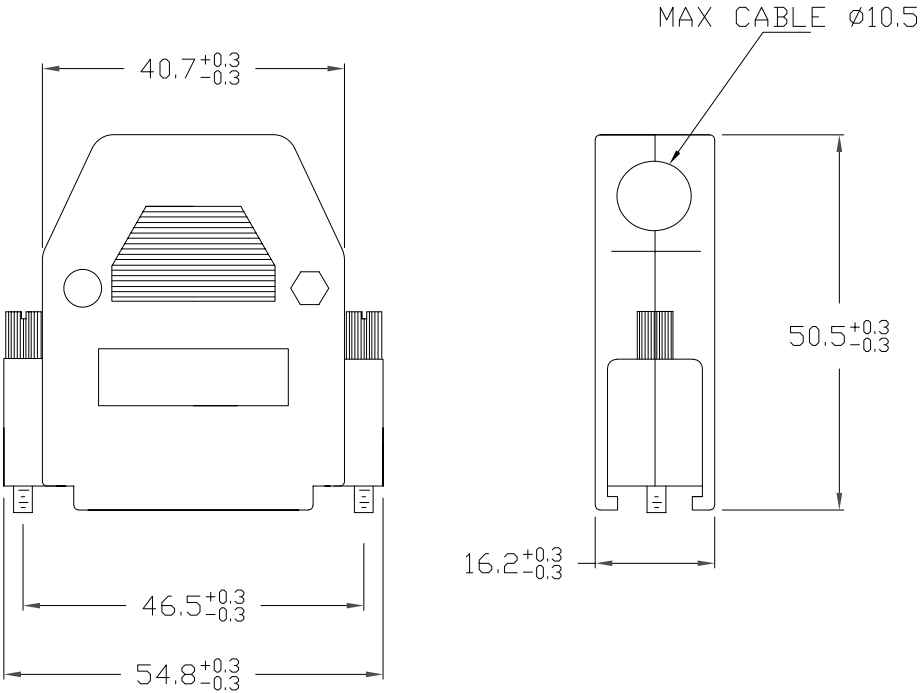

RoHS COMPLIANT



THESE DRAWINGS AND SPECIFICATIONS ARE THE PROPERTY OF NorComp AND SHALL NOT BE REPRODUCED, COPIED OR USED AS THE BASIS FOR THE MANUFACTURE OR SALE OF APPARATUS WITHOUT WRITTEN PERMISSION.

DRAWN:
P. JENKINS

DATE:
09/15/2005

UNITS = mm

DO NOT SCALE FROM DRAWING

NorComp

SCALE:
NTS

SHEET OF
1 1

REV
3

DWG NO.

993-025-YYYRYY1

Mouser Electronics

Authorized Distributor

Click to View Pricing, Inventory, Delivery & Lifecycle Information:

NorComp:

[993-025-010R031](#) [993-025-020R121](#)