

BACKSHELL KIT INCLUDES:

- (2) BACKSHELL HALVES
- (2) HOUSING SCREWS
- (2) HOUSING NUTS
- (2) 4-40 MOUNTING SCREWS
- (2) SADDLE WASHERS
- (2) STRAIN RELIEF CLAMPS
- (2) STRAIN RELIEF SCREWS

METALIZED PLASTIC:

- MATERIAL: ABS HIGH TEMPERATURE PLASTIC UL94HB
- METALIZED PLATING: NICKEL OVER COPPER
- OPERATING TEMP: -35°C TO 85°C

PLASTIC:

- MATERIAL: ABS HIGH TEMPERATURE PLASTIC UL94HB
- OPERATING TEMP: -35°C TO 85°C

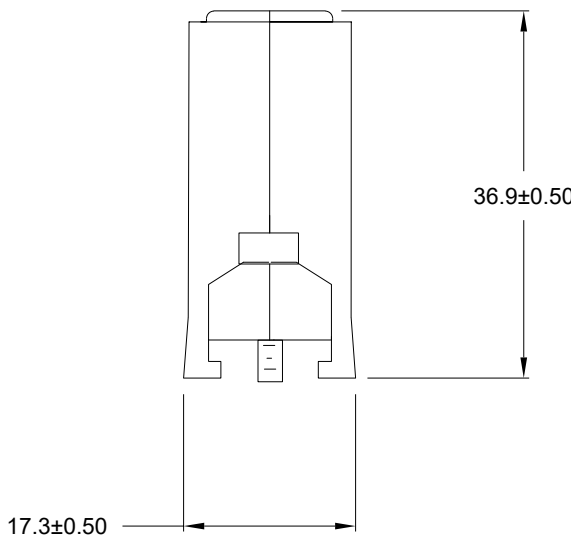
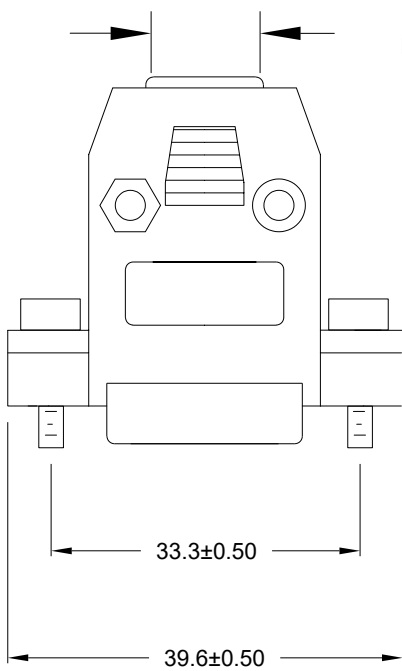

977-015-0Y0 R YY 1

SERIES _____
POSITIONS _____
015 _____
MATERIAL _____
010 = PLASTIC
020 = METALIZED PLASTIC
RoHS COMPLIANT _____
COLOR _____
03 = GREY (ONLY USE WITH 010 OPTION ABOVE)
12 = METALIZED (ONLY USE WITH 020 OPTION ABOVE)
PUT-UP _____
1 = KIT

RoHS COMPLIANT

DRAWN:
J. KADEL
DATE:
08/22/2019

UNITS = mm DO NOT SCALE FROM DRAWING

SCALE: NTS	SHEET 1 OF 1	REV 1
DWG NO. 977-015-0Y0RYY1		



THESE DRAWINGS AND SPECIFICATIONS ARE THE PROPERTY OF NorComp AND SHALL NOT BE REPRODUCED, COPIED OR USED AS THE BASIS FOR THE MANUFACTURE OR SALE OF APPARATUS WITHOUT WRITTEN PERMISSION.

Mouser Electronics

Authorized Distributor

Click to View Pricing, Inventory, Delivery & Lifecycle Information:

NorComp:

[977-015-010R031](#) [977-015-020R121](#)