

SPECIFICATIONS:

MATERIALS:

HOUSING:	TPU, BLACK
CONTACTS:	GOLD PLATED BRASS
NUT:	NICKEL PLATED BRASS
SHELL:	NICKEL PLATED BRASS
ORING:	EPDM

ELECTRICAL:

RATED CURRENT:	2A
RATED VOLTAGE:	30V
INSULATION RESISTANCE:	100 MOhms MIN.
CONTACT RESISTANCE:	10 mOhms MAX.

ENVIRONMENT:

OPERATING TEMPERATURE:	-40°C TO +85°C
WATER PROOF:	IP67

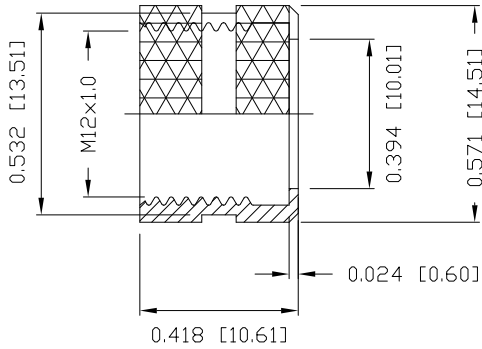
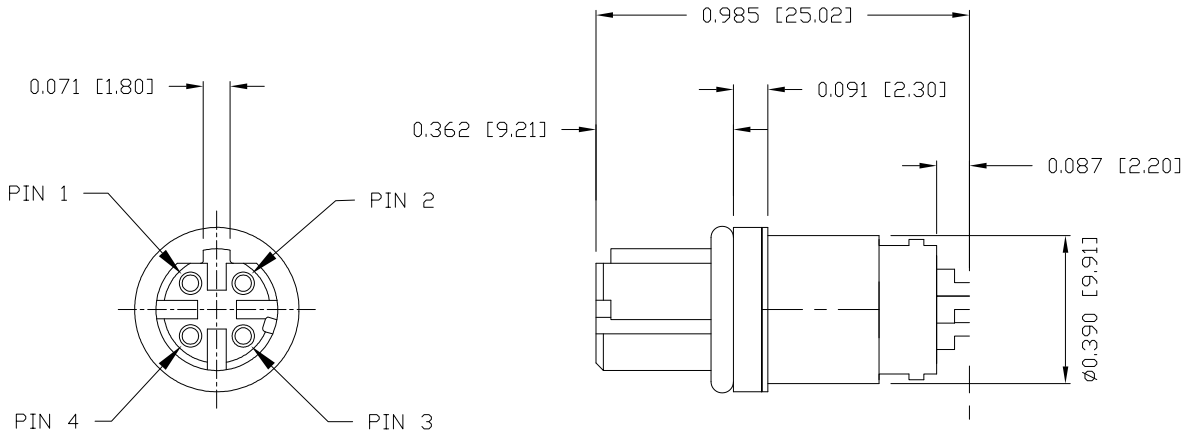

NUT

858-D04-203RSSY

- 3 = BRASS/NICKEL (B/N) SHELL & NUT
- S = STAINLESS STEEL (SS) SHELL & NUT
- T = B/N SHELL / SS NUT

- 1 = GOLD FLASH
- 4 = 10u" GOLD

RoHS COMPLIANT

DRAWN:	M. SIGMON
DATE:	05/13/2016

UNITS = inch [mm]

DO NOT SCALE FROM DRAWING



THESE DRAWINGS AND SPECIFICATIONS ARE THE PROPERTY OF NorComp AND SHALL NOT BE REPRODUCED, COPIED OR USED AS THE BASIS FOR THE MANUFACTURE OR SALE OF APPARATUS WITHOUT WRITTEN PERMISSION.

NorComp

SCALE:	NTS	SHEET	OF	REV
		1	1	4
DWG NO.	858-D04-203RSSY			

Mouser Electronics

Authorized Distributor

Click to View Pricing, Inventory, Delivery & Lifecycle Information:

NorComp:

[858-D04-203RSS4](#) [858-D04-203RSS1](#) [858-D04-20SRSS4](#) [858-D04-20TRSS4](#)