

DESCRIPTION: 7W2 // M // COAXIAL // PCB MOUNT

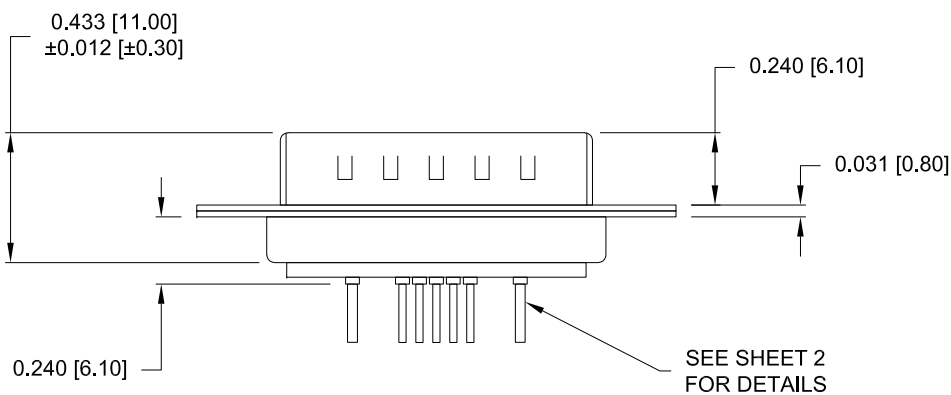
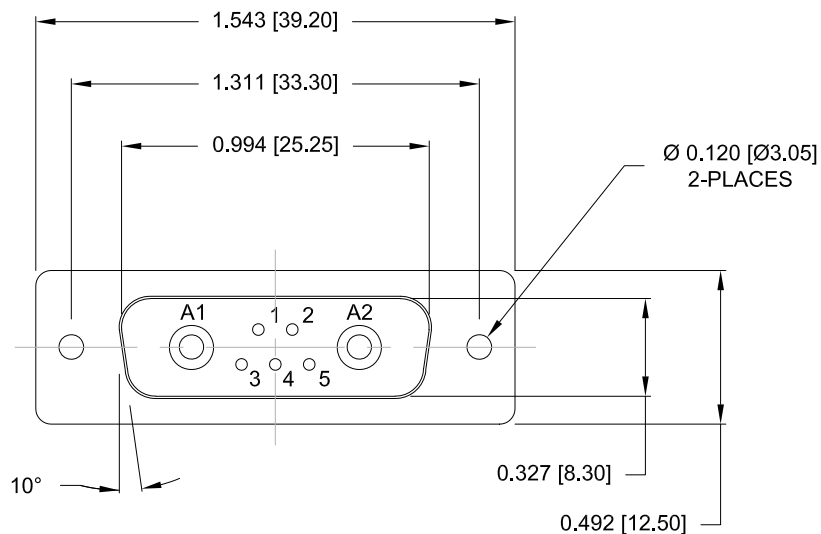

SPECIFICATIONS:

ELECTRICAL:

INSULATOR RESISTANCE:	5 GOHMS Min.
DIELECTRIC WITHSTANDING:	1,000VAC r.m.s.
OPERATING TEMPERATURE:	-55° C ~ +125° C
SIGNAL CONTACT RESISTANCE:	10 MillioHMS Max.
COAXIAL CONTACT RESISTANCE:	2.7 MillioHMS Max.
COAXIAL PINS:	50 OHM
SIGNAL CONTACT CURRENT RATING:	5 AMPS

MECHANICAL:

CONTACT INSERTION FORCE: 4.5 Kg Max.
CONTACT SEPARATOR FORCE: 0.3Kg Min.

MATERIALS:

CONTACTS:	BRASS
INSULATOR:	PBT UL94V-0 RATED, 230°C PROCESS TEMP.
SHELL:	STEEL

SHELL:

FINISH:

SHELL: NICKEL
CONTACTS: FULL GOLD FLASH

683M7W2103LYYY

0 = 50 OHM

1 = Gold Flash

0 = NO HARDWARE

1 = 0.098" CN PCB SIDE

2 = 0.236" CN PCB SIDE

3 = 0.236" CN MATING SIDE

4 = 0.237" BOARDLOCK PCB SIDE

5 = 0.224" BOARDLOCK PCB SIDE

RoHS COMPLIANT



THESE DRAWINGS AND SPECIFICATIONS ARE THE PROPERTY OF NorComp AND SHALL NOT BE REPRODUCED, COPIED OR USED AS THE BASIS FOR THE MANUFACTURE OR SALE OF APPARATUS WITHOUT WRITTEN PERMISSION.

DRAWN:

M. SIGMON

DATE:

03/13/2015

UNITS = INCHES [MM] DO NOT SCALE FROM DRAWING

NorComp

SCALE:
NTS

SHEET 1 OF 3

REV
2

DWG NO:	683M7W2103L YYY
---------	-----------------

DESCRIPTION: 7W2 // M // COAXIAL // PCB MOUNT

NOTE:
COAXIAL CONTACTS COME
PRE-LOADED INTO INSULATORS

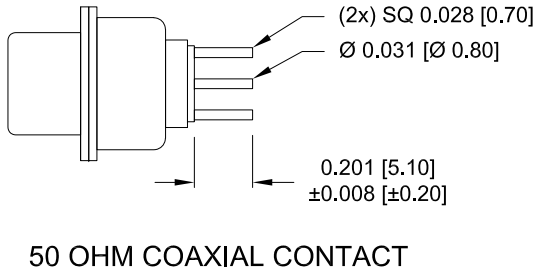
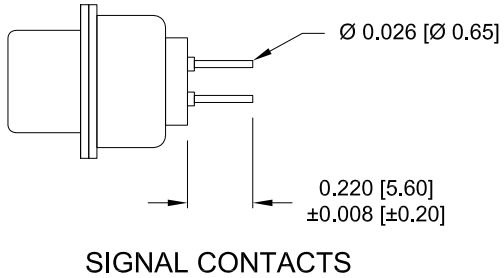
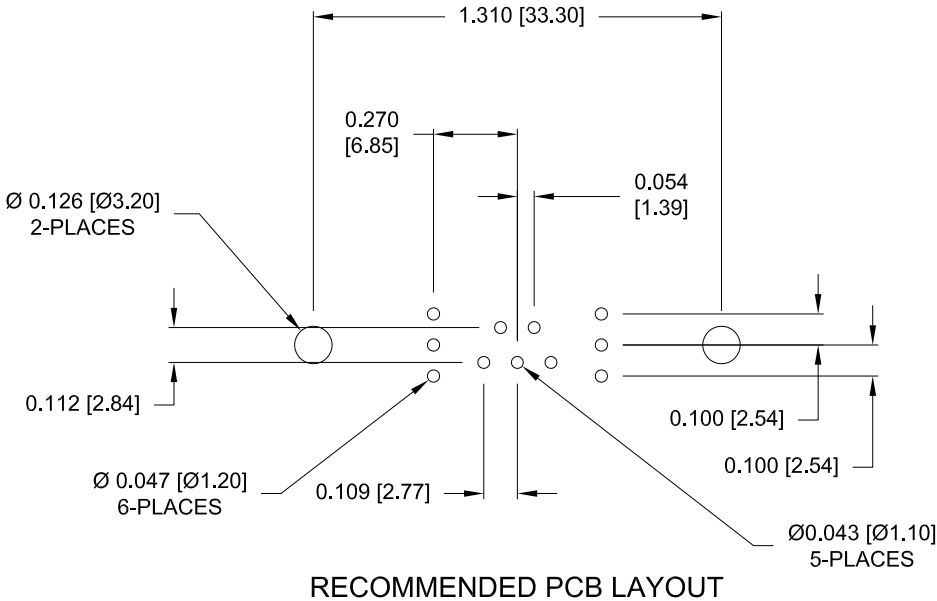

RoHS COMPLIANT

UNITS = INCHES [MM] DO NOT SCALE FROM DRAWING



THESE DRAWINGS AND SPECIFICATIONS ARE THE PROPERTY OF NorComp AND SHALL NOT BE REPRODUCED, COPIED OR USED AS THE BASIS FOR THE MANUFACTURE OR SALE OF APPARATUS WITHOUT WRITTEN PERMISSION.

DRAWN:
M. SIGMON

DATE: 03/13/2015

NorComp

SCALE:
NTS

SHEET 2 OF 3

REV
2

DWG NO: 683M7W2103LYYY

ALL CLINCH-NUTS ARE 4-40 INTERNAL THREADS

TOLERANCE:
ALL DIMENSIONS ARE ±0.010

0 NO HARDWARE

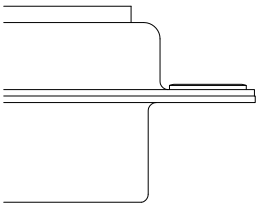

2 0.236" PCB SIDE

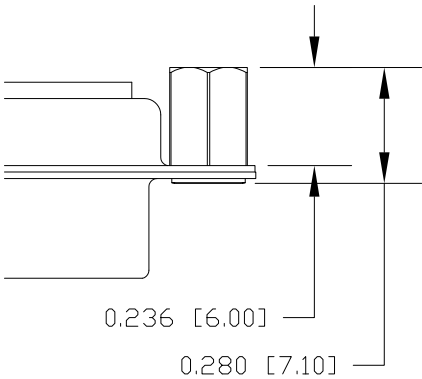

4 0.237" PCB SIDE

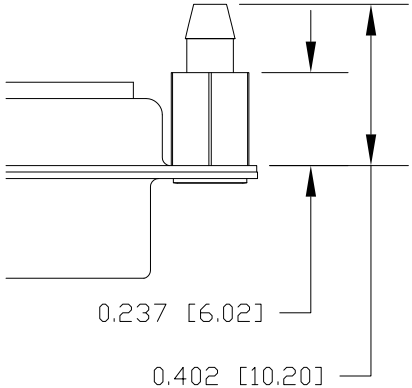

1 0.098" PCB SIDE

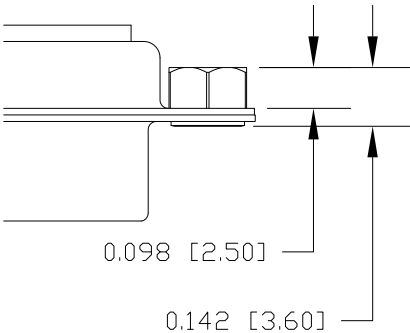

3 0.236" MATING SIDE

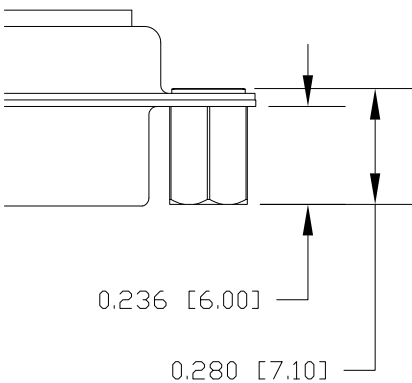

5 0.224" PCB SIDE

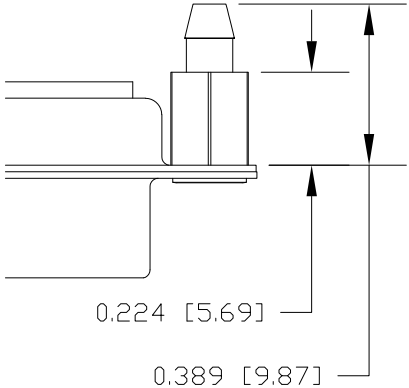

RoHS COMPLIANT

UNITS = INCHES [MM] DO NOT SCALE FROM DRAWING



THESE DRAWINGS AND SPECIFICATIONS ARE THE PROPERTY OF NorComp AND SHALL NOT BE REPRODUCED, COPIED OR USED AS THE BASIS FOR THE MANUFACTURE OR SALE OF APPARATUS WITHOUT WRITTEN PERMISSION.

DRAWN:
M. SIGMON

DATE:
03/13/2015

NorComp

SCALE:
NTS

SHEET
3 OF
3

REV
2

DWG NO: 683M7W2103LYYY

Mouser Electronics

Authorized Distributor

Click to View Pricing, Inventory, Delivery & Lifecycle Information:

NorComp:

[683M7W2103L051](#) [683M7W2103L011](#) [683M7W2103L041](#) [683M7W2103L001](#)