

## DESCRIPTION: POWER / SIGNAL - VERTICAL - MALE - MACHINED

## SPECIFICATIONS:

**ELECTRICAL:**

|                                  |                    |
|----------------------------------|--------------------|
| INSULATION RESISTANCE:           | 5 Gohms MIN.       |
| DIELECTRIC WITHSTANDING VOLTAGE: | 1000 VAC FOR 1 MIN |
| WORKING VOLTAGE:                 | 250V               |
| OPERATING TEMPERATURE:           | -55°C TO +125°C    |
| POWER CONTACT RESISTANCE:        | 2.0 mOhms MAX.     |
| SIGNAL CONTACT RESISTANCE:       | 10 mOhms MAX.      |
| POWER CONTACT AMPERAGE:          | SEE P/N KEY        |
| SIGNAL CONTACT AMPERAGE:         | 5 AMPS             |

**MECHANICAL:**

|                           |             |
|---------------------------|-------------|
| CONTACT INSERTION FORCE:  | 4.5 Kg MAX. |
| CONTACT SEPARATION FORCE: | 0.3 Kg MIN. |

**MATERIALS:**

|            |  |
|------------|--|
| CONTACTS:  | COPPER ALLOY, GOLD FLASH                 |
| INSULATOR: | PBT UL94V-0 RATED<br>230°C PROCESS TEMP. |
| SHELL:     | NICKEL PLATED STEEL                      |
| HARDWARE:  | NICKEL PLATED BRASS                      |

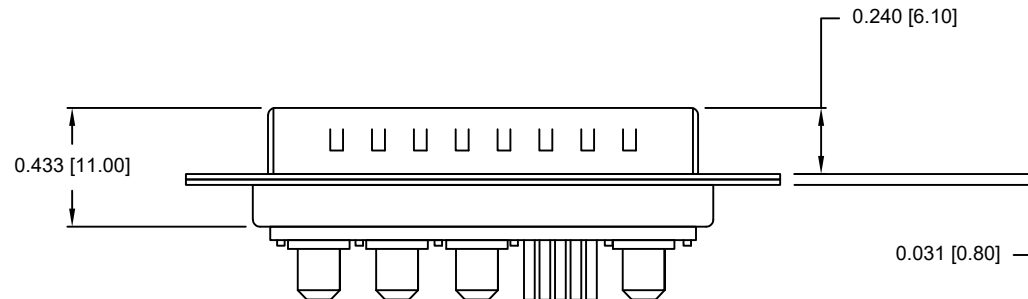
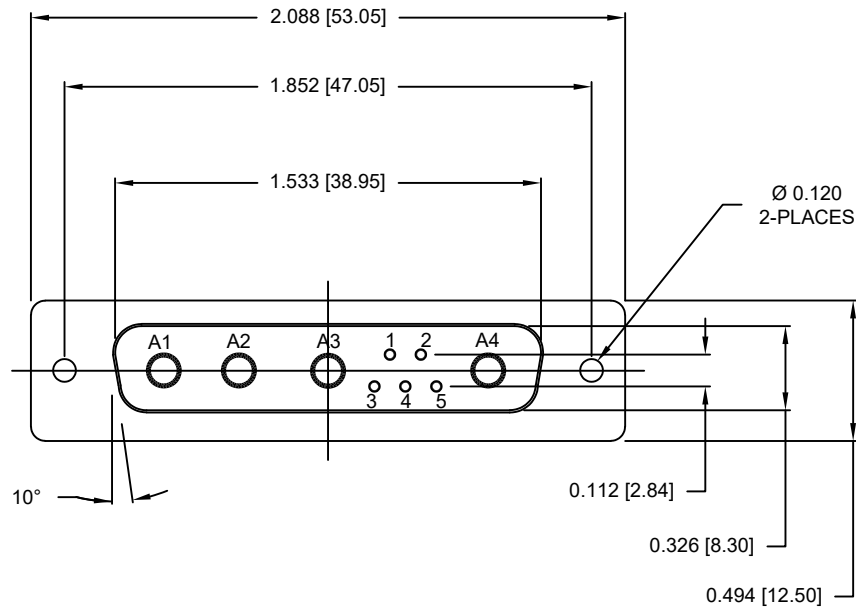
SEE SHEET 2  
FOR CONTACT DIMENSION DETAILS**681M9W4103LYYY**

0 = 40 AMP POWER // STANDARD PCB TAILS  
 1 = 40 AMP POWER // 2.22mm PCB TAILS  
 2 = 20 AMP POWER // STANDARD PCB TAILS

0 = NO HARDWARE  
 1 = 0.098" CN PCB SIDE  
 2 = 0.236" CN PCB SIDE  
 3 = 0.236" CN MATING SIDE  
 4 = 0.237" BOARDLOCK PCB SIDE  
 5 = 0.224" BOARDLOCK PCB SIDE

1 = GOLD FLASH

**RoHS COMPLIANT**

THESE DRAWINGS AND SPECIFICATIONS ARE THE PROPERTY OF NorComp AND SHALL NOT BE REPRODUCED, COPIED OR USED AS THE BASIS FOR THE MANUFACTURE OR SALE OF APPARATUS WITHOUT WRITTEN PERMISSION.

DRAWN:  
M. SIGMONDATE:  
07/19/2013

UNITS = inches [mm]

**DO NOT SCALE FROM DRAWING****NorComp**SCALE:  
NTSSHEET OF  
1 3REV  
5

DWG NO.

**681M9W4103LYYY**

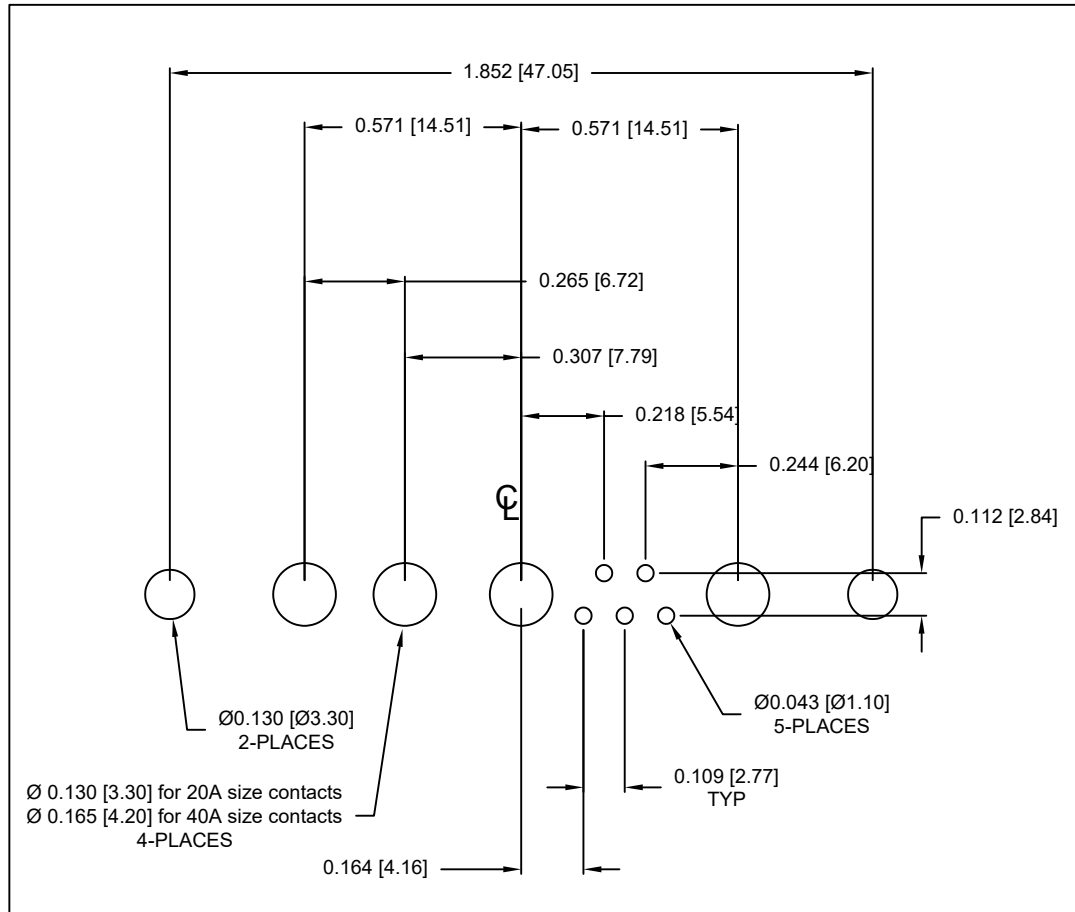

NOTE:  
SIGNAL AND POWER CONTACTS  
COME PRE-LOADED INTO INSULATORS

| DIMENSIONS(in/mm) |       |       |
|-------------------|-------|-------|
| OPTION            | S     | P     |
| 0 & 2             | 0.218 | 0.177 |
|                   | 5.55  | 4.50  |
| 1                 | 0.118 | 0.087 |
|                   | 3.02  | 2.22  |

SIGNAL CONTACTS

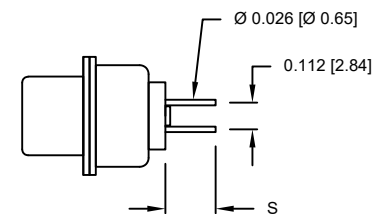

POWER CONTACTS

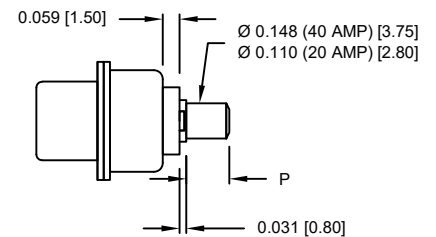

RoHS COMPLIANT



THESE DRAWINGS AND SPECIFICATIONS ARE THE PROPERTY OF NorComp AND SHALL NOT BE REPRODUCED, COPIED OR USED AS THE BASIS FOR THE MANUFACTURE OR SALE OF APPARATUS WITHOUT WRITTEN PERMISSION.

DRAWN:  
M. SIGMON

DATE:  
07/19/2013

UNITS = inches [mm]

DO NOT SCALE FROM DRAWING

NorComp

SCALE:  
NTS

SHEET 2 OF 3

REV  
5

DWG NO.

681M9W4103LYYY

ALL CLINCH-NUTS ARE 4-40 INTERNAL THREADS

TOLERANCE:  
ALL DIMENSIONS ARE  $\pm 0.010$ 

0 ..... NO HARDWARE

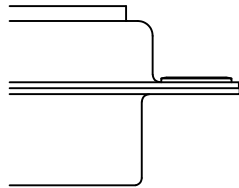

2 ..... 0.236" PCB SIDE

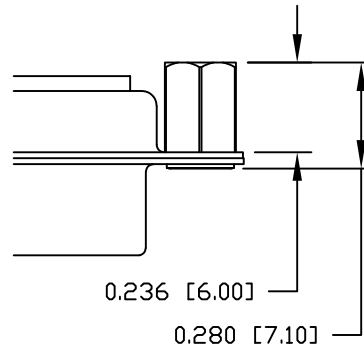

4 ..... 0.237" PCB SIDE

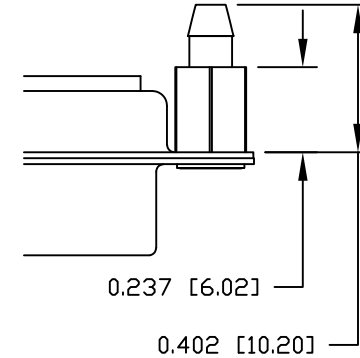

1 ..... 0.098" PCB SIDE

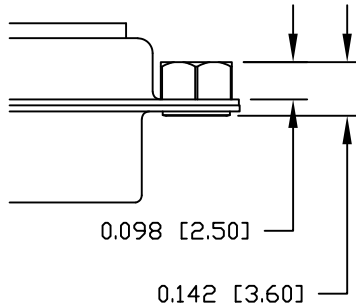

3 ..... 0.236" MATING SIDE

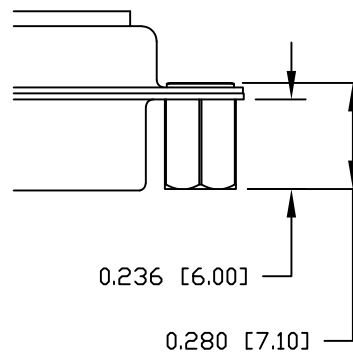

5 ..... 0.224" PCB SIDE

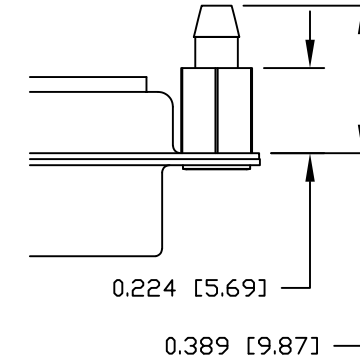

RoHS COMPLIANT



THESE DRAWINGS AND SPECIFICATIONS ARE THE PROPERTY OF NorComp AND SHALL NOT BE REPRODUCED, COPIED OR USED AS THE BASIS FOR THE MANUFACTURE OR SALE OF APPARATUS WITHOUT WRITTEN PERMISSION.

DRAWN:  
M. SIGMONDATE:  
07/19/2013

UNITS = inches [mm]

DO NOT SCALE FROM DRAWING

*NorComp*SCALE:  
NTS

SHEET 3 OF 3

REV  
5

DWG NO.

681M9W4103LYYY

# Mouser Electronics

Authorized Distributor

Click to View Pricing, Inventory, Delivery & Lifecycle Information:

[NorComp:](#)

[681M9W4103L001](#) [681M9W4103L041](#) [681M9W4103L011](#) [681M9W4103L051](#) [681M9W4103L101](#)  
[681M9W4103L111](#) [681M9W4103L141](#) [681M9W4103L151](#)