

## SPECIFICATIONS:

## ELECTRICAL:

INSULATOR RESISTANCE:	5 G OHMS Min.
DIELECTRIC WITHSTANDING:	1,000VAC r.m.s.
OPERATING TEMPERATURE:	-55° C ~ +125° C
POWER CONTACT RESISTANCE:	1.0 mOHMS Max.
SIGNAL CONTACT RESISTANCE:	2.7 mOHMS Max.
POWER PINS:	SEE PART NUMBER BELOW
SIGNAL PINS:	5 AMPS

## MECHANICAL:

CONTACT INSERTION FORCE:	4.5 Kg Max.
CONTACT SEPARATOR FORCE:	0.3Kg Min.

## MATERIALS:

CONTACTS:	COPPER ALLOY
INSULATOR:	PBT UL94V-0 RATED, BLK
	230°C PROCESS TEMP.

## SHELL:

## SEAL:

STEEL

F08 FLEXIBLE ADHESIVE

## FINISH:

## SHELL:

NICKEL

## CONTACTS:

FULL GOLD FLASH

680S5W1103LYY1

2 = 20 AMP

4 = 40 AMP

0 = NO HARDWARE

1 = 0.098" CN TERMINATION SIDE

1 = GOLD FLASH

\*CONTACT NORCOMP FOR MORE OPTIONS

MEETS IP67 STANDARDS

(SEE PAGE 2 FOR SEALING DETAILS)

RoHS COMPLIANT



THESE DRAWINGS AND SPECIFICATIONS ARE THE PROPERTY OF NorComp AND SHALL NOT BE REPRODUCED, COPIED OR USED AS THE BASIS FOR THE MANUFACTURE OR SALE OF APPARATUS WITHOUT WRITTEN PERMISSION.

DRAWN:

M. SIGMON

DATE:

06-10-13

UNITS = inch [mm]

DO NOT SCALE FROM DRAWING

NorComp

SCALE:

NTS

SHEET

OF

1 2

REV

2

DWG NO.

680S5W1103LYY1

## HARDWARE OPTIONS

### CLINCH NUTS HAVE #4-40 INTERNAL THREADS THRU

0 ..... NO HARDWARE

1 ..... 0.098" TERMINATION SIDE

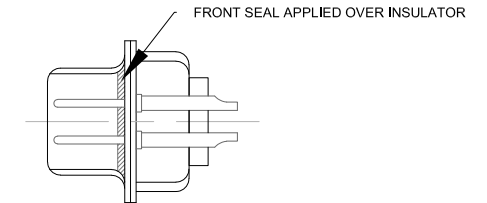
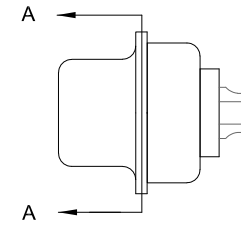
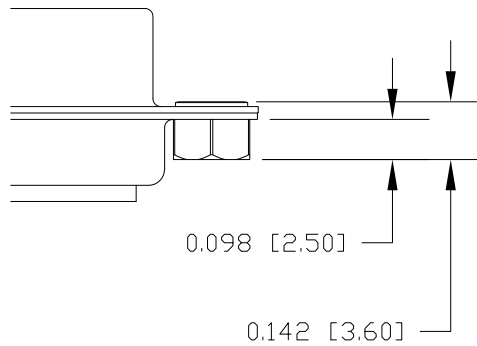
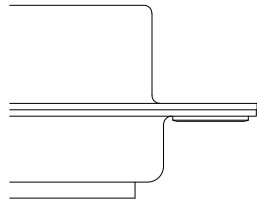

DETAIL A-A  
SHOWN FOR REFERENCE ONLY

NOTE:  
SIGNAL AND POWER CONTACTS  
COME PRE-LOADED INTO INSULATORS

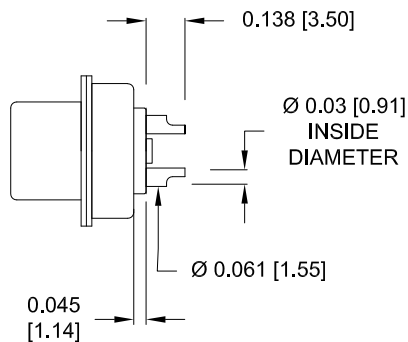

SIGNAL CONTACTS  
ACCEPTS UP TO 20 AWG WIRE

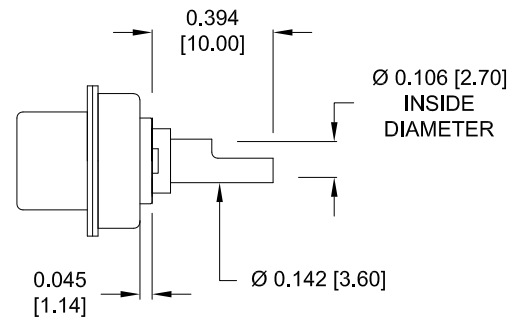

20 AMP POWER CONTACTS  
ACCEPTS UP TO 12 AWG WIRE

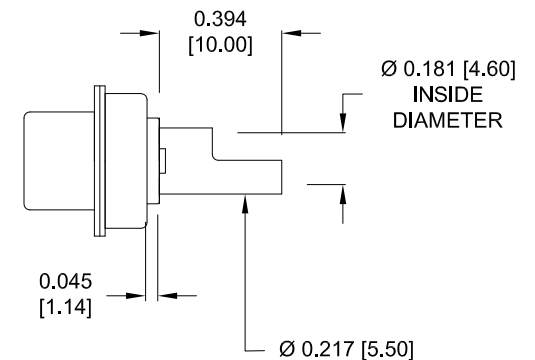

40 AMP POWER CONTACTS  
ACCEPTS UP TO 8 AWG WIRE

RoHS COMPLIANT

UNITS = inch [mm]

DO NOT SCALE FROM DRAWING



THESE DRAWINGS AND SPECIFICATIONS ARE  
THE PROPERTY OF NorComp AND SHALL NOT  
BE REPRODUCED, COPIED OR USED AS THE  
BASIS FOR THE MANUFACTURE OR SALE OF  
APPARATUS WITHOUT WRITTEN PERMISSION.

DRAWN:  
M. SIGMON

DATE:  
06-10-13

# NorComp

SCALE:  
NTS

SHEET 2 OF 2

REV  
2

DWG NO.

680S5W1103LYY1

# Mouser Electronics

Authorized Distributor

Click to View Pricing, Inventory, Delivery & Lifecycle Information:

NorComp:

[680S5W1103L201](#) [680S5W1103L401](#)