

SPECIFICATIONS:

MATERIALS:

HOUSING:	PBT, UL94 V-0, BLACK
SHELL:	NICKEL PLATED STEEL
HARDWARE:	NICKEL PLATED BRASS

ELECTRICAL:

RATED VOLTAGE:	250V
INSULATION RESISTANCE:	5 GOhms MIN.
DIELECTRIC WITHSTANDING:	1,000 VAC r.m.s.

ENVIRONMENT:

OPERATING TEMPERATURE:	-55°C TO +125°C
------------------------	-----------------

680M3W3273L0Y0

- 0 = NO HARDWARE
- 1 = 2.5mm #4-40 CLINCH NUT PCB SIDE

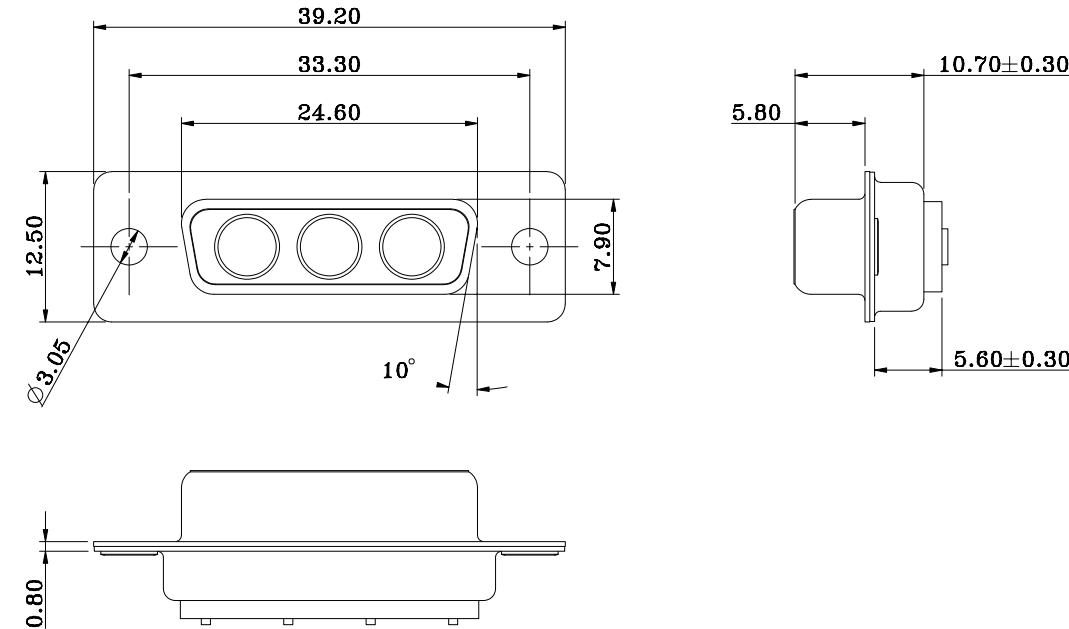

SIGNAL AND POWER CONTACTS SOLD SEPARATELY
(3x) POWER CONTACT P/N = 680M002-072LY0Y (Y = Place holder for variants)

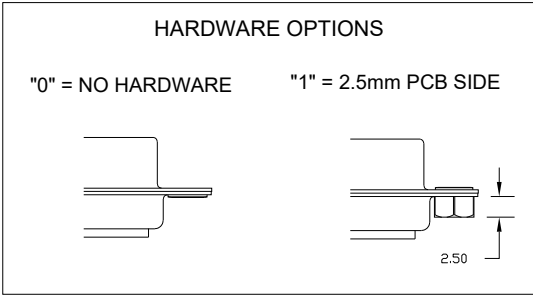

RoHS COMPLIANT



THESE DRAWINGS AND SPECIFICATIONS ARE THE PROPERTY OF NorComp AND SHALL NOT BE REPRODUCED, COPIED OR USED AS THE BASIS FOR THE MANUFACTURE OR SALE OF APPARATUS WITHOUT WRITTEN PERMISSION.

DRAWN:	J. KADEL
DATE:	11/16/2022

UNITS = mm

DO NOT SCALE FROM DRAWING

NorComp	SCALE:	SHEET	OF	REV
	NTS	1	1	0
DWG NO. 680M3W3273L0Y0				

Mouser Electronics

Authorized Distributor

Click to View Pricing, Inventory, Delivery & Lifecycle Information:

[NorComp:](#)

[680M3W3273L010](#) [680M3W3273L000](#)