

NOTES: UNLESS OTHERWISE SPECIFIED

- CORNERS DRAWN SHARP TO BE R.005 MAXIMUM.
- EXTERIOR SURFACE TEXTURE TO BE LIGHT EDM FINISH. EQUIVALENT TO MT-11010. TEXTURE ON ENCLOSURE WILL VARY FROM TIME TO TIME AS THE TOOL WEARS AND IT BECOMES NECESSARY TO REAPPLY.
- INTERIOR SURFACE TEXTURE TO BE: NONE.
- ALL INSIDE RADII .010R. UNLESS OTHERWISE SPECIFIED.
- ALL EXTERNAL DIMENSIONS AFFECTED BY THE DRAFT APPLY AT THE LARGE END OF THE FEATURE, AND ALL INTERNAL FEATURES AFFECTED BY THE DRAFT APPLY AT THE SMALL END OF THE FEATURE UNLESS OTHERWISE SPECIFIED.
- 1 DEGREE DRAFT IN THE DIRECTION OF PULL IS PERMISSIBLE UNLESS OTHERWISE SPECIFIED.
- MATERIAL / COLOR: ABS PLASTIC IS STANDARD IN BLACK OR WHITE. CUSTOM MATERIALS AND COLORS ARE AVAILABLE UPON REQUEST FOR QUOTE. ALTERNATE RESINS HAVE DIFFERENT SHRINK RATES, AND WILL EFFECT DIMENSIONS.
- PCB SIZES ARE RECOMMENDATIONS ONLY. FINAL SIZES AND VERIFICATION OF ITS FIT ARE THE SOLE RESPONSIBILITY OF EACH CUSTOMER.
- ASSEMBLY SCREWS FOR THE ENCLOSURE INCLUDED.
- THIS DRAWING IS BASED ON A SOLID MODEL, AND IS FURTHER DEFINED BY THE SOLID MODEL FILE.
- ALLOWABLE FLASH: 0.010 MAX.
- ALL EJECTOR PIN MARKS TO BE WITHIN 0.010" OF FLUSH, PROTRUDING OR BELOW FLUSH.
- TRIM GATE WITHIN 0.030" OF FLUSH.

R E V I S I O N					
REV.	DRAWN BY	ECO No	DESCRIPTION	DATE	APPROVE
A	M BOYER	DRXXX	PRELIMINARY RELEASE	2017-May-03	D.C.
B	R CRUZ		REVISE ENCLOSURE NAME	2017-Jul-25	D.C.
1.0	R CRUZ		UPDATE SHEETS AND RELEASE TO REV 1 PER CUSTOMER	2017-Aug-11	

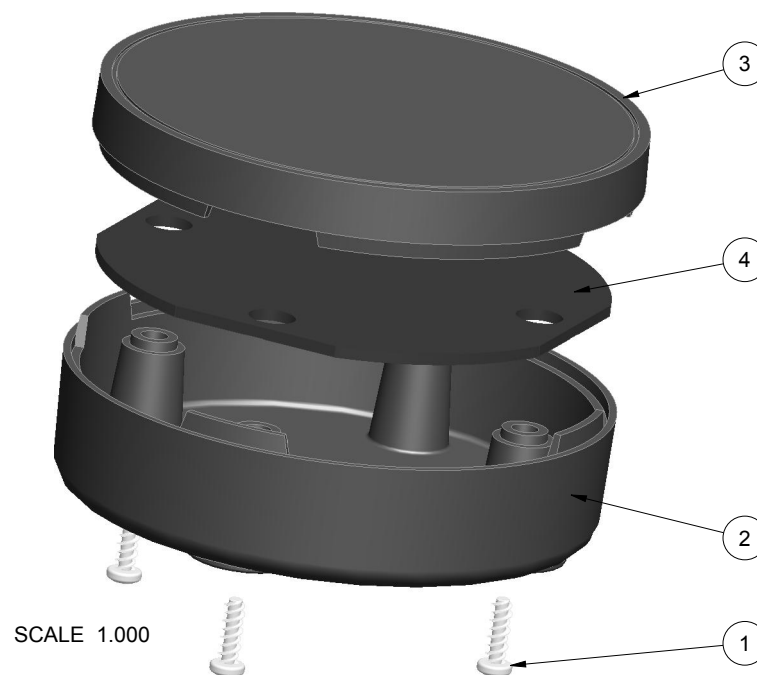

4	292910-PCB	292910 PCB - REFERENCE	.062" THICK	CUSTOMER SUPPLIED	1
3	292910-COVER	292910 COVER - STANDARD	ABS	BLACK or WHITE	1
2	292910-BASE	292910 BASE - STANDARD	ABS	BLACK or WHITE	1
1	SCREW_HILO-N04X375	#4 HiLo x .375" SCREW	ZINK PLATED	3/8" LONG	4
ITEM	FILE NAME	DESCRIPTION	MATERIAL	COLOR	QTY.

BILL OF MATERIALS

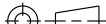
THIRD ANGLE PROJECTION		TOLERANCES: UNLESS OTHERWISE SPECIFIED DIMENSIONS ARE IN U.S. INCHES. X.XX = .015 X.XXXX = .001 X.XXX = .010 X.X" = 1"		<div>NEW AGE ENCLOSURES</div> <div>2240 South Thornburg Street ph. (805) 595-1310</div> <div>Santa Maria, CA. 93455 fax (805) 595-1024</div> <div>www.newageenclosures.com</div>		
<div></div> <div>DO NOT SCALE DRAWING</div>		NEW AGE ENCLOSURES				
<div>NOTICE: THE INFORMATION AND DATA CONTAINED HEREIN IS CONSIDERED PROPRIETARY TO ALTEC INTEGRATED MFG INC & SHALL REMAIN THE EXCLUSIVE PROPERTY OF ALTEC INTEGRATED MFG INC. THE HOLDER WILL ASSUME CUSTODY AND CONTROL THAT THIS DOCUMENT WILL NOT BE COPIED, REPRODUCED, OR DISCLOSED WITHOUT THE EXPRESS WRITTEN CONSENT OF ALTEC INTEGRATED MFG INC. POSSESSION OF THIS DOCUMENT DOES NOT CONSTITUTE A GRANT TO MANUFACTURE ANY ITEMS © 2017</div>		Customer's Part No: 292910		<div>STANDARD - 2.9" ROUND</div> <div>SXX-292910-XXX</div>		
		APPROVAL	BY			DATE
		CHECK				
		ENG.				
		SCALE	AS NOTED			
		DRAWN BY	M BOYER			
		2017-May-03		SIZE A		
				DRAWING NAME 292910_R1_0		
				SHEET 1 OF 6		
				REV.DOC 1.0		

292910 ASSEMBLY

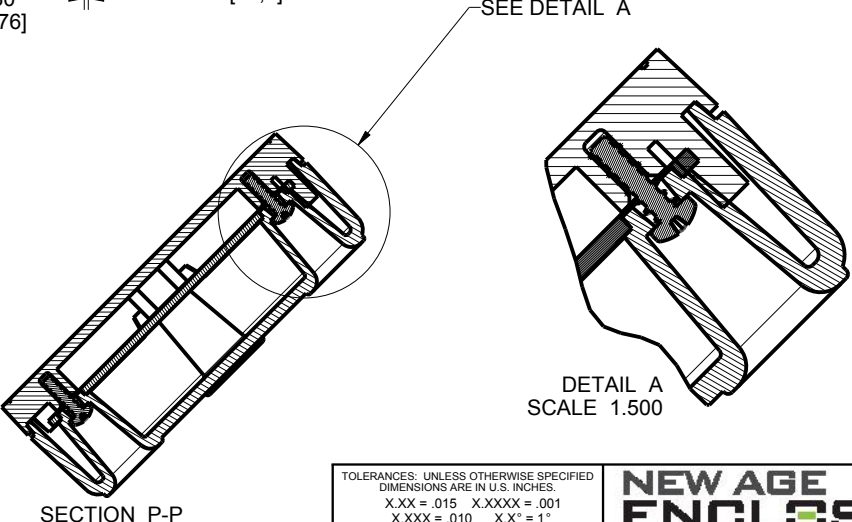
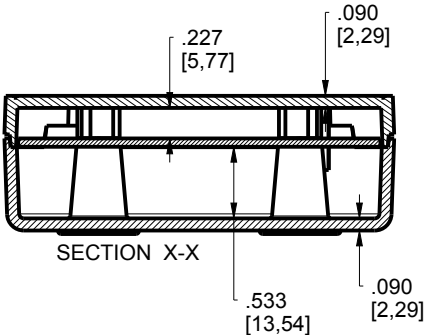
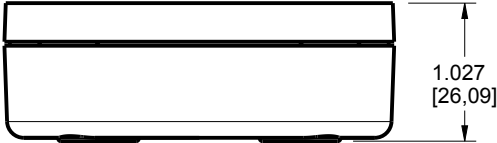
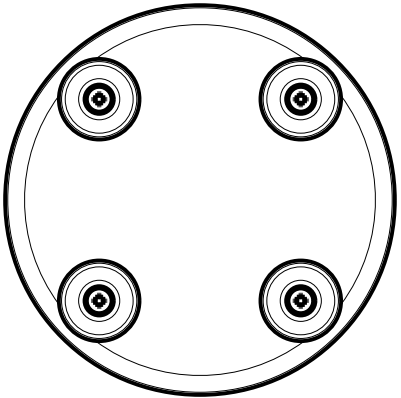
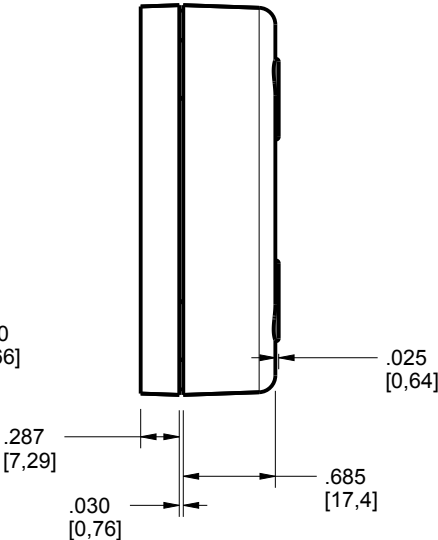
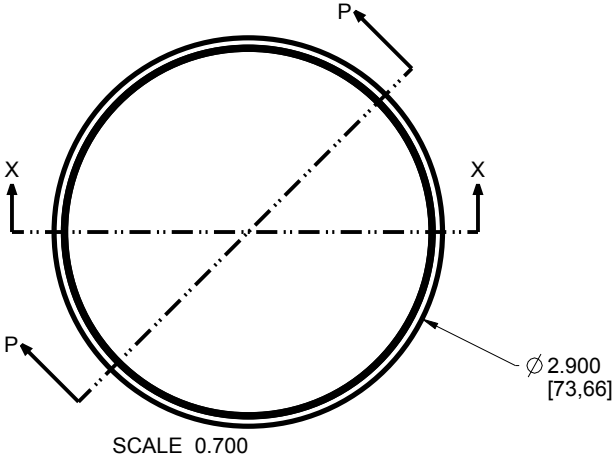

TOLERANCES: UNLESS OTHERWISE SPECIFIED DIMENSIONS ARE IN U.S. INCHES. X.XX = .015 X.XXXX = .001 X.XXX = .010 X.X° = 1°				NEW AGE ENCLOSURES	
NEW AGE ENCLOSURES				2240 South Thornburg Street Santa Maria, CA. 93455 ph. (805) 595-1310 fax (805) 595-1024 www.newageenclosures.com	
Customer's Part No: 292910				STANDARD - 2.9" ROUND SXX-292910-XXX	
APPROVAL	BY	DATE		SIZE	REV.DOC
CHECK				A	292910_R1_0
ENG.					
SCALE	AS NOTED			SHEET	2 OF 6
DRAWN BY	2017-May-03				1.0
M BOYER					

292910 COVER

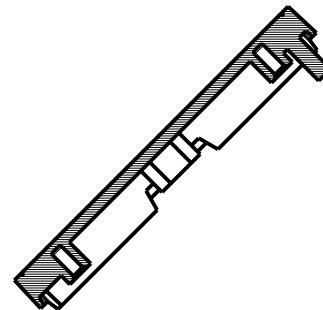
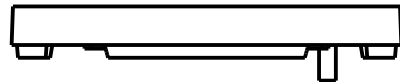
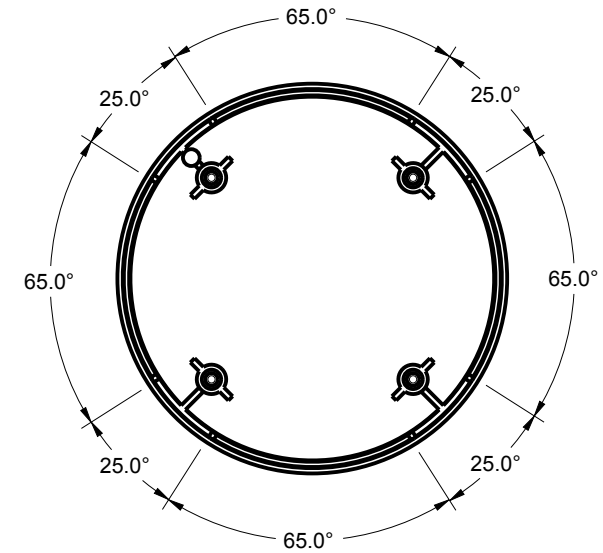
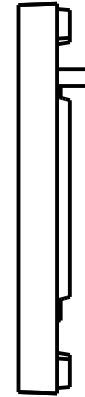
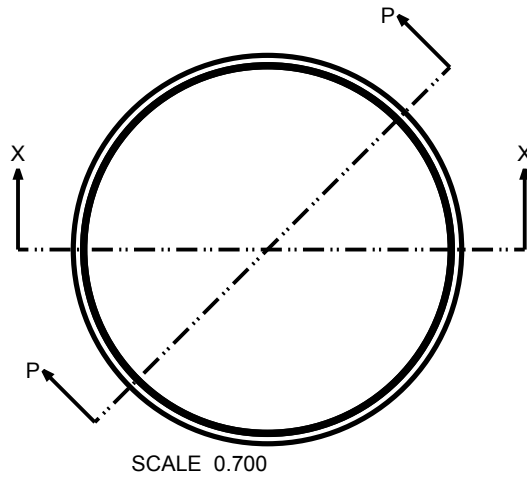

SECTION P-P

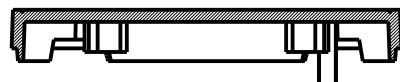

SECTION X-X

TOLERANCES- UNLESS OTHERWISE SPECIFIED DIMENSIONS ARE IN U.S. INCHES. X.XX = .015 X.XXXX = .001 X.XXX = .010 X.X° = 1°				NEW AGE ENCLOSURES 2240 South Thornburg Street Santa Maria, CA. 93455 ph. (805) 595-1310 fax (805) 595-1024 www.newageenclosures.com			
Customer's Part No: 292910							
APPROVAL	BY	DATE	STANDARD - 2.9" ROUND SXX-292910-XXX				
CHECK							
ENG.							
SCALE	AS NOTED						
DRAWN BY M BOYER			2017-May-03	SIZE A	DRAWING NAME 292910_R1_0	SHEET 3 OF 6	REV.DOC 1.0

292910 BASE

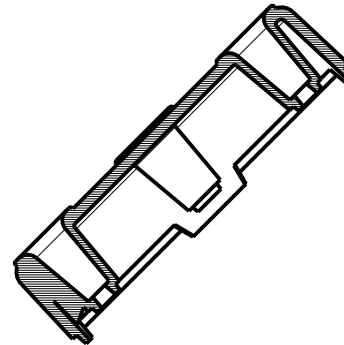
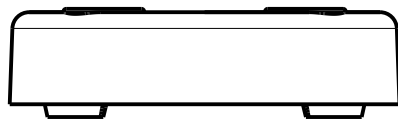
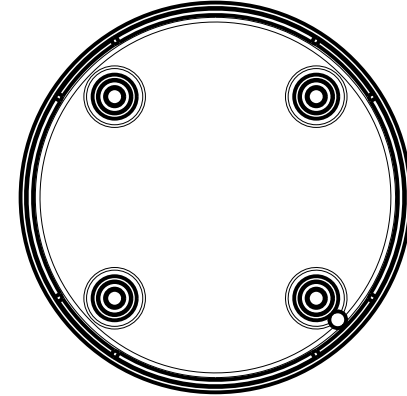
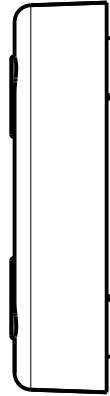
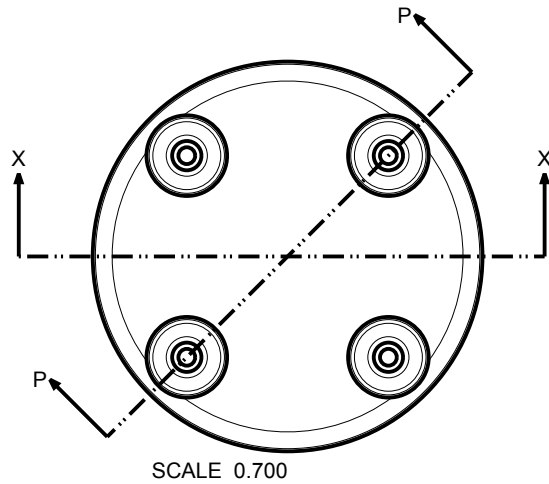

SECTION P-P



SECTION X-X

TOLERANCES- UNLESS OTHERWISE SPECIFIED DIMENSIONS ARE IN U.S. INCHES. X.XX = .015 X.XXXX = .001 X.XXX = .010 X.X° = 1°				NEW AGE ENCLOSURES 2240 South Thornburg Street Santa Maria, CA. 93455 ph. (805) 595-1310 fax (805) 595-1024 www.newageenclosures.com			
Customer's Part No: 292910							
APPROVAL	BY	DATE	STANDARD - 2.9" ROUND SXX-292910-XXX				
CHECK							
ENG.							
SCALE	AS NOTED						
DRAWN BY M BOYER			2017-May-03	SIZE A	DRAWING NAME 292910_R1_0	SHEET 4 OF 6	REV.DOC 1.0

PCB SIZES ARE RECOMMENDATIONS ONLY. FINAL SIZES AND VERIFICATION OF ITS FIT ARE THE SOLE RESPONSIBILITY OF THE OEM.

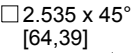

TOLERANCES, UNLESS OTHERWISE SPECIFIED DIMENSIONS ARE IN U.S. INCHES. X.XX = .015 X.XXXX = .001 X.XXX = .010 X.X" = 1"			NEW AGE ENCLOSURES 2240 South Thornburg Street Santa Maria, CA. 93455 ph. (805) 595-1310 fax (805) 595-1024 www.newageenclosures.com			
NEW AGE ENCLOSURES						
Customer's Part No: 292910						
APPROVAL	BY	DATE	STANDARD - 2.9" ROUND SXX-292910-XXX			
CHECK						
ENG.						
SCALE	AS NOTED					
DRAWN BY M BOYER 2017-May-03			SIZE A	DRAWING NAME 292910_R1_0	SHEET 5 OF 6	REV.DOC 1.0

292910 2nd OPERATION DETAILS

NEW AGE ENCLOSURES DELIVERS YOUR ENCLOSURE MARKET-READY WITH IN-HOUSE
CNC MACHINING, PAD PRINTING, ASSEMBLY, AND FULFILLMENT.
ALL SURFACES AND AREAS ARE AVAILABLE FOR CNC ALTERATION BY NEW AGE ENCLOSURES
CALL (805) 595-1310 FOR PRICING AND SCHEDULE.
THE INSIDE RADIUS OF ANY MACHINED FEATURES SHOULD BE NO SMALLER THAN .031"

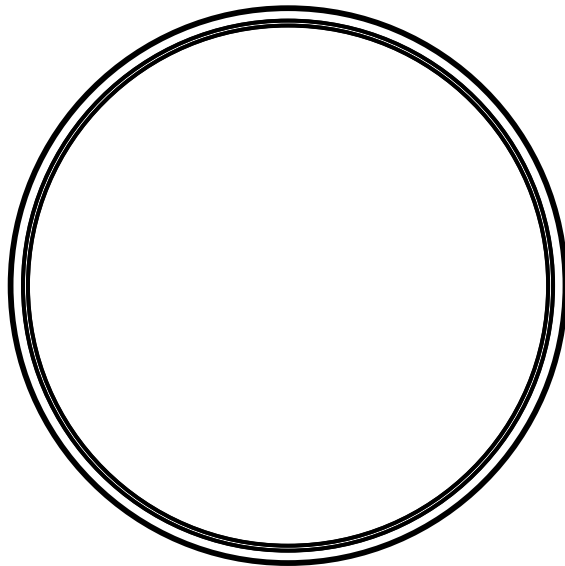

292910 COVER
SCALE 1.000

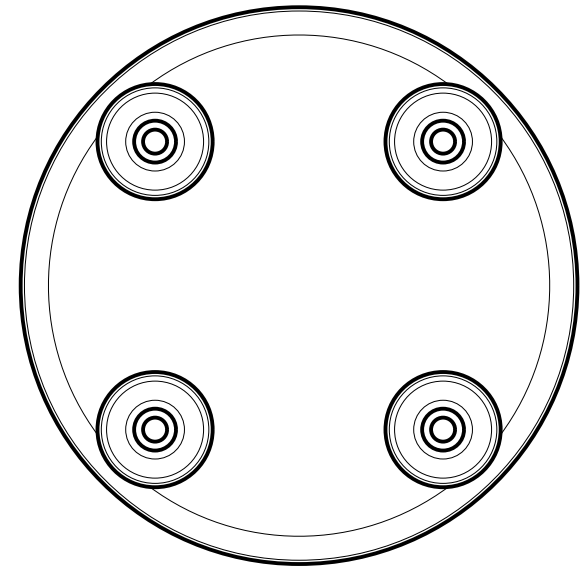
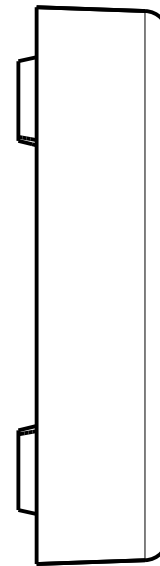

292910 BASE
SCALE 1.000

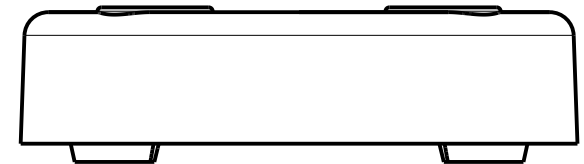
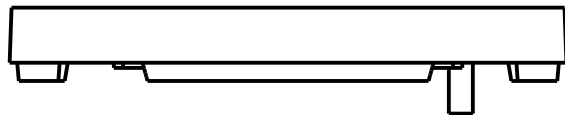

TOLERANCES- UNLESS OTHERWISE SPECIFIED
DIMENSIONS ARE IN U.S. INCHES.
X.XX = .015 X.XXXX = .001
X.XXX = .010 X.X° = 1°

NEW AGE ENCLOSURES

Customer's Part No: 292910

APPROVAL	BY	DATE
CHECK		
ENG.		
SCALE	AS NOTED	
DRAWN BY	M BOYER	
	2017-May-03	

NEW AGE ENCLOSURES
2240 South Thornburg Street Santa Maria, CA. 93455
ph. (805) 595-1310 fax (805) 595-1024
www.newageenclosures.com

STANDARD - 2.9" ROUND
SXX-292910-XXX

SIZE	DRAWING NAME	SHEET	REV.DOC
A	292910_R1_0	6 OF 6	1.0

SXX-292910-XXX COVER - ABS, BLACK

STEP	DESCRIPTION	CUTTER	FIXTURE	ORIENTATION	PROGRAM
1-C-C1	-	T2 = .062" EM	-	-	01001
2-C-C2	-	T2 = .062" EM	-	-	01002

Mouser Electronics

Authorized Distributor

Click to View Pricing, Inventory, Delivery & Lifecycle Information:

[New Age Enclosures:](#)

[S1A-292910](#)